

ORDINANCE NO. 10

**TOWNSHIP OF CLEARFIELD
CAMBRIA COUNTY, PENNSYLVANIA**

**AN ORDINANCE LAYING OUT AND OPENING AN EXTENSION OF TOWNSHIP
ROUTE 528**

WHEREAS, a public hearing was held in Clearfield Township after ten days written notice to all affected property owners proposing the laying out and opening of the within described extension of Township Route 528.

AND WHEREAS, all of the owners of the real estate included in said extension of Township Route 528 have agreed to the laying out and opening of said extension and have released the Township of Clearfield from any and all claims for damages by reason thereof and have conveyed the necessary right of way to the Township of Clearfield.

NOW THEREFORE, the Township of Clearfield, Cambria County, Pennsylvania, pursuant to the power and authority granted to it by the Second Class Township Code Section 1102 does hereby lay out, open and accept the following as an extension of Township Route 528, which begins at a point on the Easterly right of way line of Pennsylvania Route 36 which point is Southeast 200 feet from Road Station 5/85; thence extending a width of 16-1/2 feet on both sides of center line North 53° 53' East 448 feet to its intersection with the present Township Route 528. All of which is shown on a survey of Martin C. Kirsch, Registered Engineer, attached hereto and made part hereof.

Enacted into an ordinance of the Township of Clearfield this
6th day of January, 1975.

Township of Clearfield

ATTEST:

Elizabeth Sheehan
Secretary

By James M. McNulty
Chairman
Joseph Manna

Certified to be a true and exact copy of Ordinance No. 10,
Clearfield Township, Cambria County, Pennsylvania,
enacted finally on January 6, 1975.

Elizabeth Sheehan
Township Secretary

FILED
CLERK OF COURTS
CAMBRIA CO. PA.

JAN 14 1 28 PM '75

STEPHEN D. SLACOVICH
CLERK OF COURTS

RI# 4

TOWNSHIP OF CLEARFIELD
Cambria County, Pennsylvania

ORDINANCE NO. 10

LAW OFFICES
ENGLEHART & ENGELHART
107 E. LLOYD STREET
EBENSBURG, PA. 15931

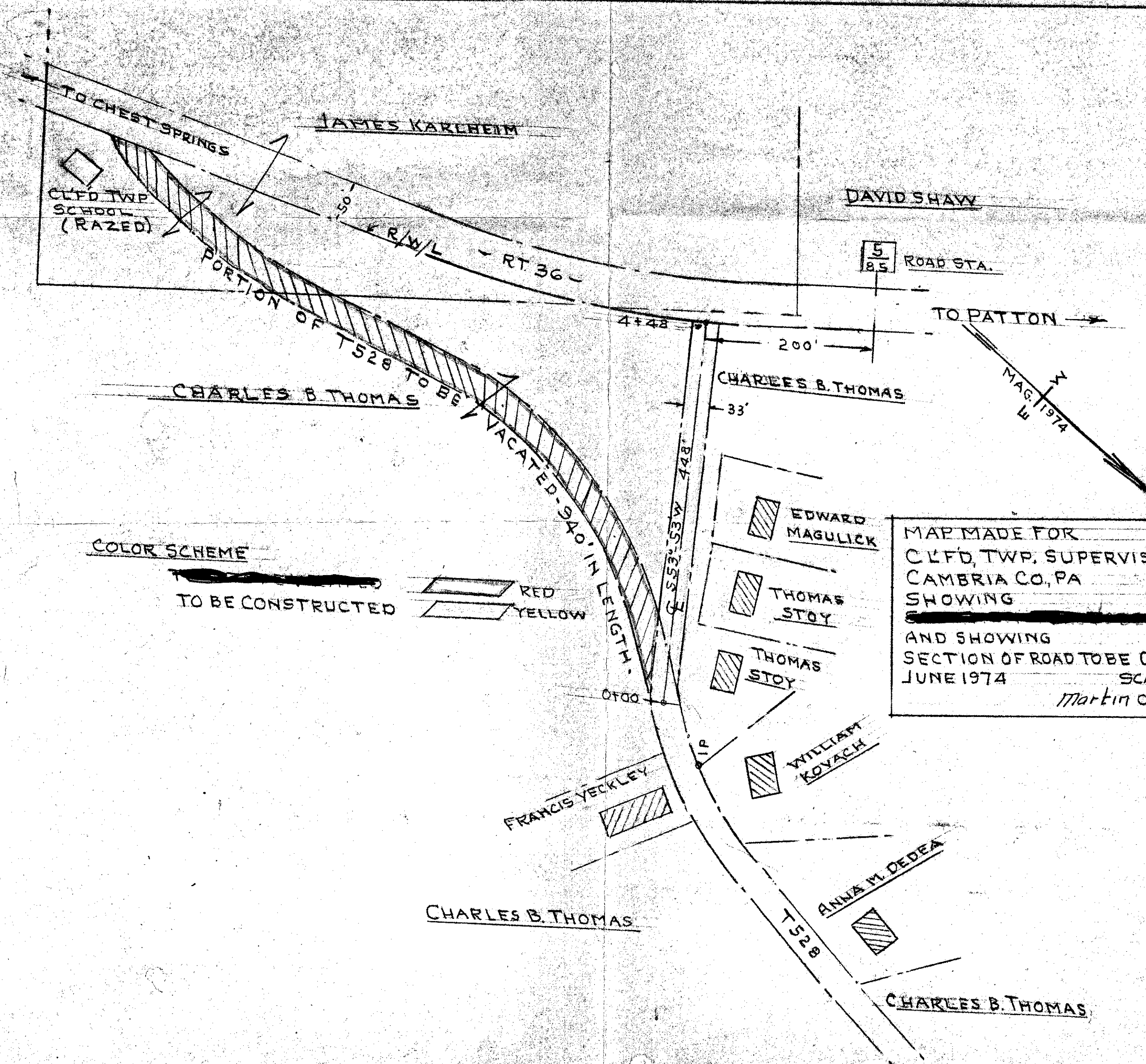

CLFD TWP
SCHOOL
(RAZED)

JAMES KARCHHEIM

DAVID SHAW

5/85 ROAD STA.

TO PATTON

MAG 1974

CHARLES B. THOMAS

CHARLES B. THOMAS

COLOR SCHEME

TO BE CONSTRUCTED

RED
YELLOW

EDWARD
MAGULICK

THOMAS
STOY

THOMAS
STOY

WILLIAM
KOVACH

FRANCIS YECKLEY

ANNA M. DEEDA

CHARLES B. THOMAS

CHARLES B. THOMAS

MAP MADE FOR
CLFD, TWP. SUPERVISORS
CAMBRIA CO., PA
SHOWING
AND SHOWING
SECTION OF ROAD TO BE CONSTRUCTED
JUNE 1974
SCALE 1"=100'
Martin C. Kirsch, Engr