

Road Docket

No. *1* *Sept.* Sessions 1958

In the Court of Quarter
Sessions of Cambria County,
Pennsylvania.

IN RE:

VACATION OF PARTS OF
STATE HIGHWAY ROUTE 11054,
CHEST TOWNSHIP, CAMBRIA
COUNTY, PENNSYLVANIA

Bill P. Harner

PETITION AND ORDER

Filed - June 18, 1958

A.C.W.

ENGLEHART, LARIMER & ENGLEHART
ATTORNEYS AT LAW

215-219 MASONIC BUILDING
EBENSBURG, PENNSYLVANIA

IN THE COURT OF QUARTER SESSIONS OF CAMBRIA COUNTY, PENNSYLVANIA
IN RE: VACATION OF PARTS :
OF STATE HIGHWAY ROUTE :
11054, CHEST TOWNSHIP : No. Sessions 1958
CAMBRIA COUNTY, PENNA. :

TO THE HONORABLE JUDGES OF THE ABOVE NAMED COURT.

The petition of the Road Supervisors of Chest Township, Cambria County, Pennsylvania, respectfully represents:

1. That the Department of Highways of the Commonwealth of Pennsylvania have abandoned certain portions of State Highway Route 11054 in Chest Township, Cambria County,
2. That your petitioners deem it advisable to vacate said abandoned portions of said State Highway.
3. That the Department of Highways of the Commonwealth of Pennsylvania has not vacated these portions of said State Highway.
4. That your petitioners have agreed with the property owners affected by such vacation to vacate said parts of said State Highway without the formality of a view, as shown by agreements attached hereto and made a part hereof, being Exhibits A and B.
5. That one abandoned portion of said State Highway Route 11054 consists of 882 feet between station 192 + 00 and station 200 + 00, which is shown on Pennsylvania Department of Highway drawing of Route 11054, section 4, which is attached hereto and made a part hereof, and marked Exhibit C.
6. The other abandoned portion of said State Highway consists of 2548 feet between Station 86 + 00 and station 109 + 00 all of which is shown on said Department of Highway drawing attached hereto and made part hereof, and marked Exhibit C.

WHEREFORE, your petitioners pray your Honorable Court to approve the vacation of the above described portions of State Highway Route 11054, pursuant to the authority granted to it by the Act of Assembly of 1933, May 1, P.L. 103, Article XI, Section 1115, as amended, 53 Purdons Statutes, Section 66115.

Herman J. Leiden

C. K. Baker

Bernard Nibauer

State of Pennsylvania :
County of Cambria : SS.

Herman J. Leiden being duly sworn according to law, deposes and says that he is one of the Road Supervisors of Chest Township, and that the facts set forth in the foregoing petition for vacation are true and correct to the best of his knowledge, information and belief.

Herman J. Leiden

Sworn to and subscribed before me this 13th day of June, 1958.

Legina Hudson, J.P.
Notary Public

My commission expires: 1st Monday 1960

O R D E R

And now, this 18 day of June 1958, the within petition of the Chest Township Road Supervisors having been presented by Paul D. Larimer, Solicitor for Chest Township, it appearing that the Supervisors of said township deem it advisable to vacate certain abandoned portions of State Highway Route 11054 in Chest Township, and it further appearing that the property owners affected by such vacation have agreed to the vacation without the formality of a view, approval is hereby granted to the said Road Supervisors of Chest Township to vacate the following abandoned portions of State Highway Route 11054 in Chest Township:

(a) 882 feet of said State Highway between Stations 192 + 00 and 200 + 00, as shown on Pennsylvania Highway Department drawing, Exhibit C to this petition, and

(b) 2548 feet of State Highway Route 11054 between Stations 86 + 00 and 109 + 00, as shown on Pennsylvania Highway drawing Exhibit C to this petition.

BY THE COURT

Griffith

J.

St. Lawrence, Pa.
March 12 1954

Chest Township Road Supervisors
St. Lawrence, Pa.

Gentlemen:

We the undersigned property owners being the persons that relocation of route 11054 effects, this relocation starting at station 192 plus 00 and ending at station 175 plus 00.

We agree with your board that the old road locations will serve no need to be maintained as a Township Highway, therefore it is agreeable to us that these old portions of road be vacated and abandoned and these old road locations be returned to the former owners.

Witness

[Signature]

Henry Swope Est.

Hilda Swope Exr
Helena Swope Estate

St. Lawrence, Pa.
Chest Township
Cambria Co.
Dec. 8 1955

Chest Township Road Supervisors

St. Lawrence, Pa.

Gentlemen:

We the undersigned property owners being the persons that relocation of Route 11054 effects, this relocation starting at station 86 + 00 and ending at station 109 + 00 .

We agree with your board that the old road location will serve no need to be maintained as a Township Highway, therefore it is agreeable to us that these old portions of road be vacated and abandoned and these old road locations be returned to the former owners.

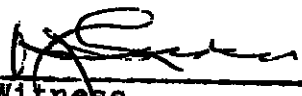

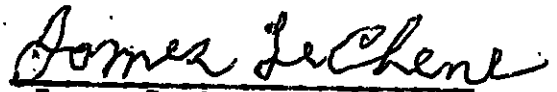
Witness

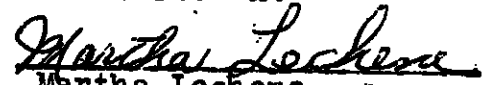
James Lechene

Martha Lechene

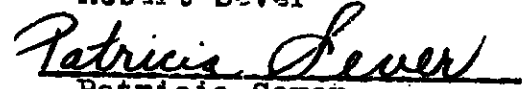
Robert Sever

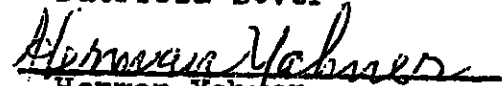
Patricia Sever

Herman Yahner



M.E. Swope

Gertrude Swope

Drawing Showing
Abandoned & Relocated Portions
of
Route 11054—Section 4
Chest Township—Cambria County
District 9 — Scale: 1"=500'

Begin Relocation & Abandonment
Sta. 86+00 Construction
Sta. 86+20 Straight Line Record

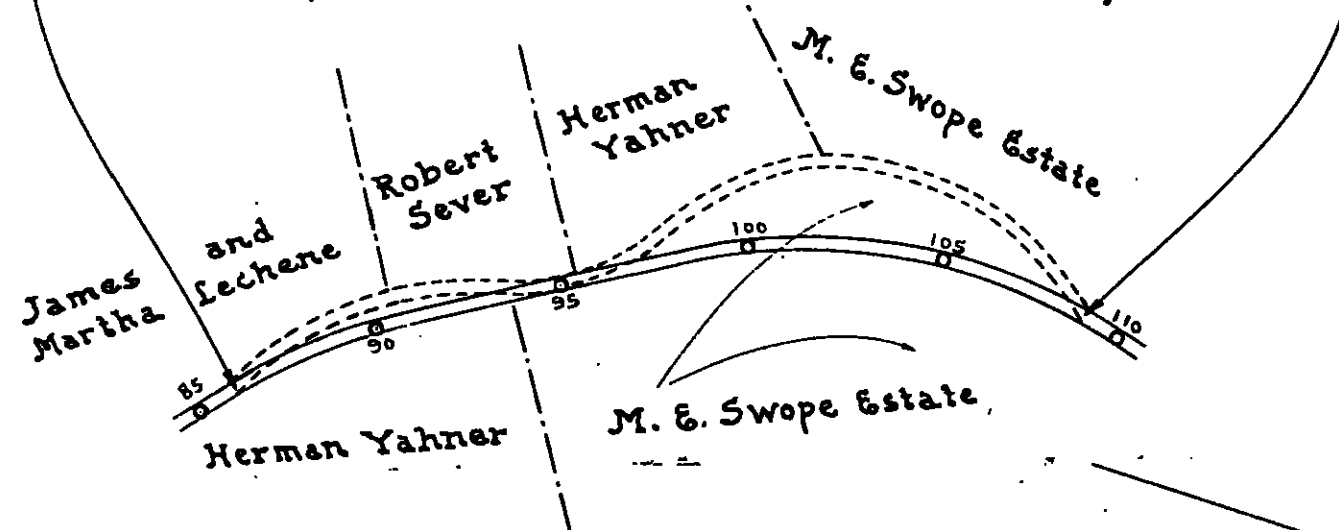
End Relocation & Abandonment
Sta. 109+00 Construction
Sta. 111+68 Straight Line Record



Begin Relocation & Abandonment
Sta. 134+00 Construction
Sta. 136+90 Straight Line Record

End Relocation & Abandonment
Sta. 142+00 Construction
Sta. 145+16 Straight Line Record

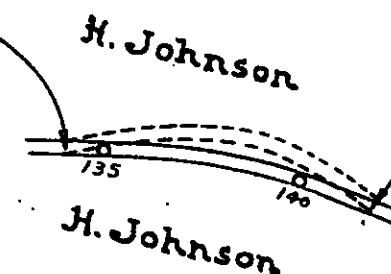

Begin Relocation & Abandonment
Sta. 155+00 Construction
Sta. 158+28 Straight Line Record

End Relocation & Abandonment
Sta. 175+00 Construction
Sta. 179+50 Straight Line Record

Equation—
Sta. 158+46.59 Bk.=
Sta. 158+56.59 Ahd.

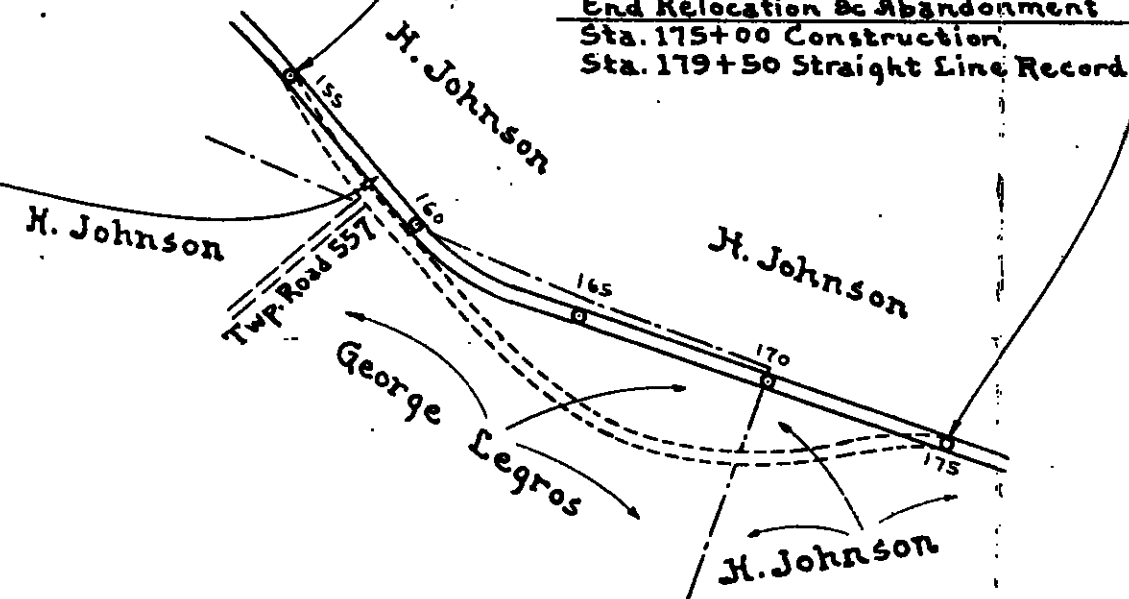

Begin Relocation & Abandonment
Sta. 192+00 Construction
Sta. 196+50 Straight Line Record

End Relocation & Abandonment
Sta. 200+00 Construction
Sta. 205+32 Straight Line Record

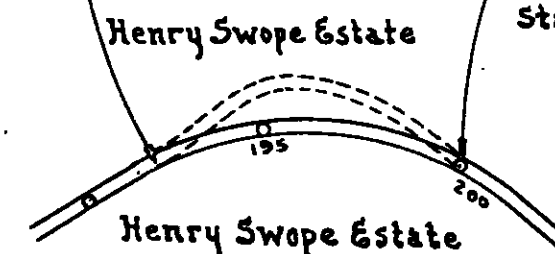

Tabulation of Changes by Relocation

Stations	Improved Road			
	Relocated		Abandoned	
	Feet	Mile	Feet	Mile
86+00-109+00 Const.	2,300	0.4356		
86+20-111+68 S.L.R.			2,548	0.4826
134+00-142+00 Const.	800	0.1515		
136+90-145+16 S.L.R.			826	0.1564
155+00-175+00 Const.	1,990	0.3769		
158+28-179+50 S.L.R.			2,122	0.4019
192+00-200+00 Const.	800	0.1515		
196+50-205+32 S.L.R.			882	0.1670

LEGEND

Abandoned Portions of Route 11054.
Relocated Portions of Route 11054.
Plan approved by the Governor on December 28, 1953.

RESOLUTION OF THE ROAD SUPERVISORS OF CHEST TOWNSHIP, CAMBRIA COUNTY, PENNSYLVANIA

WHEREAS, the Department of Highways of the Commonwealth of Pennsylvania has abandoned certain portions of Pennsylvania Route 11054 in Chest Township, Cambria County, Pennsylvania, and

WHEREAS, the Road Supervisors of said township deem it advisable to vacate such abandoned portions of the State Highway, and

WHEREAS, the Road Supervisors of said township have agreed with the property owners affected by such vacation and now wish to formally vacate the abandoned portions of Route 11054 without the formality of a view.

NOW THEREFORE BE IT RESOLVED, that the Road Supervisors of Chest Township, Cambria County, Pennsylvania accept the written agreements of Hilda Swope and Helena Swope, Executors of the Henry Swope Estate, for the vacation of 882 feet of State Highway Route 11054 between station 192 + 00 and station 200 + 00, as shown on Pennsylvania State Highway drawing of Section 4 of said State Highway in District 9.

It is further resolved that the Road Supervisors of said township accept the agreements of James and Martha Lechene, Robert and Patricia Sever, Herman Yahner and M. E. and Gertrude Swope for the vacation of 2548 feet of State Highway Route 11054 between station 86 + 00 and station 109 + 00, as shown on Pennsylvania State Highway drawing of Section 4 of said State Highway in District 9.

It is further resolved that the necessary petition required by the Act of 1933 P.L. 103, as amended, setting forth the facts regarding such vacation, accompanied by a map of the same, be presented to the Court of Quarter Sessions of Cambria County for approval so that formal action for such vacation may be taken after the Court grants its approval.

Adopted by the Chest Township Road Supervisors
At a special meeting June 12 1958. and so recorded in the
Twp. minute book.

James Lechene Sec'y.

No. Road Docket 1 Sept.
Sessions, 1958
Court of Quarter Sessions
of Cambria County, Pa.

RESOLUTION OF THE ROAD
SUPERVISORS OF CHEST TOWN-
SHIP, CAMBRIA COUNTY, PA.

Filed: June 23, 1958

VACATION OF PARTS OF STATE
HIGHWAY ROUTE 11054, CHEST
TOWNSHIP

ENGLEHART, LARIMER & ENGLEHART
ATTORNEYS AT LAW
215-219 MASONIC BUILDING
EBENSBURG, PENNSYLVANIA

CHEST TOWNSHIP ROAD SUPERVISORS

ST. LAWRENCE, PA.

June 23 1958

Clerk Of Courts
Ebensburg, Pa.

Dear Sir:

This is to certify that the attached
resolution concerning vacation of certain roads
in Chest Township Cambria has been properly passed
and recorded in the Township minute book.

Yours truly

Herman J. Leiden Sec'y.
Chest Township Road Dist.



RESOLUTION OF THE ROAD SUPERVISORS OF CHEST TOWNSHIP, CAMBRIA
COUNTY, PENNSYLVANIA.

WHEREAS, the Department of Highways of the Commonwealth of Pennsylvania has abandoned certain portions of Pennsylvania Route 11054 in Chest Township, Cambria County, Pennsylvania; and

WHEREAS, the Road Supervisors of said township deem it advisable to vacate said abandoned portions of said State Highway; and

WHEREAS, the Road Supervisors of said township, on the 12th day of June, 1958, passed a resolution to petition the Court of Quarter Sessions of Cambria County for approval of the vacation of said portions of said State Highway; and

WHEREAS, on June 18, 1958, the Court of Quarter Sessions of Cambria County, Pennsylvania, at No. Road Docket 1 September Sessions, 1958, entered an Order approving the vacation of said portions of said State Highway.

NOW THEREFORE, BE IT RESOLVED

- (a) that 882 feet of State Highway Route 11054 between Station 192 + 00 and Station 200 + 00 as shown on Pennsylvania State Highway Drawing of Section 4 of said State Highway in District No. 9, and
- (b) that 2548 feet of State Highway Route 11054 between Station 86 + 00 and Station 109 + 00 as shown on Pennsylvania State Highway Drawing of Section 4 of said State Highway in District No. 9

be and the same are hereby vacated.

Adopted this 23rd day of June, 1958.

A. J. Baker
Bernard H. Lantz
For Supervisor
Road Supervisors of Chest Township