

yellow
m. sp.

R E P O R T O F V I E W E R S .

To the Honorable, the Judges of the Court of Quarter Sessions of
Cambria County, Pennsylvania.

WJ
We, the undersigned members of the permanent board of viewers of Cambria County, appointed by your honorable Court, upon the attached order and therein directed to view and determine as to the propriety of vacating a certain piece of public road in Blacklick Township, said county and state, from a point on the Bethel - Cardiff - Twin Rocks road near the store of one Frank Szunyough and ending at the northerly line of the St. Charles Catholic Cemetery property, approximately 2026.5 feet from the juncture of the road; a portion of which is sought to be vacated; with the Nanty-Glo - Twin Rocks - Belbano road, in the Village of Twin Rocks; respectfully report:

That having given due notice of the view and of the time and place of meeting of the viewers to the Commissioners of Cambria County and to the Supervisors of the Township of Blacklick by serving notices, a copy of which is hereto attached, and to the traveling public by printed hand bills posted in public and conspicuous places at and near the termini and along the route of the piece of road proposed to be vacated: And, having been each duly sworn according to law to perform the duties of our appointment faithfully, impartially and to the best of our judgment and ability; all of us met at the time and place appointed, in accord with the notices given and posted as aforesaid, and having gone over and carefully viewed the premises we are all of the opinion that the piece of road in question has fallen into disuse and should be vacated so as to no longer burden the taxpayers of said township of Blacklick.

Said piece of road; the points of beginning and ending/^{of which}are more particularly described on the attached order of the Court; takes the following courses and distances, viz: Beginning at the termini near the store of said Frank Szunyough and running thence south 80 degrees 40 minutes west 1475.4 feet, north 89 degrees 30 minutes west 185 feet,

2014

north 69 degrees 15 minutes west 397.1 feet, north 44 degrees 10 minutes west 265.7 feet, north 89 degrees 30 minutes west 426.3 feet, south 84 degrees west 338 feet, south 65 degrees 45 minutes west 365 feet, north 84 degrees west 302 feet, north 65 degrees west 142 feet, north 44 degrees 30 minutes west 187 feet, north 24 degrees 35 minutes west 315 feet, north 34 degrees 40 minutes west 471 feet, north 47 degrees 15 minutes west 357 feet, north 86 degrees 40 minutes west 360.5 feet, south 66 degrees west 257 feet, and south 57 degrees 30 minutes west 352 feet to the northerly side of the St. Charles Catholic Cemetery property, the place of ending designated on the attached order.

To repair the piece of road sought to be vacated, which from all indications on the ground has not been used by the public since the advent of the automobile, and; so far as the viewers can see or ascertain; there is no occasion nor necessity for its being repaired or any expense being put on the road at this time: accordingly we recommend that the said piece of road should be vacated, as a public road, but left open as a private road from the Mary Davis farm to the point of ending at the south westerly terminus.

A plot or draft showing the location with the courses and distances of said piece of road is hereto attached and made a part of this report.

Witness our hands this 29th., day of April, A. D., 1935.

A. M. Shoemaker

James M. Bacon

J. M. [illegible]

Viewers.

N O T I C E O F V I E W .

Notice is hereby given that the Viewers appointed by the Court of Quarter Sessions of Cambria Co., Pa., to view and determine as to the propriety of vacating a certain piece of public road in Blacklick Township, said county and state, between Cardiff and Twin Rocks:

Beginning on the Bethel - Cardif - Twin Rocks road, at a point near the store of Frank Szunyough, in the Village of Cardiff and ending at the northerly line of the St. Charles Catholic Cemetery property; on said Bethel - Cardiff - Twin Rocks road, at a point approximately 2026.5 feet from the juncture of said road; in the Village of Twin Rocks; with the Nanty-Glo - Belsano road.

Said viewers will meet at the point of beginning, above indicated, in the Village of Cardiff, Blacklick Township, Cambria Co., Pa., at the store of Frank Szunyough on Friday, April 26th., at 10:00 O'clock a. m., for the purpose of performing the duties of their said appointment.

A. M. Shoemaker,

James McCann and

P. M. Kirmey,

Viewers.

re Vacation of portions of Cardiff - Twin ks road.

Commissioners of Cambria Co. Dr
To A. M. Shoemaker

Preparing, posting & serving notices of view & notifying viewers $\frac{1}{4}$ day	\$15.00
22 miles @ 10¢ per mi.	2.20
Stenographer & Stationery	1.20
Making view 1 day	12.00
Survey, plot, draft & prints $\frac{1}{4}$ day	19.20
22 mi on view	2.20
Preparing having signed & filing report $\frac{1}{4}$ day	15.00
Stenographer & Stationery	1.15
	<u>\$67.95</u>

To P. M. Kimmery

One day on View	12.80
6 miles @ 10¢	60
	<u>\$12.60</u>

To James McCann

One day out View	\$12.80
38 miles @ 10¢	3.80
	<u>\$15.80</u>

APPROVED FOR PATENT

John Thomas
Commissioners

Commonwealth of Pennsylvania, }
County of Cambria. } SS.

At a Court of Quarter Sessions of the Peace of the County of Cambria held at Ebensburg, in the said County, on the 15th day of April A. D. 1955, before the Honorable Judge of the said Court: Upon the petition of divers inhabitants of the Township of Blacklick, in the said County, setting forth that ~~the petitioners have~~ ~~vacated for a~~ Public road or highway, ~~beginning at a point near the store of Frank Szunyough, more definitely ascertained by running the following five courses and distances from the intersection of the Seldersville- Nanty-Glo road with said Bethel-Twin Rocks, viz: South 61° 45' West, 416 feet; South 26° 30' West. 346 feet; South 79° 00' West. 1412 feet; North 1° 45' West, 276 feet and South 79° 30' West, 320 feet and ending at a point on said last mentioned road about 6000 feet westward from the point of beginning and 2026.5 feet from its juncture, in the Village of Twin Rocks, with the Nanty Glo- Belsano Road, said point of ending being at the Northwesterly line of the St. Charles Catholic Cemetery, which said piece of road has fallen into disuse and become useless, inconvenient and burdensome to the citizens and taxpayers of Blacklick Township~~

and therefore praying the Court to appoint proper persons to vacate view and ~~lay out~~ the same according to law. The Court, upon due consideration had of the premises, do order and appoint

A. M. Shoemaker surveyor, and

James McCann and P. M. Kinney vacation viewers, to view the ground proposed for said ~~road~~ vacation and if they view the same, and shall agree that there is occasion for such ~~road~~ vacation, they shall proceed to ~~lay out~~ vacate the same, ~~keeping record of the same in the books of the surveyor, and also be as far as practicable, agreeable to the desires of the petitioners, and that they make a report of their proceedings to the next Court of Quarter Sessions to be held for said County, stating particularly whether they judge the same necessary for a public or private road, together with a plot or draft thereof, and the courses and distances, and references to the improvements through which it may pass.~~

By the Court.

Attest:

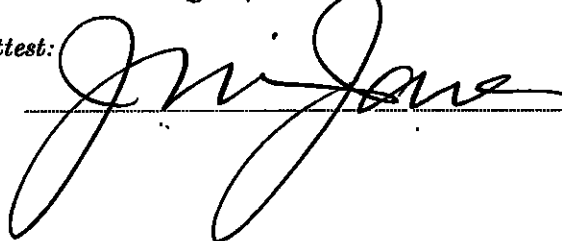
 Clerk.

11/11/11

N.L. It shall be the duty of all persons appointed in the several counties of this Commonwealth and review any public or private road or bridge, if they shall decide in favor of locating said road or bridge, to endeavor to procure from the person or persons over whose land such location may be made releases from all claims for damages that might arise from the opening of such road or the building of such bridge; and in every case where said viewers shall fail to procure such releases, and it shall appear to them that any damages will be sustained, it shall be their duty to assess the damages and make report thereof signed by a majority of their number, and return the same, together with all releases obtained, to the Court of Quarter Sessions, and the damages so assessed shall be conclusive, or may be subject to appeal, review or modification, as may be provided by existing laws in the different counties of this Commonwealth."

"The persons appointed as aforesaid shall view such ground, and if they shall agree that there is occasion for a road, they shall proceed to lay out the same, having respect to the shortest distance, and the best ground for a road, and in such manner as shall do the least injury to private property, and also be, as far as practicable, agreeable to the desire of the petitioners."

"The viewers, as aforesaid, shall make report at the next term of said Court, and in the said report shall state particularly: First, who of them were present at the view, second, whether they were severally sworn or affirmed; third, whether the road desired be necessary for a public or private road; they shall also annex and return to the Court a plot or draft thereof, stating the courses and distances, and noting briefly the improvements through which it may pass; and, whenever practicable, the viewers shall lay out the said roads at an elevation not exceeding five degrees (except at the crossing of ravines and streams), where, by moderate filling and bridging, the declination of the road may be preserved within that limit."

NO. 4 March SESSIONS, 19235

Order to view and vacate piece of public road in Blacklick Township, leading from Bethel to Twin Rocks via Cardiff.

and
Report of Viewers.

Dated: April 30, 1935

A. M. Shoemaker

James McCann

P. M. Kinney

Viewers

Clerk 90 cts.

10 June 1935 Approved

By the Court

9 Sept. 1935 Confirmed as to correctness

John Jones
Clerk

IN RE PETITION TO VACATE PIECE OF
PUBLIC ROAD IN BLACKLICK TOWNSHIP,
LEADING FROM BETHEL TO TWIN ROCKS
VIA CARDIFF, IN THE COUNTY OF
CAMBRIA, STATE OF PENNSYLVANIA

§ IN THE COURT OF QUARTER SESSIONS,
: CAMBRIA COUNTY, PENNSYLVANIA
:
: NO. 4 MARCH
: JUNE SESSIONS, 1935
§ VACATING PORTIONS OF THE PUBLIC ROAD

PETITION FOR THE APPOINTMENT OF VIEWERS

TO THE HONORABLE, THE JUDGES OF THE ABOVE NAMED COURT:

The petition of the undersigned citizens and taxpayers of
the Township of Blacklick, County of Cambria, Pennsylvania, respectfully
represents:

That a public road has long since been laid out and opened
leading from Bethel to Twin Rocks by the way of Cardiff, Cambria County,
Pennsylvania.

That a portion of the said road beginning at a point near
the store of Frank Szunyough, more definitely ascertained by running the follow-
ing five courses and distances from the intersection of ^{the} Seldersville - Nanty
Glo road with said Bethel - Twin Rocks, viz: South $61^{\circ} 45'$ West, 416 feet;
South $26^{\circ} 30'$ West, 346 feet; South $79^{\circ} 00'$ West, 1412 feet; North $1^{\circ} 45'$
West, 276 feet and South $79^{\circ} 30'$ West, 320 feet and ending at a point on
said last mentioned road about 6000 feet westward from the point of beginning
and 2026.5 feet from its juncture, in the Village of Twin Rocks, with the
Nanty Glo-Belsano road, said point of ending being at the Northwesterly line
of the St. Charles Catholic Cemetery, which said piece of road has fallen into
disuse and become useless, inconvenient and burdensome to the citizens, and
taxpayers of Blacklick Township, Cambria County, Pennsylvania.

That a careful search of the records for the proceedings
laying out the said road has been made but the identity of the road cannot
be ascertained.

WHEREFORE, the undersigned petitioners, citizens and taxpayers of the Township of Blacklick, Cambria County, Pennsylvania, respectfully request your Honorable Court to appoint three members of the Permanent Board of Viewers of Cambria County to view and inquire into the matters set forth in the foregoing petition and report to your Honorable Court their findings and whether or not the same should be vacated, in accordance with the Act of the General Assembly, and the supplements thereto, in such cases made and provided, and they will ever pray, etc.

PETITIONERS:

T O Crawford
J T Crawford
H A Crawford
W A Crawford
D J H. Miller
Geo. Miller
L. E. Hill
Geo. L. Lander
Merton Edwards

A. T. Anderson
Victor C. Fryler
William E. Stewart
Thomas Bracher
Dorst Taul
Levi Hill
Don. McDougal
J. E. Halmus

STATE OF PENNSYLVANIA :
: SS:
COUNTY OF CAMBRIA :

Personally appeared before me Felix Losurdo, one of
the Supervisors of Blacklick Township, Cambria County, Pennsylvania, who
being duly sworn according to law deposes and says that the facts set
forth in the foregoing petition are true and correct to the best of his
knowledge and belief.

G. E. Halmer J.P.

My Commission Expires first Mon Jan 1940

ORDER

Now, April 15th 1935, the within petition having been
read and considered, A. M. Shoemaker,

James McLean and P. W. Timney,
three members of the Permanent Board of Viewers of Cambria County, are here-

by appointed to view the above referred to piece of road and report their
findings to this Court in accordance with the Act of General Assembly and
supplements thereto.

By the Court
McLean

IN THE COURT OF QUARTER SESSIONS
CALBRIA COUNTY, PENNSYLVANIA

NO. 4 MARCH SESSIONS, 1935

IN RE PETITION TO VACATE PIECE OF
PUBLIC ROAD IN BLACKLICK TOWNSHIP,
LEADING FROM SETEEL TO TWIN ROCKS
VIA CARDIFF, IN THE COUNTY OF
CALBRIA, STATE OF PENNSYLVANIA.

PETITION FOR THE APPOINTMENT OF
VIEWERS

Filed - april - 13 - 1935
11:45 a.m.
Jm Jones

LAW OFFICES OF
SAMUEL R. DI FRANCESCO



JOHNSTOWN, PENNA.

Flat Microfilm

R.D. #4 Mar, 1935

Black-Turf,

6/25/35

St. Charles

Catholic

Secretary.

Point of ending of proposed road.

Unimproved land.

Old unimproved farm.

Occupied by John Coprich formerly Henry Davis.



Unimproved land

Woodland.

Plot or draft showing a portion of the Bethel-Carroll-Twin Rocks road, in Blacklick Township, Cambria County, Pennsylvania, proposed to be vacated.

Issued upon an order of the Board of Quarter Sessions of Cambria County, Pa., dated the 15th day of April, A. D., 1935.

A. M. Chasmatas, James McEann & J. M. Kinney, Viewers.

Unimproved.

Old farm land.

Point of beginning of road.

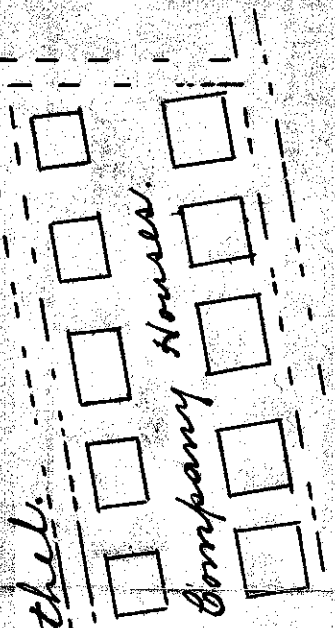

To Bethel.

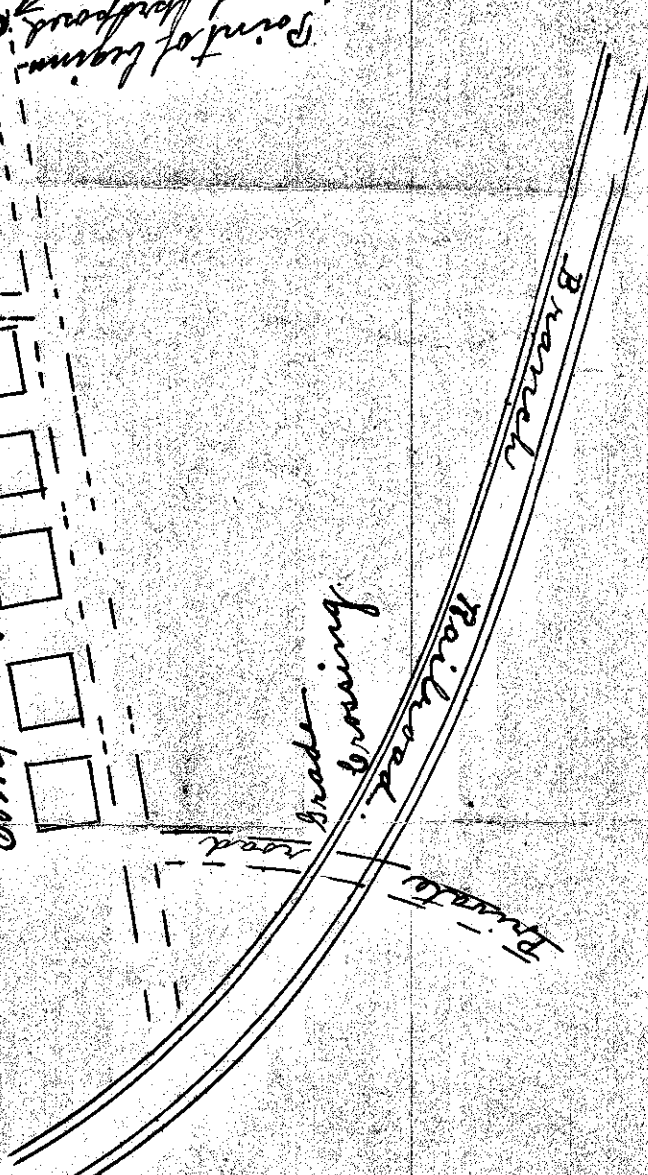

George J. Webb
6047 Mon 1832

not measured