

Viewed upon an order of the Court of
Quarter Sessions of Cambria County,
Pennsylvania dated November 14th 1932.
Entered to No. 5 September Sessions 1932.
A. M. Shoemaker, James M. Carr, J. L. E. Taylor,
Viewers.

IN THE COURT OF QUARTER SESSIONS OF CAMBRIA COUNTY,
PENNSYLVANIA.

In the Matter of Vacating of Public Road in White Township,
Cambria County, Pennsylvania.

TO THE HONORABLE, THE JUDGES OF SAID COURT:

The petition of the undersigned inhabitants, citizens and
Supervisors of White Township, Cambria County, Pennsylvania,
respectfully represents:

That a public road was long since laid out and opened through
White Township leading from the St. Augustine-Fallen Timber Road
to the Flinton-Patton Road and known as the "Glendale Road".
That no record of opening of said road has been found; that said
Glendale Road has for twenty-one years and upwards been used by
the public and the Supervisors of White Township have exercised
authority over it for this period, used and maintained it as and
for a public road at the expense of the taxpayers of White Township.

That said "Glendale Road" beginning at the small Village of
Fiske in White Township, where it intersects with State Highway
Traffic Route Number 96, which is a distance of approximately
4752 feet West of its intersection with State Highway Route Number
53 and extending in a Westerly direction for a distance of 14256
feet where it intersects with the Flinton-Patton Road, now known
as State Highway Traffic Route Number 165, at the Gates Farm, a
distance of approximately 5280 feet North of where the Schwartz
Road intersects with said Flinton-Patton Road, now Traffic Route
165, has become inconvenient, impracticable and burdensome, by
reason of the fact that improved highways have been constructed
to carry the traffic formerly passing over it, and said road is
no longer necessary for the travelling public.

Your Petitioners therefore pray your Honorable Court to appoint three members of the Permanent Board of Viewers as a board of view, to view and report upon the advisability of vacating said road, between the termini above mentioned, and to return with their report of said road proposed to be vacated, a plot or draft thereof as required by the Act of the General Assembly and supplements thereto, in such case made and provided.

And they will ever pray, etc.

STATE OF PENNSYLVANIA :
: SS:
COUNTY OF CALBRIA :

Before me, the subscriber, a *Justice of The Peace*
in and for said County and State, personally came,
J. M. Gates who being by me duly sworn according to law,
deposes and says, that the matters set forth in the foregoing
petition are true and correct as he verily believes, and that the
signatures attached hereto and made a part of the petition are
in the proper handwriting of the parties thereby indicated.

Sworn to and subscribed :

before me this *Seventh* :
day of October, 1932. :

W. M. Hedinger, J.P. :

J. M. Gates

My Commission expires first
Monday, in January, 1934

J. T. Black
Mrs C Black
Mrs Roy T Black
L. C. Black
Ida M Black
Lura Hilder
Geo. J. Gates
W. A. Youngkin
D. H. Fleming
E. P. Fleming
W. A. Fleming
Grace Fleming
W. H. Strayer
Geo. E. Swartz
L. B. Swartz

SUPERVISORS:

J. Adam Glass
J. J. Esch.
C. D. McJill
Levi Symmonds
Fred J. Glass.
Harry C. Glass.

B. J. Proctor
G. M. Gates

No. 5 *Sept* Term, 1932.

In the Court of Quarter
Sessions of Cambria County,
Pennsylvania.

In Re: Vacation of the
"Glendale Eoad" in White
Township.

Petition for Appointment
of Viewers.

And Now, this *14* day of No-
vember, 1932, the within peti-
tion presented and read and
upon due consideration thereof,
the Court do appoint

Albert L. O'Connor, Esq.

L. E. Kayser

three members of the Permanent
Board of Viewers to view the
premises and make return
thereof to the next term of
Court, in accordance with the
Act of Assembly in such case
made and provided *By the Court*

M. Carson, P. J.

ALBERT L. O'CONNOR
ATTORNEY AT LAW
EBENSBURG & LORETTA, PA.

Filed: Nov. 16-1932

R E P O R T O F V I E W E R S .

To the Honorable, the Judges of the Court of Quarter Sessions
of Cambria County, Pennsylvania.

We, the undersigned members of the Permanent Board of Viewers of Cambria Co., Pa., appointed by your honorable Court and upon the attached order of Court directed to view and determine as to the propriety of vacating a certain piece of public road in White Township, Cambria County, Pa., Beginning on the St. Augustine - Fa llen Timber road and ending on the Flinton - Patton road as specified on the attached order of the Court, respectfully report:

That having given due notice of the view and of the time and place of meeting of the viewers to the Commissioners of Cambria County, to the Supervisors of the Township of White and to the traveling public, by printed hand bills posted in public and conspicuous places at and near the termini and along the route of the piece of road to be viewed: All of us met at the place appointed, in accord with the notices posted and served as aforesaid and having been each first duly sworn according to law to perform the duties of our appointment faithfully, impartially and according to the best of our judgment and ability, proceeded to view the piece of road in question and to inquire into the necessity for said road as a matter of use, convenience and accomodation to the traveling public, and are all of the opinion that it is not necessary as a public road but that it has become useless, inconvenient and burdensome to the taxpayers of said Township of White and therefore should be vacated.

Said piece of road; a plot or draft of which is hereto attached and made a part of this report; begins on the public road above stated, in the Village of Fisk, on Traffic Route 96 approximately 4752 feet west of the intersection of Route 96 with State Route No. 53 and extends thence the following courses and distances, viz: north 12° west 640.5 ft., north 31° west 373 ft., north 36° 45' west 271.5 ft., north 56° west 363.5 ft., north 59° west 351.6 ft., north 67° 30' west 572.7 ft., north 77° 30' west 376.5 ft., south 88° 45' west 422.5 ft., north 88° 20' west 467.6 ft., north 65° west 246 ft.,

north 56° west 257.5 ft., north 71° west 345.5 ft., north 55° west 359 ft., north 60° west 232.5 ft., north 43° 30' west 336.2 ft., north 29° west 550 ft., north 2° west 201.7 ft., north 17° 10' east 233.5 ft., north 29° east 545 ft., north 1° 30' east 89.6 ft., north 39° west 502 ft., north 36° 30' west 564.5 ft., north 44° 30' west 744.3 ft., north 38° west 922.1 ft., north 29° west 536.5 ft., north 57° 30' west 152.6 ft., north 76° 30' west 235.5 ft. and north 60° west 2117.4 ft. to the Flinton - Patton road, at Glendale, said point of ending being more particularly described as Route 165 and the point of ending at approximately 5280 ft. northward from the juncture of the Schwartz Road with said Traffic Route No. 165.

The undersigned viewers recommend that said portions of the above described road between points indicated on the attached draft as between "A" & "B" and between "C" & "D" be left open as ~~xx~~ private roads for the accomodation of the adjacent property owners.

Witness our hands this 5th. day of December A. D., 1932.

A. M. Shoemaker

James M. Carr

Louis E. Taylor

Viewers.

IN THE COURT OF QUARTER SESSIONS OF CAMBRIA COUNTY, Pa.

To, the Honorable judges of said Court:-

Whereas on the 14th. day of November, 1932, your honorable Court appointed A. M. Shoemaker, James McCann and L. E. Kaylor, viewers upon^a petition^s entered to No. 5 September Sessions, 1932, and whereas the said viewers have properly advertised and regularly held said view on the 2nd. day of December last but as yet have not been able to get together to sign the report on same,

Therefore I respectfully petition your honorable Court to continue the said view and extend the time for reporting on said road until the first Monday of March, next.

A. M. Shoemaker

The above petition being read and considered the Courtt does hereby grant the prayer of the above petitioner and extend the time for filing said report until the forst Monday of March next,

By the Court
McKerrick

NOTICE OF VIEW.

Notice is hereby given that the viewers appointed by the Court of Quarter Sessions of Cambria Co., Pa., to view and determine as to the propriety of vacating a certain piece of public in White Township, said county and state; Beginning in the Village of Fisk where the road leading from ^{the} St. Augustine - Fallon Tim road to ^{the} Flinton - Patton road intersects with the State Highway Route 96, which is a distance of approximately 4752 feet west of intersection with State Highway Route 53 and extending in a west direction for a distance of 14256 feet where it intersects with Flinton - Patton road, now known as State Highway Route 165, at Gates Farm, a distance of approximately 5280 feet north of where Schwartz road intersects with said Flinton Patton road, now traffic Route 165,:

Said Viewers, appointed as aforesaid, will meet at the point beginning, above indicated, in the Township of White, Cambria County Pa., December 2nd., 1932, at 9:30 a. m., for the purpose of performing the duties of their said appointment.

A. M. Shoemaker,
James McCann and
L. E. Kaylor,
Viewers.

Service of above notice accepted
B. J. Shoemaker

N O T I C E O F V I E W .

Notice is hereby given that the viewers appointed by the Court of Quarter Sessions of Cambria Co., Pa., to view and determine as to the propriety of vacating a certain piece of public road in White Township, said county and state: Beginning in the Village of Fisk where the road leading from ^{the} St. Augustine - Fallen Timber road to ^{the} Flinton - Patton road intersects with the State Highway Route 96, which is a distance of approximately 4752 feet west of its intersection with State Highway Route 53 and extending in a westerly direction for a distance of 14356 feet where it intersects with the Flinton - Patton road, now known as State Highway Route 165, at the Gates Farm, a distance of approximately 5280 feet north of where the Schwartz road intersects with said Flinton Patton road, now traffic Route 165,:

Said Viewers, appointed as aforesaid, will meet at the point of beginning, above indicated, in the Township of White, Cambria County, Pa., December 2nd., 1932, at 9:30 a. m., for the purpose of performing the duties of their said appointment.

A. M. Shoemaker,
James McCann and
L. E. Kaylor,
Viewers.

*Service of the above notice is hereby
accepted by the undersigned Super-
visor of White Township, Cambria
Co., Pa.*

G. M. Gates Supervisor

NOTICE OF VIEW.

Notice is hereby given that the viewers appointed by the Court of Quarter Sessions of Cambria County, Pa., to view and determine as to the propriety of vacating a certain piece of public road in White Township, said county and state: Beginning in the Village of Fisk where the road leading from the St. Augustine - Fallen Timber road to the Flinton - Patton road intersects with State Highway Route 96, which is a distance of approximately 4752 feet west of its intersection with State Highway Route 53 and extending in a westerly direction for a distance of 14256 feet where it intersects with the Flinton - Patton road, now known as State Highway Route 165, at the Gates Farm, a distance of approximately 5280 feet north of where the Schwartz road intersects with said Flinton - Patton road, now traffic route 165,:

The undersigned viewers, appointed as aforesaid, will meet at the point of beginning, above indicated, in the Township of White, Cambria County, Pa., *Dec 2nd* 1932, at 9:30 a. m., for the purpose of performing the duties of their said appointment.

A. M. Shoemaker,

James McCann and

L. E. Kaylor,

Viewers.

A copy of the above notice was served on the County Commissioners more than six days prior to the date set for the view.

A. M. Shoemaker

County of Cambria

To A. M. Shoemaker Dr

To preparing, posting and serving notices of view	18 ⁰⁰	03
27 mi @ 10¢ per mi	2,70	19
Stenographer & Stationery	25	19
View of Road	6 ⁰⁰	03
27 miles	270	19
Survey, plot & draft of 14,292.3 ft of Township road	27 ⁰⁰	03
Helpers (3) at 1.50 each	4 ⁵⁰	04
prints (2)	2 ⁰⁰	19
27 miles	270	19
securing continuance	3 ⁰⁰	03
Preparing, having signed, assembling & filing report Drivers	18 ⁰⁰	03
Stenographer & Stationery	25	19
	<u>91.35</u>	
Less. —	31.35	
	<u>60.00</u>	

Feb 24 1933 Cash

Camden County

To James McLean Dr

Dec 2nd 1932. 1/2 day viewing
Glendale Road. White
Township

Mileage 46 miles

Paid 2-10-1933- no 407

600 03

460 19

10.60

PAID 10 1933 OCT 10 1933

Caribou County

To Louis E. Naylor Jr

Dec 2nd 1932 1/2 Day on View

6.00

03

Glendale Road White Trip -

Mileage - 28 Miles

2.80

19

\$ 8.80

Paid 2/10/1933 - 408

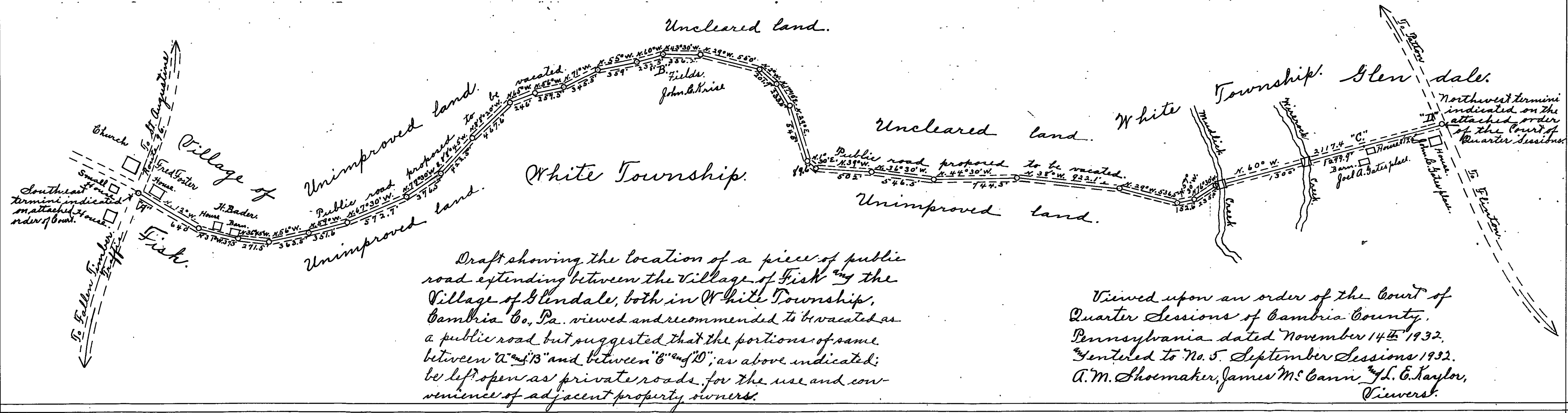

Commonwealth of Pennsylvania, }
County of Cambria. } SS.

At a Court of Quarter Sessions of the Peace of the County of Cambria held at Ebensburg, in the
said County, on the 14 day of November A. D. 1923, be-
fore the Honorable Judge of the said Court: Upon the petition of divers inhabitants of the Township
of White

in the said County, setting forth that ~~the said road was long since laid out and opened through White Twp. leading from the St. Augustine- Fallen Timber Road to the Flinton Patton Road and known as the Glendale Road: That no record of open- ing of said road has been found; that said Glendale road has for Twenty-One years and upwards been used by the public and the Super- visors of White Twp. have exercised authority over it for this per- iod, used and maintained it as and for a public road at the expense of the Taxpayers of White Twp.~~

That said Glendale Road beginning at the small village of Fiske in White Twp, where it intersects with ~~state~~ Highway Traffic Route Number 96, which is a distance of approximately 4752 feet West of its intersection with ~~State~~ Highway Route No. 53 and extend- ing in a westerly direction for a distance 14256 feet where it inter- sects with the Flinton Patton road, now known as State Highway Traffic Route No. 165, at the Gates Farm, a distance of approximate- ly 5280 feet North of where the Schwartz Road intersects with said Flinton- Patton Road, now Traffic Route 165, has become inconvenient impracticable and burdensome, by reason of the fact that improved highways have been constructed to carry the traffic formerly passing over it, and said road is no longer necessary for the travelling Public.

and therefore praying the Court to appoint proper persons to view and ~~vacate~~ ^{Vacate} the same according to law. The Court, upon due consideration had of the premises, do order and appoint

A.M. Shoemaker

surveyor, and

James McCann and L.E. Kaylor

viewers, to view the ground proposed for ~~such road~~ ^{vacation} and if they ~~agree~~ ^{vacate} view the same, and shall agree that there is ^{an} occasion for such road, they shall proceed to ~~the same~~ ^{vacate} the same, having respect to the shortest distance and the best ground for a road, and in such manner as shall do the least injury to private property, and also be as far as practicable, agreeable to the desires of the petitioners, and that they make a report of their proceedings to the next Court of Quarter Sessions to be held for said County, stating particularly whether they judge the same necessary for a public or private road, together with a plot or draft thereof, and the courses and distances, and references to the improvements through which it may pass.

By the Court.

JOHN H. McCANN. PRES. JUDGE

Attest:

James M. Jones, Clerk.

NOTE. "It shall be the duty of all persons appointed in the several counties of this Commonwealth to view and review any public or private road or bridge, if they shall decide in favor of locating said road or bridge, to endeavor to procure from the person or persons over whose land such location may be made releases from all claims for damages that might arise from the opening of such road or the building of such bridge; and in every case where said viewers shall fail to procure such releases, and it shall appear to them that any damages will be sustained, it shall be their duty to assess the damages and make report thereof signed by a majority of their number, and return the same, together with all releases obtained, to the Court of Quarter Sessions, and the damages so assessed shall be conclusive, or may be subject to appeal, review or modification, as may be provided by existing laws in the different counties of this Commonwealth."

"The persons appointed as aforesaid shall view such ground, and if they shall agree that there is occasion for a road, they shall proceed to lay out the same, having respect to the shortest distance, and the best ground for a road, and in such manner as shall do the least injury to private property, and also be, as far as practicable, agreeable to the desire of the petitioners."

"The viewers, as aforesaid, shall make report at the next term of said Court, and in the said report shall state particularly: First, who of them were present at the view, second, whether they were severally sworn or affirmed; third, whether the road desired be necessary for a public or private road; they shall also annex and return to the Court a plot or draft thereof, stating the courses and distances, and noting briefly the improvements through which it may pass; and, whenever practicable, the viewers shall lay out the said roads at an elevation not exceeding five degrees (except at the crossing of ravines and streams), where, by moderate filling and bridging, the declination of the road may be preserved within that limit."

NO. 5th Sept. SESSIONS, 1933

Order to view Glendale Road

in White Township.

and

Report of Viewers

Viewers

A.M. Shoemaker

James McCann

L.E. Kaylor

Clerk James. M. Jones. 25 cts.

Filed: Jan. 27, 1933

23rd Apr. 1933
1904 17th
1912 13th

Mar. 13, 1933 Approved

By the Court
McKenney

12 June 1933

Informed Absolutly
John Jones

