

Not Microfilmed

RD #
4

June 1920

Joseph Barley

Host River

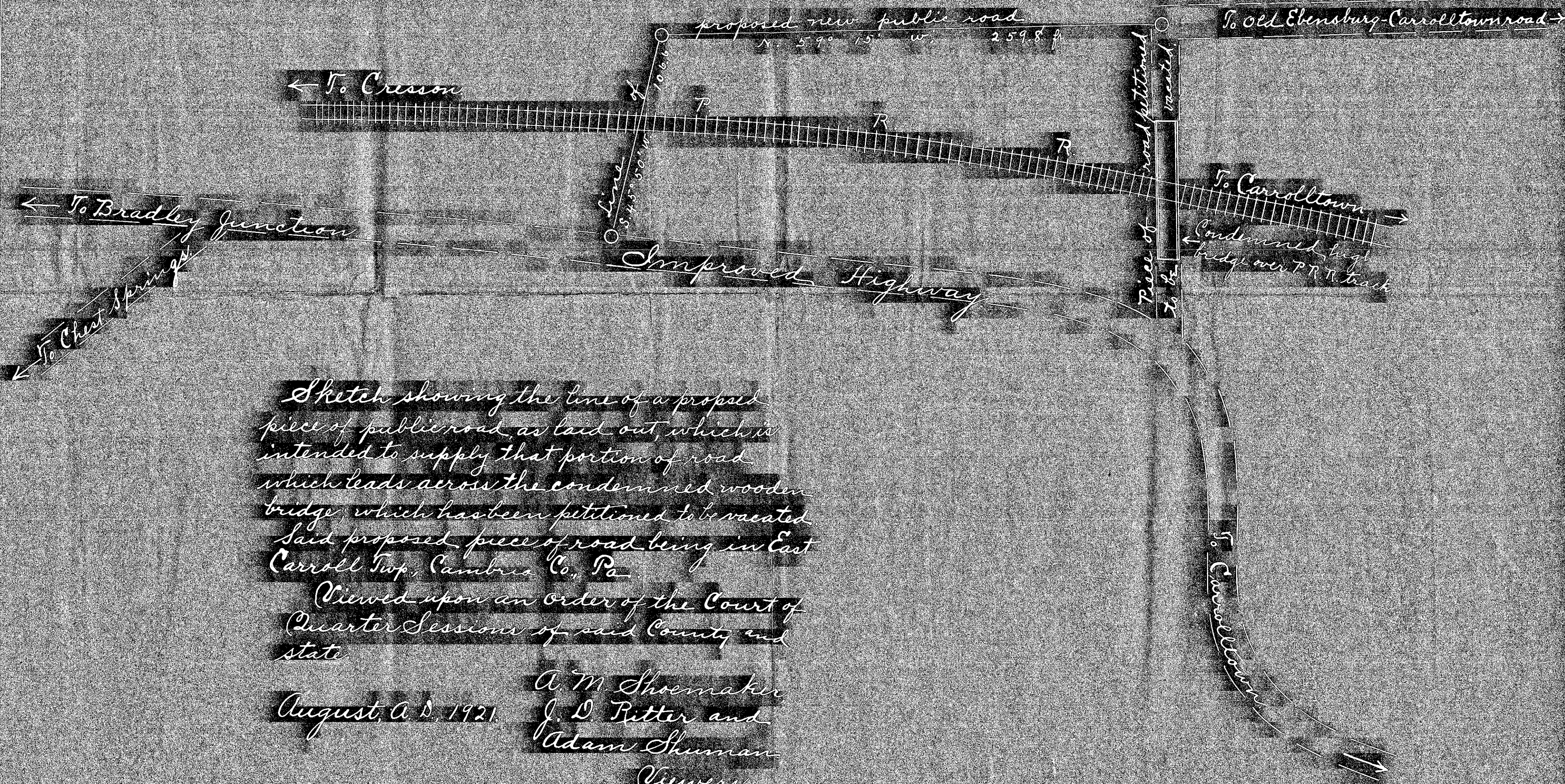

Sketch showing the line of a proposed piece of public road, as laid out, which is intended to supply that portion of road which leads across the condemned wooden bridge, which has been petitioned to be vacated. Said proposed piece of road being in East Carroll Twp., Cambria Co., Pa.

Viewed upon an order of the Court of Quarter Sessions of said County and state.

August, A.D. 1921
 A. M. Shoemaker
 J. D. Ritter and
 Adam Shuman
 Viewers

Joseph Barley.

Hot Brown

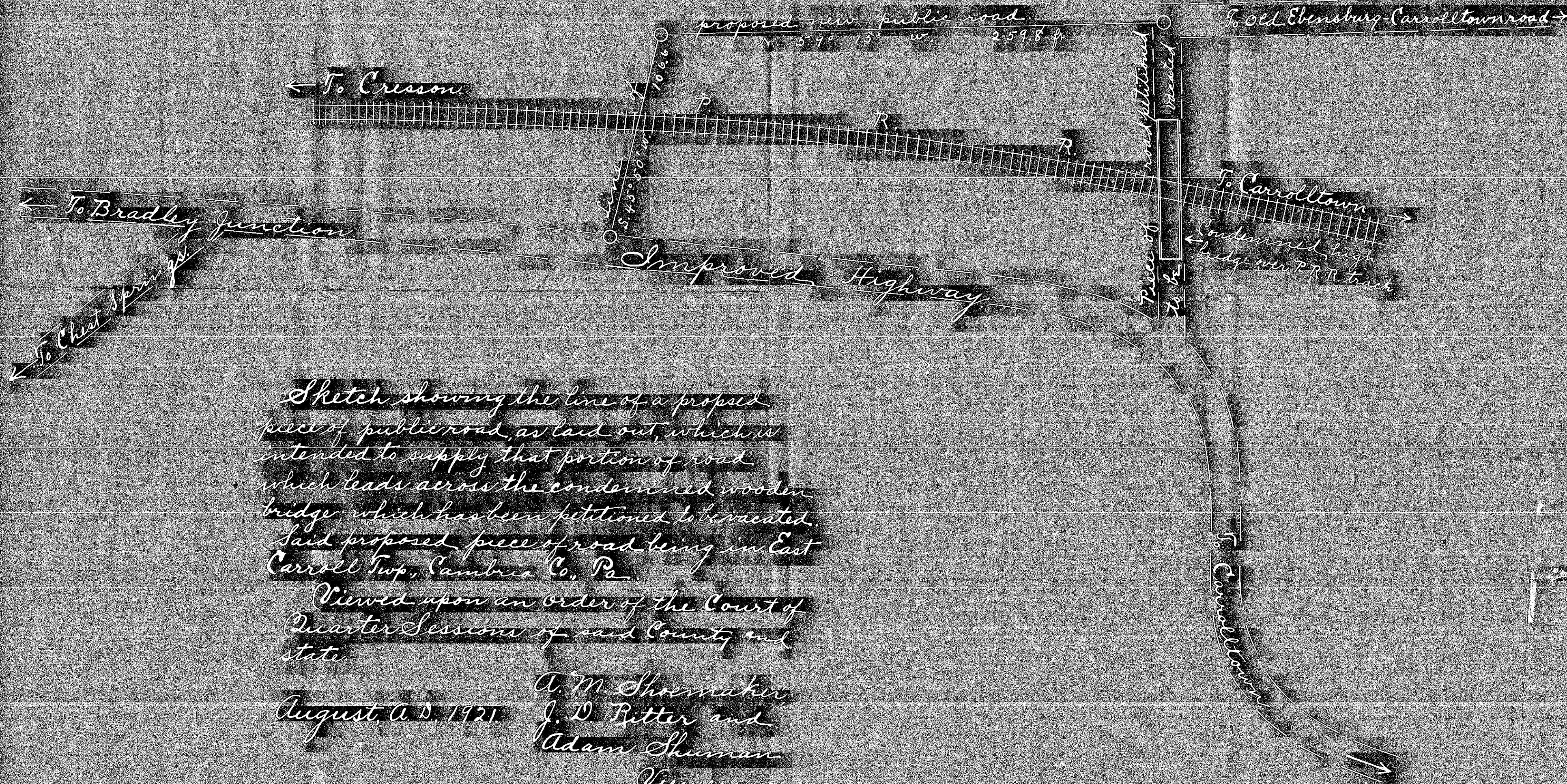

Sketch showing the line of a proposed piece of public road, as laid out, which is intended to supply that portion of road which leads across the condemned wooden bridge, which has been petitioned to be vacated. Said proposed piece of road being in East Carroll Twp., Cambria Co., Pa.

Viewed upon an order of the Court of Quarter Sessions of said County and state.

August A. D. 1921
A. M. Shoemaker,
J. D. Ritter and
Adam Shuman
Viewers.

No. ¹²² *June* September Sessions, 1921.

In the Court of Quarter Sessions of
Cambria Count, Pennsylvania.

Filed 11 August 1921

PETITION FOR APPOINTMENT OF
VIEWERS.

Now, August 8, 1921, within
Petition read and
A. M. Shormaster
J. H. Ritter.
Adam Shormaster

are appointed Viewers.
Samuel Linnond Reed
President Judge of the
Orphans Court
Specially Presiding.

SHETTIG & NELSON

ATTORNEYS-AT-LAW

EBENSBURG, - - - - PENNA.

IN THE COURT OF QUARTER SESSIONS OF CAMBRIA COUNTY, PA.

No. In September Sessions 1921.

PETITION FOR APPOINTMENT OF VIEWERS.

To the Honorable the Judges of the above named Court:

The petition of the undersigned inhabitants of the Township of East Carroll in said County of Cambria, respectfully represents:

That a portion of the road leading from the improved road known as the Carrolltown-Bradley Junction road to the old Ebensburg and Carrolltown road, the point of beginning of which is found by beginning at the intersection of a road leading from the Carrolltown-Bradley Junction road to Chest Springs and measuring along said Carrolltown-Bradley Junction road for a distance of six hundred ninety feet to the center of a bridge crossing the Cresson Division of the Pennsylvania Railroad, and the place of ending of which is found by beginning at the intersection of the road of which it is a part and the old Ebensburg-Carrolltown road and measuring along said road of which said portion herein described is a part for a distance of eight thousand five hundred fifty feet has become inconvenient, burdensome and dangerous by reason of the fact that the same crosses the railroad above mentioned by means of a wooden bridge and the point of approach to said bridge at both ends thereof leads off from sharp curves and at an excessive and dangerous grade.

Your petitioners therefore pray the court to appoint viewers to view the portion of the road above mentioned and to report to the court upon the propriety of having the same vacated as a public road.

That the proceedings whereby said road was laid out are found recorded in Road Docket Vol. _____ at page _____.

And they will ever pray, etc.

Herman Miller
Emory M. Luther
Asa B. Baker
Thad Jones
E. A. Beamer

Edw. D. Dunsen
J. E. Burling
J. S. Bennett
J. L. Burk
Alex. Stummatter
B. C. Randall

A. S. Schetter
Jos Burtz
Gilbert Baker
Frank ...

J. A. Springer

Cambria County : SS.

Herman Illig

being duly sworn according to law says

that the matters contained in the foregoing petition are true and correct as he
verily believes.

Sworn and subscribed before me

this 20th day of August 1921.

Philip N. Shetty

Notary Public

Comm. expires Jan'y. 22, 1925

Herman Illig

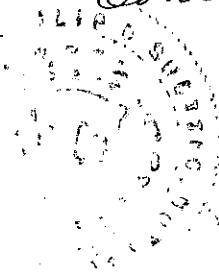

ROAD NOTICE

Notice is hereby given that the Viewers appointed by the Court of Quarter Sessions of Cambria County, Pa., to view and determine as to the propriety of vacating a certain piece of public road in East Carroll Twp., said county and state, from a point on the Bradley Junction-Carrolltown road, opposite the center of a bridge crossing the Cresson Division of the P.R.R.; which said point is 690 ft. Eastward along said Bradley Junction-Carrolltown road from the juncture of a road leading from Chest Springs, and ending at a point 8550 ft. Eastward; along a public road leading from the old Ebensburg-Carrolltown road to the Bradley Junction-Carrolltown road; from its juncture with said old Ebensburg-Carrolltown road;

will meet AT THE PLACE OF BEGINNING, Above designated in the Township of East Carroll aforesaid, on the 25th. day of August 19 21 at 9:30 o'clock A.M. for the purpose of performing the duties of their appointment.

A. M. Shoemaker,
J. D. Ritter and
Adam Shuman
Viewers.
Ebensburg, Pa. 8/13/19-21.

Now, August 17th 1921, service of the within notice is hereby
accepted for the County Commissioners of Cambria County, Pennsylvania.

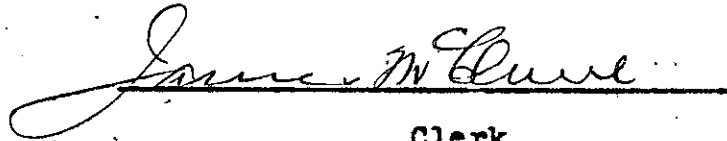
Clerk.

ROAD NOTICE

Notice is hereby given that the Viewers appointed by the Court of Quarter Sessions..... of Cambria County, Pa., to view and determine as to the propriety of vacating a certain piece of public road in East Carroll Twp., said county and state; from a point on the Bradley Junction - Carrolltown road, opposite the center of a bridge crossing the Cresson Division of the P.R.R.; which said point is 690 ft. Westward along said Bradley Junction-Carrolltown road from the juncture of a road leading from Chest Springs, and ending at a point 8550 ft. Eastward; along a public road leading from the old Ebensburg-Carrolltown road to the Bradley Junction-Carrolltown road; from its juncture with said old Ebensburg-Carrolltown road:..... will meet AT THE PLACE OF BEGINNING; above designated;..... in the Township..... of East Carroll..... aforesaid, on the 25th, ... day of ... August..... 1921, at 9:30 o'clock A. M., for the purpose of performing the duties of their appointment.

..... A. M. Shoemaker,.....
..... J. D. Ritter and.....
..... Adam Shuman,.....
Ebensburg, Pa. 8/13/1921. Viewers.

Now, August *24th* 1921, service of the within notice is hereby
accepted for the Pennsylvania Railroad Company.

Allen P. Cuthbert
Japt

REPORT OF VIEWERS .

To the Honorable, the Judges of the Court of Quarter Sessions of
Cambria County, Pennsylvania.

We, the undersigned members of the permanent board of viewers of Cambria County, appointed by your honorable Court upon the attached order and therein directed to view and determine as to the propriety of vacating a certain piece of public road in East Carroll Township, said county and state; between the terminal points specified in said order; respectfully report:

That having given due notice of the view and of the time and place of meeting of the viewers to the Commissioners of Cambria County, the Supervisors of the Township of East Carroll and the Pennsylvania Railroad Co., by serving them with a written notice thereof, and to the traveling public by printed hand bills posted in public and conspicuous places at and near the terminal points of the piece of road proposed to be vacated, and having been first duly sworn according to law to perform the duties of our appointment faithfully, impartially and to the best of our judgment and ability: all of us met at the time and place appointed and having carefully viewed the premises and are all of the opinion that the piece of road in question should be vacated, as the lay out of said piece of road is such that both by reason of the sharp turns and heavy grade on of the track of the P.R.R.Co. where same is crassed by a high bridge, either side/make traffic over same very dangerous.

A plot or draft showing the courses and distances of the piece of road herein recommended to be vacated is hereto attached and made a part of this report. Said piece of road beginning at a point on the road leadin from the old Ebensburg and Carrolltown road to the Bradley Junction - Carrolltown road at a point on same eight thousand five hundred fifty feet Eastward from said old Ebensburg-Carrolltown road and extending thence South fifty nine degrees fifteen minutes East, thence North thirty three degrees twenty minutes East one hundred fifty five feet to the point of ending on the Bradley Junction - Carrolltown road.

Witness our hands this
third day of September A.D.,
1921.

A. M. Shoemaker
J. D. Ritter

Viewers.

Cost of View

A. M. Shoemaker

SEP 23 1921 CERTIFIED

Lifting Order ———.90
3 1/2 Days ———26.25
Engineering work,
5 1/2 miles (two trips) 25.00
2.60

\$54.75

SEP 23 1921 CERTIFIED

SEP 23 1921 CERTIFIED

Adam Shuman

1 Day ———7.50
48 miles ———2.40

\$9.90

SEP 23 1921 CERTIFIED

SEP 23 1921 CERTIFIED

J. D. Pitter

1 1/2 Day ———17.75
26 miles 1.30

\$19.05

SEP 23 1921 CERTIFIED

APPROVED FOR PAYMENT
[Signature]
COMMISSIONER

Hotel Bros. Farm

Farm of Joseph Burley

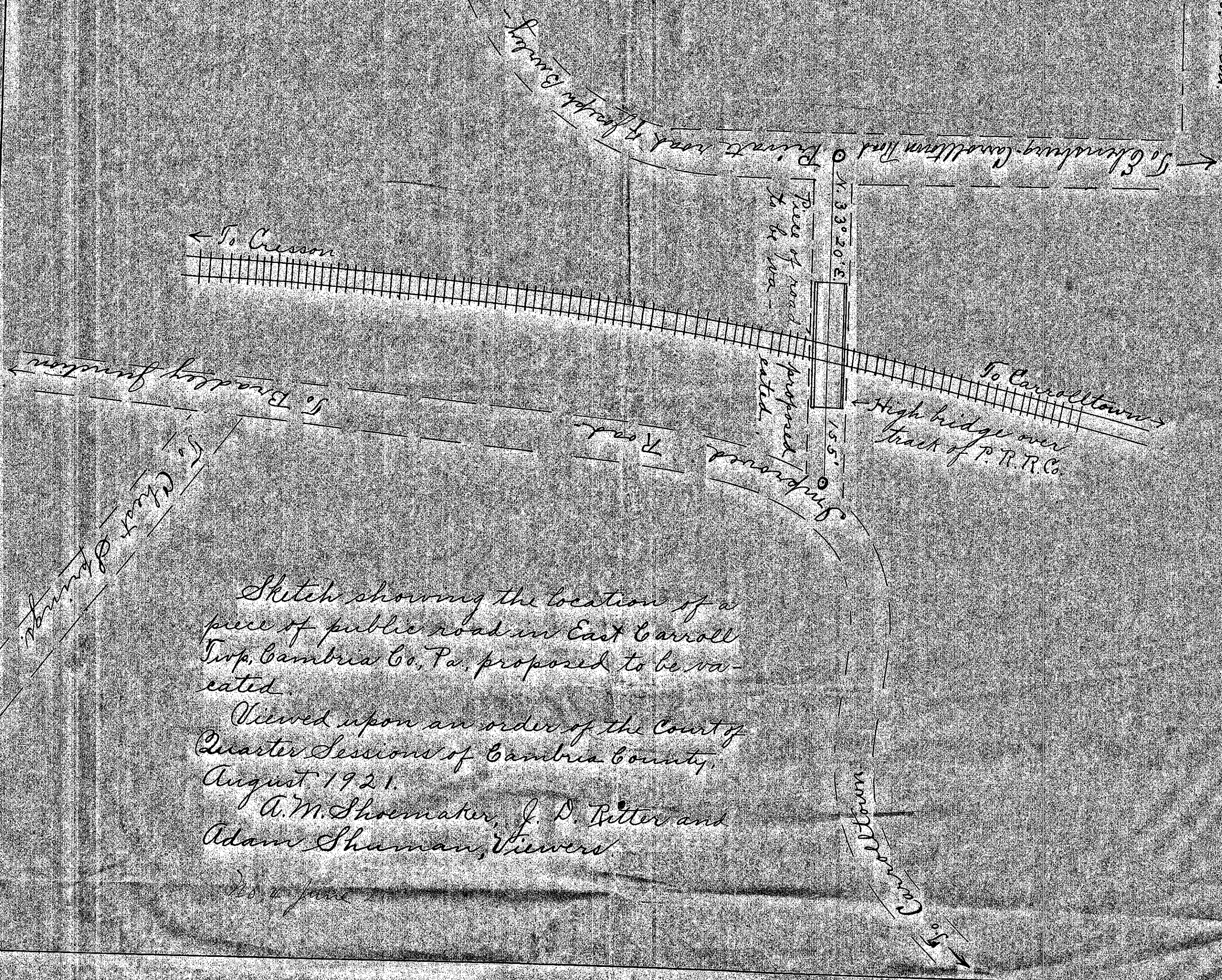

Sketch showing the location of a piece of public road in East Carroll Twp, Cambria Co., Pa. proposed to be vacated.

Viewed upon an order of the Court of Quarter Sessions of Cambria County, August 1921.

A. M. Shoemaker, J. D. Ritter and Adam Shuman, Viewers

No. 10 June 20, 1921

NO 4, June SESSIONS, 1921

Order to view

~~In re Petition inhabitants of~~
~~the Township of East Carroll to~~
~~Vacate a public road leading~~
~~from the improved road known~~
~~as the Carrolltown-Bradley~~
~~Junction Road to the old~~
~~Ebensburg and Carrolltown Road.~~

~~A. M. Shoemaker~~

~~J. D. Ritter~~

~~Adam Shuman~~

Viewers

Clerk ~~Robb~~ 90 cts.

Filed Sept. 10, 1921

12 Sept. 1921 approved.

Becke Caust

NOTE. "It shall be the duty of all persons appointed in the several counties of this Commonwealth to view and review any public or private road or bridge, if they shall decide in favor of locating said road or bridge, to endeavor to procure from the person or persons over whose land such location may be made releases from all claims for damages that might arise from the opening of such road or the building of such bridge; and in every case where said viewers shall fail to procure such releases, and it shall appear to them that any damages will be sustained, it shall be their duty to assess the damages and make report thereof signed by a majority of their number, and return the same, together with all releases obtained, to the Court of Quarter Sessions, and the damages so assessed shall be conclusive, or may be subject to appeal, review or modification, as may be provided by existing laws in the different counties of this Commonwealth."

"The persons appointed as aforesaid shall view such ground, and if they shall agree that there is occasion for a road, they shall proceed to lay out the same, having respect to the shortest distance, and the best ground for a road, and in such manner as shall do the least injury to private property, and also be, as far as practicable, agreeable to the desire of the petitioners."

"The viewers, as aforesaid, shall make report at the next term of said Court, and in the said report shall state particularly: First, who of them were present at the view, second, whether they were severally sworn or affirmed; third, whether the road desired be necessary for a public or private road; they shall also annex and return to the Court a plot or draft thereof, stating the courses and distances, and noting briefly the improvements through which it may pass; and, whenever practicable, the viewers shall lay out the said roads at an elevation not exceeding five degrees (except at the crossing of ravines and streams), where, by moderate filling and bridging, the declination of the road may be preserved within that limit."

Commonwealth of Pennsylvania, }
County of Cambria. } SS.

At a Court of Quarter Sessions of the Peace of the County of Cambria held at Ebensburg, in the said County, on the 8th. day of August A. D. 1921, before the Honorable Judge of the said Court: Upon the petition of divers inhabitants of the Township of East Carroll, in the said County, setting forth that they labor under inconvenience for want of a _____ road or highway, to lead from

That a portion of the road leading from the improved road known as the Carrolltown-Bradley Junction road to the old Ebensburg and Carrolltown road the point of beginning of which is found by beginning at the intersection of a road leading from the Carrolltown-Bradley Junction road to Chest Springs and measuring along said Carrolltown-Bradley Junction road for a distance of six hundred ninety feet to the center of a bridge crossing the Cresson Division of the Pennsylvania Railroad, and the place of ending of which is found by beginning at the intersection of the road of which it is a part ~~and~~ the old Ebensburg-Carrolltown road and measuring along said road of which said portion herein described is a part for a distance of eight thousand five hundred fifty feet has become inconvenient, burdensome and dangerous by reason of the fact that the same crosses the railroad above mentioned by means of a wooden bridge and the point of approach to said bridge at both ends thereof leads off from sharp curves and at an excessive and dangerous grade.

and therefore praying the Court to appoint proper persons to ^{vacate} view and ~~lay out~~ the same according to law. The Court, upon due consideration had of the premises, do order and appoint A. M. Shomaker, _____ surveyor, and

J. D. Ritter, and Adam Shuman.

viewers, to view the ground proposed for said road, and if they view the same, and shall agree that there is occasion for such road, they shall proceed to lay out the same, having respect to the shortest distance and the best ground for a road, and in such manner as shall do the least injury to private property, and also be as far as practicable, agreeable to the desires of the petitioners, and that they make a report of their proceedings to the next Court of Quarter Sessions to be held for said County, stating particularly whether they judge the same necessary for a public or private road, together with a plot or draft thereof, and the courses and distances, and references to the improvements through which it may pass.

By the Court.

Attest:

Franc. C. Robb Clerk.