

IN THE COURT OF QUARTER SESSIONS OF CAMBRIA COUNTY, PENNSYLVANIA.

IN RE: Order to View and Assess Damages in the Matter of the Changes in Location and Lines of a Highway Known as State Highway No. 222, in the Borough of Geistown, in said County and State.

No. 4 June Sessions, 1951.

RECEIPT FOR DAMAGES FIXED BY VIEWERS AND SATISFACTION
OF THE RECORD.

NOW, this 15th day of November, 1951, the undersigned, attorneys for Herman H. Hoffman in the above stated case, acknowledge receipt this date of the sum of Forty-two Thousand Two Hundred Fifty (\$42,250.00) Dollars. The sum of Ten Thousand (\$10,000.00) Dollars was heretofore paid to Herman H. Hoffman, and the Clerk of said Court is hereby authorized and directed to mark the record satisfied in the above stated case.

SHETTIG & SWOPE,
Attorneys for Herman H. Hoffman,

By  Partner.

No. 4 June Sessions, 1951.
In the Court of Quarter Sessions of
Cambria County, Pennsylvania.

IN RE: Order to View and Assess
Damages in the Matter of the Changes
in Location and Lines of a Highway
known as State Highway No. 222, in
the Borough of Geistown, in said
County and State.

RECEIPT FOR DAMAGES FIXED BY VIEWERS
AND SATISFACTION OF THE RECORD.

Filed
11/15/51

SHETTIG & SWOPE
ATTORNEYS AT LAW
EBENSBURG, PA.

IN THE COURT OF QUARTER SESSIONS OF CAMBRIA COUNTY, PENNA.

IN RE: Order to View and Assess Damages in the Matter of the Changes in Location and Lines of a Highway known as State Highway No. 222, in the Borough of Geistown, in said County and State.

No. 4 June Sessions, 1951

O R D E R

Now, September 28, 1951, it appearing to the Court that all parties in interest have waived the thirty day period before confirmation absolute of the report of viewers in the above stated proceeding and have agreed in writing to have the report of the viewers confirmed absolutely at any time before the expiration of the thirty day period and upon the filing of said agreement in writing.

The report of the viewers in said proceeding is hereby confirmed absolutely.

By the Court:

McKenrick

McKenrick, Judge

ENTERED on this

the 1st day of Oct.

A. D., 1951

Joseph E. Wess

Clerk of Court

In re: Order to view and assess damages in the matter of the changes in location and lines of a highway known as State Highway No. 222, in the Borough of Geistown, in said County and State.

In the Court of Quarter Sessions of Cambria County, Pennsylvania.
No. 4 June Sessions, 1951

REPORT OF VIEWERS

To the Honorable, the Judges of the above named Court, we the undersigned Viewers, appointed by the annexed order of the Court to view and assess damages in the matter of the changes in location and lines of a highway known as State Highway No. 222 in the Borough of Geistown, County of Cambria, and State of Pennsylvania, respectfully report:

That we have been duly sworn or affirmed as members of the Permanent Board of Viewers of Cambria County, as shown by the records of the Court; that having given due public notice of the time and place of meeting, by posting notices as required by law along the route and at the site of property to be viewed, as evidenced by copy of said notice hereto attached and service of such notice on the County Commissioners of Cambria County, the State Highway Department, the Solicitor for the Petitioner, and the Solicitor for the Plaintiff, that we met in accordance with the notice given on the 8th day of June, A. D. 1951 at 10:30 A.M., D.S.T. for the purpose of performing the duties of our appointment and viewed the property.

Notices for a hearing to be held in the Judge's Chambers, U. S. National Bank Building at 1:30 P.M., D.S.T. on Wednesday, June 20, 1951, were sent out. This hearing was postponed due to the fact that Mr. George M. Spence, Attorney for the Highway Commission was in the hospital, therefore notices for a second hearing to be held in the Judge's Chambers, U. S. National Bank Building at 10:00 A.M., D.S.T. Wednesday, August 22, 1951 re the order to view and assess damages in the matter of the changes in location and lines of a highway known as

State Highway No. 222, in the Borough of Geistown, Cambria County, Pennsylvania, were sent out. At this hearing the Plaintiff was represented by Shettig & Swope and five (5) witnesses. The services of Mr. Myers from Ebensburg were obtained to take testimony. At the view and during the hearing, the Viewers based their assessment of damages on the following conditions:

- First: Value of land and buildings before the taking. The Viewers also considered the development of the land taken, such as fruit trees, etc.
- Second: The cost of moving the dwelling and sheds to a new location.
- Third: The value of the dwelling before the taking and after the taking.
- Fourth: The value of the land remaining after the taking, and the value of the buildings in their new location.
- Fifth: The value of the buildings as relocated and as effected by ingress and egress to the remaining property.

After taking into consideration all the matters above briefed, the Viewers hereby assess total damages to Herman H. Hoffman in the amount of fifty-two thousand two hundred and fifty dollars (\$52,250.00) and the Viewers assess no benefits.

Witness our hands and seals this twenty-ninth day of August, 1951.

Frank Caplan Chairman

Robert H. Myers

Morton J. Zimmerman
Viewers

In re: Order to view and assess damages in the matter of the changes in location and lines of a highway known as State Highway No. 222, in the Borough of Geistown, in said County and State.

In the Court of Quarter Sessions of Cambria County, Pennsylvania.
No. 4 June Sessions, 1951

TO F. W. CLAFLIN, ROBERT MAYER AND MAHLON J. BAUZGARDNER

To F. W. Claflin, Dr.

May 26, 1951	Data and preparing notices of view	1 day	\$12.00	
	Stenographer typing notices, stationery, stamps, etc.		2.80	
29	Posting and serving notices of view	1 day	12.00	
	Mileage 10 miles		1.00	
June 6	Making view	1 day	12.00	
	Mileage 10 miles		1.00	
August 22	Hearing Judge's Chambers	1 day	12.00	
	Mileage 5 miles		0.50	
28	Viewer's meeting Gray & Claflin office	1 day	12.00	
29	Making and writing report	1 day	12.00	
	Stenographer typing report		3.20	
September 4	Exhibit of schedules Gray & Claflin office	1 day	12.00	
	Filing report	1 day	12.00	
7	Mileage 40 miles		4.00	\$108.50

To Robert Mayer, Dr.

June 6, 1951	Making view	1 day	12.00	
	Mileage 8 miles		0.80	
August 22	Hearing in Judge's Chambers	1 day	12.00	
	Mileage 6 miles		0.60	
28	Viewers' meeting Gray & Claflin office	1 day	12.00	
	Mileage 6 miles		0.60	
September 4	Exhibit of Schedules Gray & Claflin office	1 day	12.00	
	Mileage 6 miles		0.60	50.60

To Mahlon J. Baumgardner, Dr.

June 6, 1951	Making view	1 day	\$12.00	
	Mileage 42 miles		4.20	
August 22	Hearing Judge's Chambers	1 day	12.00	
	Mileage 36 miles		3.60	
28	Viewers' meeting Gray and			
	Claflin office	1 day	12.00	
	Mileage 36 miles		3.60	
September 4	Exhibit of Schedules Gray			
	and Claflin office	1 day	12.00	
	Mileage 36 miles		3.60	\$ 63.00

TOTAL AMOUNT OF VIEW \$222.10

I hereby certify that the above bill is an exact duplicate of the bill presented to the Cambria County Commissioners.

F. W. Claflin
F. W. Claflin
Chairman of Board of View

In re: Order to view and assess
damages in the matter of the changes
in location and lines of a highway
known as State Highway No. 232, in
the Borough of Coistown, in said
County and State.

In the Court of Quarter
Sessions of Cambria County,
Pennsylvania.
No. 4 June Sessions, 1951

NOTICE OF VIEW

We, the undersigned Viewers, appointed by the above named Court for the purpose of viewing and assessing damages to property of Herman H. Hoffman in the matter of the changes in location and lines of a highway known as State Highway No. 232, in the Borough of Coistown, in said County and State. Beginning at a post at a corner of land formerly of Augustine Donato and Anna Donato on the southerly side of Bedford Street in said Borough of Coistown; thence by the line of Bedford Street south sixty-nine degrees fifty minutes ten seconds east two hundred sixteen feet and forty-eight hundredths of a foot to the southwesterly corner of the intersection of Bedford Street and Belmont Street; thence by the westerly line of Belmont Street south eighteen degrees west five hundred twenty-four feet and nine tenths of a foot to a point in said westerly line of Belmont Street at a corner of land of Harry G. Rice & Sons; thence by the line of said land of Harry G. Rice & Sons north seventy-two degrees thirty minutes west three hundred eighty-four feet and thirty-two hundredths of a foot to an iron pin, a corner of said land and in a line of land of St. Joseph's Catholic Cemetery; thence by the line of said Cemetery land north nineteen degrees three minutes forty seconds east four hundred twenty-two feet and nine tenths of a foot to a point on said line at a corner of the above-mentioned land formerly of Augustine Donato and Anna Donato; thence by the line of said Donato land south seventy-two degrees twenty-three minutes twenty seconds east one hundred fifty-nine feet and four tenths of a foot to a tack in a plug; thence still by said last mentioned land north eighteen degrees twenty-two minutes forty seconds east one hundred and fifteen feet and three tenths of a foot to the place of beginning. Containing four acres and one hundred eighty-three thousandths of an acre.

The Viewers will meet at the place of beginning on the 6th day of June A. D., 1951, at 10:30 A.M., D. S. T. for the purpose of performing the duties of our appointment at which time and place all interested persons may appear and be heard.

F. W. Claflin, Chairman
Robert Mayor
Mehlon J. Baumgardner

Viewers

May 29, 1951

No. 4 June Sessions 1951

In the Court of Quarter Sessions
of Cambria County, Pennsylvania

In the Matter of the Changes in
Location and Lines of a Highway
Known as State Highway Route
No. 222, in the Borough of
Geistown, in said County and
State.

Viewers Report

IN THE COURT OF QUARTER SESSIONS OF CAMBRIA COUNTY, PENNSYLVANIA

IN RE: Order to View and Assess Damages in the Matter of the Changes in Location and Lines of a Highway known as State Highway No. 222, in the Borough of Geistown, in said County and State.

No. 4

June Sessions, 1951

WAIVER OF RIGHT TO FILE EXCEPTIONS AND AGREEMENT THAT REPORT
OF VIEWERS BE MARKED CONFIRMED ABSOLUTELY.

NOW, this 28th day of September, 1951, the Commonwealth of Pennsylvania by its Secretary of Highways acting through Spence, Custer, Saylor & Wolfe, attorneys of record in this proceeding, and Herman H. Hoffman acting through Shettig & Swope, attorneys of record in this proceeding, waive the thirty day period before confirmation absolute of the report of viewers and agree in writing to have the report of viewers in the above stated case confirmed absolutely upon the filing of this Agreement with the Court and before the expiration of the thirty day period fixed by Section 303 of Article III of the Act of Assembly of June 1, 1945, P. L. 1242.

Commonwealth of Pennsylvania
By Secretary of Highways
Spence, Custer, Saylor & Wolfe,
Attorneys of record

BY

George M. Spence

Herman H. Hoffman
By Shettig & Swope,
Attorneys of record.

BY

Herman H. Hoffman

IN THE COURT OF QUARTER SESSIONS OF CAMBRIA COUNTY, PENNSYLVANIA

IN RE: Order to View and Assess Damages in the Matter of the Changes in Location and Lines of a Highway known as State Highway No. 222, in the Borough of Geistown, in said County and State.

No. 4 June Sessions, 1951

O R D E R

NOW, September 28, 1951, it appearing to the Court that all parties in interest have waived the thirty day period before confirmation absolute of the report of viewers in the above stated proceeding and have agreed in writing to have the report of the viewers confirmed absolutely at any time before the expiration of the thirty day period and upon the filing of said agreement in writing.

The report of the viewers in said proceeding is hereby confirmed absolutely.

BY THE COURT:

W. Kennerly
Judge

No. 4 June Sessions, 1951

In the Court of Quarter Sessions of
Cambria County, Pennsylvania

IN RE: Order to View and Assess Damages
in the Matter of the Changes in Location
and Lines of a Highway known as State High
way No. 222, in the Borough of Geistown,
in said County and State.

WAIVER OF RIGHT TO FILE EXCEPTIONS AND
AGREEMENT THAT REPORT OF VIEWERS BE
MARKED CONFIRMED ABSOLUTELY and ORDER

Filed
9/28/51

Spence, Custer, Saylor & Wolfe
Johnstown Bank & Trust Building
Johnstown, Pennsylvania

Shettig & Swope
Ebensburg, Pennsylvania

In re: Order to view and assess damages in the matter of the changes in location and lines of a highway known as State Highway No. 222, in the Borough of Geistown, in said County and State.

0 In the Court of Quarter
0 Sessions of Cambria County,
0 Pennsylvania.
0 No. 4 June Sessions, 1951
0

REPORT OF VIEWERS 8-

To the Honorable, the Judges of the above named Court, we the undersigned Viewers, appointed by the annexed order of the Court to view and assess damages in the matter of the changes in location and lines of a highway known as State Highway No. 222 in the Borough of Geistown, County of Cambria, and State of Pennsylvania, respectfully report:

That we have been duly sworn or affirmed as members of the Permanent Board of Viewers of Cambria County, as shown by the records of the Court; that having given due public notice of the time and place of meeting, by posting notices as required by law along the route and at the site of property to be viewed, as evidenced by copy of said notice hereto attached and service of such notice on the County Commissioners of Cambria County, the State Highway Department, the Solicitor for the Petitioner, and the Solicitor for the Plaintiff, that we met in accordance with the notice given on the 8th day of June, A. D. 1951 at 10:30 A.M., D.S.T. for the purpose of performing the duties of our appointment and viewed the property.

Notices for a hearing to be held in the Judge's Chambers, U. S. National Bank Building at 1:30 P.M., D.S.T. on Wednesday, June 20, 1951, were sent out. This hearing was postponed due to the fact that Mr. George M. Spence, Attorney for the Highway Commission was in the hospital, therefore notices for a second hearing to be held in the Judge's Chambers, U. S. National Bank Building at 10:00 D. S. T. Wednesday August 22, 1951 re/ the order to view and assess damages in the matter of the changes in location and lines of a highway known as State Highway No. 222, in the Borough of Geistown, Cambria County, Pennsylvania, were sent out. At this hearing

the Plaintiff was represented by Shettig & Swope and five (5) witnesses. the services of Mr. Myers from Ebensburg were obtained to take testimony. At the view and during the hearing, the Viewers based their assessment of damages on the following conditions:

- (1) Value of land and buildings before the taking. The Viewers also considered the development on the land taken, such as fruit trees, etc.
- (2) The cost of moving the dwelling and sheds to a new location.
- (3) The value of the dwelling before the taking and after the taking.
- (4) The value of the land remaining after the taking, and the value of the buildings in their new location.
- (5) The value of the buildings as relocated and as effected by ingress and egress to the remaining property.

After taking into consideration all the matters above briefed, the Viewers hereby assess total damages to Herman H. Hoffman in the amount of fifty-two thousand two hundred and fifty dollars (\$52,250.00) and the Viewers assess no benefits.

Witness our hands and seals this twenty-ninth day of August, 1951.

W. B. Caplin Chairman

Robert H. Meyer

Martha J. Zimmerman
Viewers

To Mahlon J. Baumgardner, Dr.

June 6, 1951	Making view	1 day	\$12.00	
	Mileage 42 miles		4.20	
August 22	Hearing Judge's Chambers	1 day	12.00	
	Mileage 36 miles		3.60	
80	Viewers' meeting Gray and			
	Claflin office	1 day	12.00	
	Mileage 36 miles		3.60	
September 6	Exhibit of Schedules Gray			
	and Claflin office	1 day	12.00	
	Mileage 36 miles		3.60	\$ 63.00
TOTAL AMOUNT OF VIEW				\$222.10

I heroby certify that the above bill is an exact duplicate of the bill presented to the Cambria County Commissioners.

F. W. Claflin

F. W. Claflin
Chairman of Board of View

In re: Order to view and assess
damages in the matter of the changes
in location and lines of a highway
known as State Highway No. 222, in
the Borough of Getstown, in said
County and State.

In the Court of Quarter -
Sessions of Cambria County,
Pennsylvania.
No. 4 June Sessions, 1951

TO F. W. CLAFLIN, ROBERT MAYER AND MARION J. BAULGARDNER

To F. W. Claflin, Dr.

May 23, 1951	Data and preparing notices of view	1 day	\$12.00	
	Stenographer typing notices, stationery, stamps, etc.		9.80	
29	Posting and serving notices of view	1 day	12.00	
	Mileage 10 miles		1.00	
June 6	Making view	1 day	12.00	
	Mileage 10 miles		1.00	
August 22	Hearing Judge's Chambers	1 day	12.00	
	Mileage 5 miles		0.50	
28	Viewer's meeting Gray & Claflin office	1 day	12.00	
29	Making and writing report	1 day	12.00	
	Stenographer typing report		3.20	
September 4	Exhibit of Schedules Gray & Claflin office	1 day	12.00	
7	Writing report	1 day	12.00	
	Mileage 40 miles		4.00	\$108.50

To Robert Mayer, Dr.

June 6, 1951	Making view	1 day	12.00	
	Mileage 6 miles		0.60	
August 22	Hearing in Judge's Chambers	1 day	12.00	
	Mileage 6 miles		0.60	
28	Viewer's meeting Gray & Claflin office	1 day	12.00	
	Mileage 6 miles		0.60	
September 4	Exhibit of Schedules Gray & Claflin office	1 day	12.00	
	Mileage 6 miles		0.60	20.60

No. 4 June Sessions 1951

In the Court of Quarter Sessions
of Cambria County, Pennsylvania.

In the Matter of the Changes in
Location and Lines of a Highway
known as State Highway Route
No. 222, in the Borough of
Geistown, in said County and
State.

Viewers Report

IN THE COURT OF QUARTER SESSIONS OF CAMBRIA COUNTY, PENNSYLVANIA

In the Matter of the Change in Location and Lines of a Highway known as State Highway Route No. 222, in the Borough of Geistown, in said County and State.

No.

June Sessions, 1951.

PETITION OF HERMAN H. HOFFMAN FOR THE APPOINTMENT OF VIEWERS

TO THE HONORABLE THE JUDGES OF THE ABOVE NAMED COURT:

The petition of Herman H. Hoffman respectfully represents:

1. Your petitioner is a citizen and resident of the Borough of Geistown, in the County of Cambria and State of Pennsylvania.

2. Your petitioner is the owner of a certain piece or parcel of land situate in said Borough of Geistown, in said County and State, bounded and described as follows:

Beginning at a post at a corner of land formerly of Augustine Donate and Anna Donate on the southerly side of Bedford Street in said Borough of Geistown; thence by the line of Bedford Street south sixty-nine degrees fifty minutes ten seconds east two hundred sixteen feet and forty-eight hundredths of a foot to the southwesterly corner of the intersection of Bedford Street and Belmont Street; thence by the westerly line of Belmont Street south eighteen degrees west five hundred twenty-four feet and nine tenths of a foot to a point in said westerly line of Belmont Street at a corner of land of Harry G. Wise & Sons; thence by the line of said land of Harry G. Wise & Sons north seventy-two degrees thirty minutes west three hundred eighty-four feet and thirty-two hundredths of a foot to an iron pin, a corner of said land and in the line of land of St. Joseph's Catholic Cemetery; thence by the line of said Cemetery land north nineteen degrees three minutes forty seconds east four hundred twenty-two feet and nine tenths of a foot to a point on said line at a corner of the above mentioned land formerly of Augustine Donate and Anna Donate; thence by the line of said Donate land south seventy-one degrees twenty-three minutes twenty seconds east one hundred fifty-nine feet and four tenths of a foot to a tack in a plug; thence still by said land last mentioned north eighteen degrees twenty-two minutes forty seconds east one hundred and fifteen feet and three tenths of a foot to the place of beginning. Containing four acres and one hundred eighty-three thousandths of an acre.

3. Bedford Street in the Borough of Geistown aforesaid upon which the real estate above described has frontage, was taken over by the Department of Highways of the Commonwealth of Pennsylvania and made a portion of State Highway Route No. 222, the section whereon the real estate above described has frontage being Section 6 thereof.

4. The Secretary of Highways of the Commonwealth of Pennsylvania, under authority of law, has caused changes in existing lines and location of the highway above referred to as State Highway Route No. 222 to be made at a point on said Highway where the same passed along the above described real estate owned by your petitioner. Such change, insofar as that portion of said Highway Route formerly known as Bedford Street is concerned, makes a change therein whereby said Highway has been converted into a four lane divided highway upon a new location which runs through the petitioner's land from the northwesterly corner thereof to a point on Belmont Street. In addition to the changes made in said highway as above referred to, a new one way highway, known as Ramp "A", has been constructed from said main highway beginning at a point within the land above described owned by the petitioner and extending thence in a southeasterly direction through said land to the line of land above referred to as the property of Harry G. Wise & Sons. The above mentioned changes have taken out of existence all that part of Belmont Street adjoining the above described land of the petitioner. Not only the land comprising the lines of the above highway location, but also all the remaining land of the petitioner fronting on Bedford Street or the old location of Route No. 222 and all of the land of the petitioner fronting on Belmont Street and running from the corner of Harry G. Wise & Sons' land in a northwesterly direction to the southerly line of land now or formerly of Augustine and Anna Donate, has been taken and appropriated by the Department of Highways in connection with the changes in lines and location above referred to. The land so taken constitutes that part of the land of the petitioner which is now Ramp "A" of said Highway and all of his said land lying to the north and east thereof.

x The changes in said Highway so made by the Secretary of Highways have not only taken a large part of the real estate of the petitioner but have caused injury and damage to the residue thereof in various ways.

Prior to the taking above mentioned, there was erected upon that part of the land of the petitioner which fronts upon what was formerly Bedford Street and within a distance of thirty-five feet or thereabouts of said street

a large three-story frame dwelling house where the petitioner and his family resided. The new route of said Highway passed through a portion of said dwelling house, and all of the land underneath and surrounding said dwelling was taken by said Department of Highways rendering it necessary for the Department of Highways either to tear down said building or for the same to be removed from the site occupied by it to another portion of petitioner's land where the same would be free from highway interference. Petitioner, at a large cost and expense, had said dwelling removed to such point on his land where the same would not be interfered with by highway developments, and was compelled to undergo large expenditures in order to have the land surrounding said dwelling house as so removed landscaped and put in form and condition where the same could be utilized.

Also constructed upon the land of the petitioner to the rear or southerly side of the aforesaid dwelling house and near the line of what was formerly Belmont Street, was a building comprising a two-car garage and storage house. There was also a summer house upon said land and another small frame building for storage purposes. All of the three last mentioned buildings were taken by the Department of Highways in connection with its construction above mentioned and torn down and destroyed.

Prior to the taking aforesaid, the petitioner maintained upon his land above described an orchard having a large number of fruit bearing trees. In the removal of said dwelling house, it became necessary to destroy certain of said trees in order that the dwelling house might be passed to its new location and might occupy the same. In addition, a large number of said fruit trees were on the land taken by the Department of Highways and have been destroyed.

→ That part of the Borough of Geistown where petitioner's real estate is located, namely, that part of Bedford Street and that part of Belmont Street upon which the real estate of the petitioner fronted and adjoined, had become a part of the business section of the Borough of Geistown, and said real estate

had become and was in the market and could readily have been sold in suitable parcels for business purposes, all of the frontage on Belmont Street and Bedford Street being suitable for such purposes. Owing to the fact that Bedford Street and Belmont Street no longer exist as public thoroughfares owing to the changes made by the Secretary of Highways as above recited, all value of every part of the remaining real estate of the petitioner for business purposes has been entirely destroyed and lost.

Thus the act of the Secretary of Highways in changing the lines and location of said Highway Route No. 222 and adding thereto a further highway as above described which is known as Ramp "A" on the plans of said Highway as changed, has resulted in the taking of a large part of the real estate of the petitioner at such locations within the body of said real estate as to render the remaining portions of said real estate of little value, and has caused to the petitioner other losses through the expenditures made necessary in the removal of the location of the dwelling house on said real estate and the loss and depreciation to the building itself and its less valuable building location and the deterioration or destruction of portions of said real estate for business purposes, practically eliminating all value therefrom.

5. The Commonwealth of Pennsylvania, under the provisions of the Acts of Assembly in such case made and provided, is required to assume all damages in connection with the aforesaid changes of the existing lines and location of said Highway known as State Highway Route No. 222 and the additional Highway constructed in connection with said Route as hereinabove recited. Your petitioner has been unable to agree with the representatives of the Secretary of Highways upon the amount of damages sustained by him as aforesaid.

6. By the provisions of Article III, Section 303 of the Act of Assembly of the First day of June, 1945, P. L. 1242, it is provided that, if an agreement cannot be made between the owners of property damaged and the Secretary of Highways, said owners or the Commonwealth may present their or its

petition to the Court of Quarter Sessions for the appointment of viewers to ascertain and assess such damage, as well as any benefits accruing to the land of the said owners by reason of the appropriation and taking of the same or a part thereof by the Secretary of Highways in connection with the change in lines and location of State Highway Routes. Said Act further provides that such petition shall be presented within six years from the date of the approval by the Governor of the plan making the change, but not thereafter. The approval of the plan making the change in the present case was dated in the year 1950.

WHEREFORE, your petitioner prays the Court to appoint viewers to ascertain and assess the damages which have been suffered by the property of the petitioner by reason of the acts of the Secretary of Highways as hereinabove recited, as well as any benefits derived therefrom.

And he will ever pray, etc.

Herman H Hoffman

STATE OF PENNSYLVANIA §
 § SS:
COUNTY OF CAMBRIA §

Herman H. Hoffman, being duly sworn according to law, says that he is the petitioner in the above stated matter, and the owner of the property therein referred to and described, and that the matters averred in the foregoing petition are true and correct to the best of his knowledge, information and belief.

Herman H Hoffman

Sworn and subscribed before me
this 14th day of May, 1951.



James J. Rust J of P
JUSTICE OF THE PEACE

My Commission Expires: 1st Mon. Jan. 1956

O R D E R

NOW, the 21st day of May, 1951, the foregoing petition having been read and presented to the Court, the Court do thereupon appoint F. W. Claflin, Robert G. Mayer and Mahlon J. Baumgardner, who are members of the County Board of Viewers, to view the property described in the within petition and to report to the Court their findings with respect to the damages suffered by the petitioner by reason of the appropriation, injury or destruction of certain property in the change of lines and location of State Highway Route No. 222, taking into consideration any benefits which may have accrued to said property by said change of lines and location. It is hereby directed that the above named viewers, in assessing the damages, shall take into consideration the advantages derived from such road passing through the land of the complainant. Said viewers are directed to make their report in writing to the Court of Quarter Session on or before the 1st day of Aug., 1951. The viewers above appointed are hereby directed to give at least ten days' notice in writing to the Secretary of Highways and the petitioner of the day and hour on which they will view the premises within described and conduct their hearing under this appointment.

BY THE COURT:

✓ 

No. *7*

June Sessions, 1951

In the Court of Quarter Sessions of
Cambria County, Pennsylvania.

In the Matter of the Changes in Location
and Lines of a Highway known as State
Highway Route No. 222, in the Borough of
Geistown, in said County and State.

PETITION OF HERMAN H. HOFFMAN FOR THE
APPOINTMENT OF VIEWERS

Filed
5/21/51

/ SHETTIG & SWOPE
ATTORNEYS AT LAW
EBENSBURG, PA.

IN THE COURT OF QUARTER SESSIONS OF CAMBRIA COUNTY, PENNSYLVANIA

In the Matter of the Change in Location and Lines of a Highway Known as State Highway Route No. 222, in the Borough of Geistown, in said County and state.

No. 4 June Sessions, 1951.

PARTIAL REPORT OF VIEWERS AND REQUEST FOR EXTENSION OF TIME FOR FINAL REPORT.

TO THE HONORABLE, THE JUDGES OF THE ABOVE NAMED COURT:

F. W. CLAFLIN, ROBERT G. MAYER and MAHLON J. BAUMGARDNER, members of the County Board of Viewers, who were duly appointed by the Court on May 21st, 1951, to view the property involved and to report to the Court their findings with respect to damages suffered by the Petitioner by reason of the appropriation, injury or destruction of said property respectfully represent:

After giving due notice thereof to the interested parties, the viewers met at the premises involved on the 8th day of June, 1951, at 10:30 o'clock A. M., Daylight Saving Time and viewed the premises fully.

The viewers adjourned to meet at the Judges Chambers in Johnstown on Wednesday, June 20th, 1951, at 1:30 o'clock P. M., Daylight Saving Time, for the purpose of hearing witnesses on the subject of values and damages.

The Department of Highways requested a postponement of said hearing by reason of the illness of the attorney who had been retained by the Department. Since that time no date has appeared to be suitable to all persons concerned, so that the viewers must report to the Court that they have been unable to complete the duties of their appointment.

They therefore pray the Court to continue their appointment as viewers in the above stated matter until such date as to the Court shall seem proper.

Respectfully submitted.

F. W. Claflin

Robert G. Mayer

Mahlon Baumgardner

O R D E R

NOW, August 7th, 1951, the within Partial Report of Viewers having been read and considered, the Court do hereby extend the time for a Final Report by said Viewers to the 17th ^{7th} day of Sept 1951, 1951.

BY THE COURT:

J. M. Egan

~~Road~~ Docket

No. 4 June Sessions, 1951

In the Matter of the Change in Location
and Lines of a Highway known as State High-
way Route No. 222, in the Borough of Geis-
town, in said County and State.

PARTIAL REPORT OF VIEWERS AND REQUEST FOR
EXTENSION OF TIME FOR FINAL REPORT.

Filed
8/7/51

SHETTIG & SWOPE
ATTORNEYS AT LAW
EBENSBURG, PA.

This is a
Copy

In re: Order to view and assess damages in the matter of the changes in location and lines of a highway known as State Highway No. 222, in the Borough of Gettysburg, in said County and State.

In the Court of Quarter Sessions of Cambria County, Pennsylvania.
No. 4 June Sessions, 1951

NOTICE OF VIEW

We, the undersigned Viewers, appointed by the above named Court for the purpose of viewing and assessing damages to property of Norman H. Rafferty in the matter of the changes in location and lines of a highway known as State Highway No. 222, in the Borough of Gettysburg, in said County and State. Beginning at a post at a corner of land formerly of Augustine Donato and Anna Donato on the southerly side of Bedford Street in said Borough of Gettysburg; thence by the line of Bedford Street south sixty-nine degrees fifty minutes ten seconds east two hundred sixteen feet and forty-eight hundredths of a foot to the southwesterly corner of the intersection of Bedford Street and Belmont Street; thence by the westerly line of Belmont Street south eighteen degrees west five hundred twenty-four feet and nine tenths of a foot to a point in said westerly line of Belmont Street at a corner of land of Harry G. Rice & Sons; thence by the line of said land of Harry G. Rice & Sons north seventy-two degrees thirty minutes west three hundred eighty-four feet and thirty-two hundredths of a foot to an iron pin, a corner of said land and in a line of land of St. Joseph's Catholic Cemetery; thence by the line of said Cemetery land north nineteen degrees three minutes forty seconds east four hundred twenty-two feet and nine tenths of a foot to a point on said line at a corner of the above mentioned land formerly of Augustine Donato and Anna Donato; thence by the line of said Donato land north seventy-two degrees twenty-three minutes twenty seconds east one hundred fifty-nine feet and four tenths of a foot to a tack in a flag; thence still by said last mentioned land north eighteen degrees twenty-two minutes forty seconds east one hundred and fifteen feet and three tenths of a foot to the place of beginning. Containing four acres and one hundred eighty-three thousandths of an acre.

The Viewers will meet at the place of beginning on the 8th day of June A. D., 1951, at 10:30 A.M., D.S.T. for the purpose of performing the duties of our appointment at which time and place all interested persons may appear and be heard.

E. T. Clafflin, Chairman
Robert Hoyer
Charles J. Baumgardner

Viewers

May 29, 1951

In re: Order to view and assess
damages in the matter of the changes
in location and lines of a highway
known as State Highway No. 222, in
the Borough of Geistown, in said
County and State.

In the Court of Quarter
Sessions of Cambria County,
Pennsylvania.
No. 4 June Sessions, 1951

REPORT OF VIEWERS

To the Honorable, the Judges of the above named Court, we the undersigned Viewers, appointed by the annexed order of the Court to view and assess damages in the matter of the changes in location and lines of a highway known as State Highway No. 222 in the Borough of Geistown, County of Cambria, and State of Pennsylvania, respectfully report:

That we have been duly sworn or affirmed as members of the Permanent Board of Viewers of Cambria County, as shown by the records of the Court; that having given due public notice of the time and place of meeting, by posting notices as required by law along the route and at the site of property to be viewed, as evidenced by copy of said notice hereto attached and service of such notice on the County Commissioners of Cambria County, the State Highway Department, the Solicitor for the Petitioner, and the Solicitor for the Plaintiff, that we met in accordance with the notice given on the 8th day of June, A. D. 1951 at 10:30 A.M., D.S.T. for the purpose of performing the duties of our appointment and viewed the property.

Notices for a hearing to be held in the Judge's Chambers, U. S. National Bank Building at 1:30 P.M., D.S.T. on Wednesday, June 20, 1951, were sent out. This hearing was postponed due to the fact that Mr. George M. Spence, Attorney for the Highway Commission was in the hospital, therefore notices for a second hearing to be held in the Judge's Chambers, U. S. National Bank Building at 10:00 A.M., D.S.T. Wednesday, August 22, 1951 re the order to view and assess damages in the matter of the changes in location and lines of a highway known as

State Highway No. 222, in the Borough of Geistown, Cambria County, Pennsylvania, were sent out. At this hearing the Plaintiff was represented by Shettig & Swope and five (5) witnesses. The services of Mr. Myers from Ebensburg were obtained to take testimony. At the view and during the hearing, the Viewers based their assessment of damages on the following conditions:

First: Value of land and buildings before the taking. The Viewers also considered the development of the land taken, such as fruit trees, etc.

Second: The cost of moving the dwelling and sheds to a new location.

Third: The value of the dwelling before the taking and after the taking.

Fourth: The value of the land remaining after the taking, and the value of the buildings in their new location.

Fifth: The value of the buildings as relocated and as effected by ingress and egress to the remaining property.

After taking into consideration all the matters above briefed, the Viewers hereby assess total damages to Herman H. Hoffman in the amount of fifty-two thousand two hundred and fifty dollars (\$52,250.00) and the Viewers assess no benefits.

Witness our hands and seals this twenty-ninth day of August, 1951.

J. W. B. Lafflin, Chairman

Robert G. Meyer

William J. B. Arrington
Viewers

Commonwealth of Pennsylvania, }
County of Cambria } SS.

At a Court of Quarter Sessions of the Peace of the County of Cambria held at Ebensburg, in the said County, on the 21st day of May A. D. 1951, before the Honorable Judge of the said Court: Upon the petition of divers inhabitants of the Township of Geistown Boro, in the said County, setting forth that they labor under inconvenience for want of a Assess damages road or highway, to lead from

"See attached description"

and therefore praying the Court to appoint proper persons to view and lay out the same according to law. The Court, upon due consideration had of the premises, do order and appoint F. W. Claflin, Robert G. Mayer surveyor, and Mahlon J. Baumgardner

viewers, to view the ground proposed for said road, and if they view the same, and shall agree that there is occasion for such road, they shall proceed to lay out the same, having respect to the shortest distance and the best ground for a road, and in such manner as shall do the least injury to private property, and also be as far as practicable, agreeable to the desires of the petitioners, and that they make a report of their proceedings to the next Court of Quarter Sessions to be held for said County, stating particularly whether they judge the same necessary for a public or private road, together with a plot or draft thereof, and the courses and distances, and references to the improvements through which it may pass.

By the Court,
McCann, F. J.

Attest:

Joseph C. Wess, Clerk

Order to view In the Matter of
the changes in Location and
Lines of a Highway Known as
State Highway No.222,in the
Borough of Geistown, in said
County and State.

F.W.Claflin
Robert G. Mayer
Mahlon J. Baumgardner
Joseph C. Wess
Clerk

} Viewers

NOTE. "It shall be the duty of all persons appointed in the several counties of this Commonwealth to view and review any public or private road or bridge, if they shall decide in favor of locating said road or bridge, to endeavor to procure from the person or persons over whose land such location may be made releases from all claims for damages that might arise from the opening of such road or the building of such bridge; and in every case where said viewers shall fail to procure such releases, and it shall appear to them that any damages will be sustained, it shall be their duty to assess the damages and make report thereof signed by a majority of their number, and return the same, together with all releases obtained, to the Court of Quarter Sessions, and the damages so assessed shall be conclusive, or may be subject to appeal, review or modification, as may be provided by existing laws in the different counties of this Commonwealth."

"The persons appointed as aforesaid shall view such ground, and if they shall agree that there is occasion for a road, they shall proceed to lay out the same, having respect to the shortest distance, and the best ground for a road, and in such manner as shall do the least injury to private property, and also be, as far as practicable, agreeable to the desire of the petitioners."

"The viewers, as aforesaid, shall make report at the next term of said Court, and in the said report shall state particularly: First, who of them were present at the view, second, whether they were severally sworn or affirmed; third, whether the road desired be necessary for a public or private road; they shall also annex and return to the Court a plot or draft thereof, stating the courses and distances, and noting briefly the improvements through which it may pass; and, whenever practicable, the viewers shall lay out the said roads at an elevation not exceeding five degrees (except at the crowding of ravines and streams), where, by moderate filling and bridging, the declination of the road may be preserved within that limit."

Petition of Herman H. Hofman For Appointment of Viewers.

Your petitioner is the owner of a certain piece or parcel of land situate in said Borough of Geistown, in said County and State, bounded and described as follows:

Beginning at a post at a corner of land formerly of Augustine Donate and Anna Donate on the southerly side of Bedford Street in said Borough of Geistown; thence by the line of Bedford Street south sixty-nine degrees fifty minutes ten seconds east two hundred sixteen feet and forty-eight hundredths of a foot to the southwesterly corner of the intersection of Bedford Street and Belmont Street; thence by the westerly line of Belmont Street south eighteen degrees west five hundred twenty-four feet and nine tenths of a foot to a point in said westerly line of Belmont Street at a corner of land of Harry G. Wise & Sons; thence by the line of said land of Harry G. Wise & Sons north seventy-two degrees thirty minutes west three hundred eighty-four feet and thirty-two hundredths of a foot to an iron pin, a corner of said land and in a line of land of St. Joseph's Catholic Cemetery; thence by the line of said Cemetery land north nineteen degrees three minutes forty seconds east four hundred twenty-two feet and nine tenths of a foot to a point on said line at a corner of the above mentioned land formerly of Augustine Donate and Anna Donate; thence by the line of said Donate land south seventy-one degrees twenty-three minutes twenty seconds east one hundred fifty-nine feet and four tenths of a foot to a tack in a plug; thence still by said land last mentioned north eighteen degrees twenty-two minutes forty seconds east one hundred and fifteen feet and three tenths of a foot to the place of beginning.

Containing four acres and one hundred eighty-three thousandths of an acre.

ORDER OF COURT:

NOW, the 21st day of May, 1951, the foregoing petition having been read and presented to the Court, the Court do thereupon appoint F.W. Claflin, Robert G. Mayer and Mahlon J. Baumgardner, who are members of the County Board of Viewers, to view the property described in the within petition and to report to the Court their findings with respect to the damages suffered by the petitioner by reason of the appropriation, injury or destruction of certain property in the change of lines and location of State Highway Route No. 222, taking into consideration any benefits which may have accrued to said property by said change of lines and location. It is hereby directed that the above named viewers, in assessing the damages, shall take into consideration the advantages derived from such road passing through the land of the complainant. Said viewers are directed to make their report in writing to the Court of Quarter Session on or before the 1st day of August, 1951. The viewers above appointed are hereby directed to give at least ten days' notice in writing to the Secretary of Highways and the petitioner of the day and hour on which they will view the premises within described and conduct their hearing under this appointment.

By the Court
McCann, F.J.

Certified this 23rd day of
May, A.D. 1951.

Joseph C. Wess

Joseph C. Wess
Clerk of Courts.

In re: Order to view and assess
damages in the matter of the changes
in location and lines of a highway
known as State Highway No. 222, in
the Borough of Geistown, in said
County and State.

In the Court of Quarter
Sessions of Cambria County,
Pennsylvania.
No. 4 June Sessions, 1951

NOTICE OF VIEW

We, the undersigned Viewers, appointed by the above named Court for the purpose of viewing and assessing damages to property of Herman H. Hoffman in the matter of the changes in location and lines of a highway known as State Highway No. 222, in the Borough of Geistown, in said County and State. Beginning at a post at a corner of land formerly of Augustine Donate and Anna Donate on the southerly side of Bedford Street in said Borough of Geistown; thence by the line of Bedford Street south sixty-nine degrees fifty minutes ten seconds east two hundred sixteen feet and forty-eight hundredths of a foot to the southwesterly corner of the intersection of Bedford Street and Belmont Street; thence by the westerly line of Belmont Street south eighteen degrees west five hundred twenty-four feet and nine tenths of a foot to a point in said westerly line of Belmont Street at a corner of land of Harry G. Wise & Sons; thence by the line of said land of Harry G. Wise & Sons north seventy-two degrees thirty minutes west three hundred eighty-four feet and thirty-two hundredths of a foot to an iron pin, a corner of said land and in a line of land of St. Joseph's Catholic Cemetery; thence by the line of said Cemetery land north nineteen degrees three minutes forty seconds east four hundred twenty-two feet and nine tenths of a foot to a point on said line at a corner of the abovementioned land formerly of Augustine Donate and Anna Donate; thence by the line of said Donate land south seventy-two degrees twenty-three minutes twenty seconds east one hundred fifty-nine feet and four tenths of a foot to a tack in a plug; thence still by said last mentioned land north eighteen degrees twenty-two minutes forty seconds east one hundred and fifteen feet and three tenths of a foot to the place of beginning. Containing four acres and one hundred eighty-three thousandths of an acre.

The Viewers will meet at the place of beginning on the 8th day of June A. D., 1951, at 10:30 A.M., D. S. T. for the purpose of performing the duties of our appointment at which time and place all interested persons may appear and be heard.

F. W. Claflin, Chairman
Robert Mayer
Mahlon J. Baumgardner

Viewers

May 29, 1951

5/21/51
Served
Manning
Ch. Baumgardner

In re: Order to view and assess damages in the matter of the changes in location and lines of a highway known as State Highway No. 222, in the Borough of Geistown, in said County and State.

In the Court of Quarter Sessions of Cambria County, Pennsylvania.
No. 4 June Sessions, 1951

NOTICE OF VIEW

Be, the undersigned Viewers, appointed by the above named Court for the purpose of viewing and assessing damages to property of Herman F. Hoffman in the matter of the changes in location and lines of a highway known as State Highway No. 222, in the Borough of Geistown, in said County and State. Beginning at a post at a corner of land formerly of Augustine Donate and Anna Donate on the southerly side of Bedford Street in said Borough of Geistown; thence by the line of Bedford Street south sixty-nine degrees fifty minutes ten seconds east two hundred sixteen feet and forty-eight hundredths of a foot to the southwesterly corner of the intersection of Bedford Street and Belmont Street; thence by the westerly line of Belmont Street south eighteen degrees west five hundred twenty-four feet and nine tenths of a foot to a point in said westerly line of Belmont Street at a corner of land of Harry G. Wise and Sons; thence by the line of said land of Harry G. Wise & Sons north seventy-two degrees thirty minutes west three hundred eighty-four feet and thirty-two hundredths of a foot to an iron pin, a corner of said land and in a line of land of St. Joseph's Catholic Cemetery; thence by the line of said Cemetery land north nineteen degrees three minutes forty seconds east four hundred twenty-two feet and nine tenths of a foot to a point on said line at a corner of the above mentioned land formerly of Augustine Donate and Anna Donate; thence by the line of said Donate land south seventy-one degrees twenty-three minutes twenty seconds east one hundred fifty-nine feet and four tenths of a foot to a tack in a plug; thence still by said last mentioned land north eighteen degrees twenty-two minutes forty seconds east one hundred and fifteen feet and three tenths of a foot to the place of beginning. Containing four acres and one hundred eighty-three thousandths of an acre.

The Viewers will meet at the place of beginning on the 6th day of June A. D., 1951, at 10:30 A.M., D.S.T. for the purpose of performing the duties of our appointment at which time and place all interested persons may appear and be heard.

F. W. Claflin, Chairman
Robert Mayer
Eugene J. Baumgardner

W. H. G. S. S. S.

Viewers

May 29, 1951

Please acknowledge receipt of original and return this copy.

F. W. Claflin, Chairman of Viewers

(over)

(C. 100)

May 31, 1951

Mr. F. W. Claflin
Chairman of Viewers

Dear Mr. Claflin:

This will acknowledge receipt of notice of view by yourself as Chairman and Robert Mayer and Mahlon J. Baumgardner in the matter of the view to be held at the property of Herman H. Hoffman in Geistown. This will answer as an acceptance of service on behalf of Mr. Hoffman, whom we represent in this matter.

Very truly,

Shetler & Orop
Attorneys for Herman H. Hoffman

PNS:mc

In re: Order to view and assess
damages in the matter of the changes
in location and lines of a highway
known as State Highway No. 222, in
the Borough of Geistown, in said
County and State.

In the Court of Quarter
Sessions of Cambria County,
Pennsylvania.
No. 4 June Sessions, 1951

TO F. W. CLAFLIN, ROBERT MAYER AND MAELON J. BAUGARDNER

To F. W. Claflin, Dr.

May 25, 1951	Data and preparing notices of view	1 day	\$12.00	
	Stenographer typing notices, stationery, stamps, etc.		2.80	
29	Posting and serving notices of view	1 day	12.00	
	Mileage 10 miles		1.00	
June 6	Making view	1 day	12.00	
	Mileage 10 miles		1.00	
August 22	Hearing Judge's Chambers	1 day	12.00	
	Mileage 5 miles		0.50	
28	Viewer's meeting Gray & Claflin office	1 day	12.00	
29	Making and writing report	1 day	12.00	
	Stenographer typing report		3.20	
September 4	Exhibit of schedules Gray & Claflin office	1 day	12.00	
7	Filing report	1 day	12.00	
	Mileage 40 miles		4.00	\$108.50

To Robert Mayer, Dr.

June 6, 1951	Making view	1 day	12.00	
	Mileage 8 miles		0.80	
August 22	Hearing in Judge's Chambers	1 day	12.00	
	Mileage 6 miles		0.60	
28	Viewers' meeting Gray & Claflin office	1 day	12.00	
	Mileage 6 miles		0.60	
September 4	Exhibit of Schedules Gray & Claflin office	1 day	12.00	
	Mileage 6 miles		0.60	50.60

To Mahlon J. Baumgardner, Dr.

June 6, 1951	Making view	1 day	\$12.00	
	Mileage 42 miles		4.20	
August 22	Hearing Judge's Chambers	1 day	12.00	
	Mileage 36 miles		3.60	
28	Viewers' meeting Gray and Claflin office	1 day	12.00	
	Mileage 36 miles		3.60	
September 4	Exhibit of Schedules Gray and Claflin office	1 day	12.00	
	Mileage 36 miles		3.60	\$ 63.00
TOTAL AMOUNT OF VIEW				\$222.10

I hereby certify that the above bill is an exact duplicate of the bill presented to the Cambria County Commissioners.



F. W. Claflin
Chairman of Board of View

No. 4 June Session 1951

In the Court of Quarter Sessions
of Cambria County, Pennsylvania.

In the Matter of the Changes in
Location and Lines of a Highway
known as State Highway Route
No. 222, in the Borough of
Geistown, in said County and
State.

Viewers Report

Filed
9-5-51

*Sept 26-1951
Report Viewers
Accepted -
Mark C. Curren
McKenzie
Yung*

*Thomas, Carl, Mayor & Clerk
906 Geistown Lane, Geistown, Pa.
Geistown, Pa.*

43,560
 75 1026,
 43,560.00
 21,280
 43,560
 -63,840
 43,560
 30
 -13,068,000

43,560
 50
 -21,78000
 10,500
 75X15-D

This print is made from sheet No. 12, of right-of-way
 plan for Route No. 222. Section No. 6. *Cambria*
 County, approved by the Governor on JUNE 1, 1950
 which I we have examined and had explained to me us this
 day of _____, 19____, and is to be attached to
 the release herewith executed.

Witness _____ (Seal)
 Witness _____ (Seal)
 Witness _____ (Seal)

Sheet #3

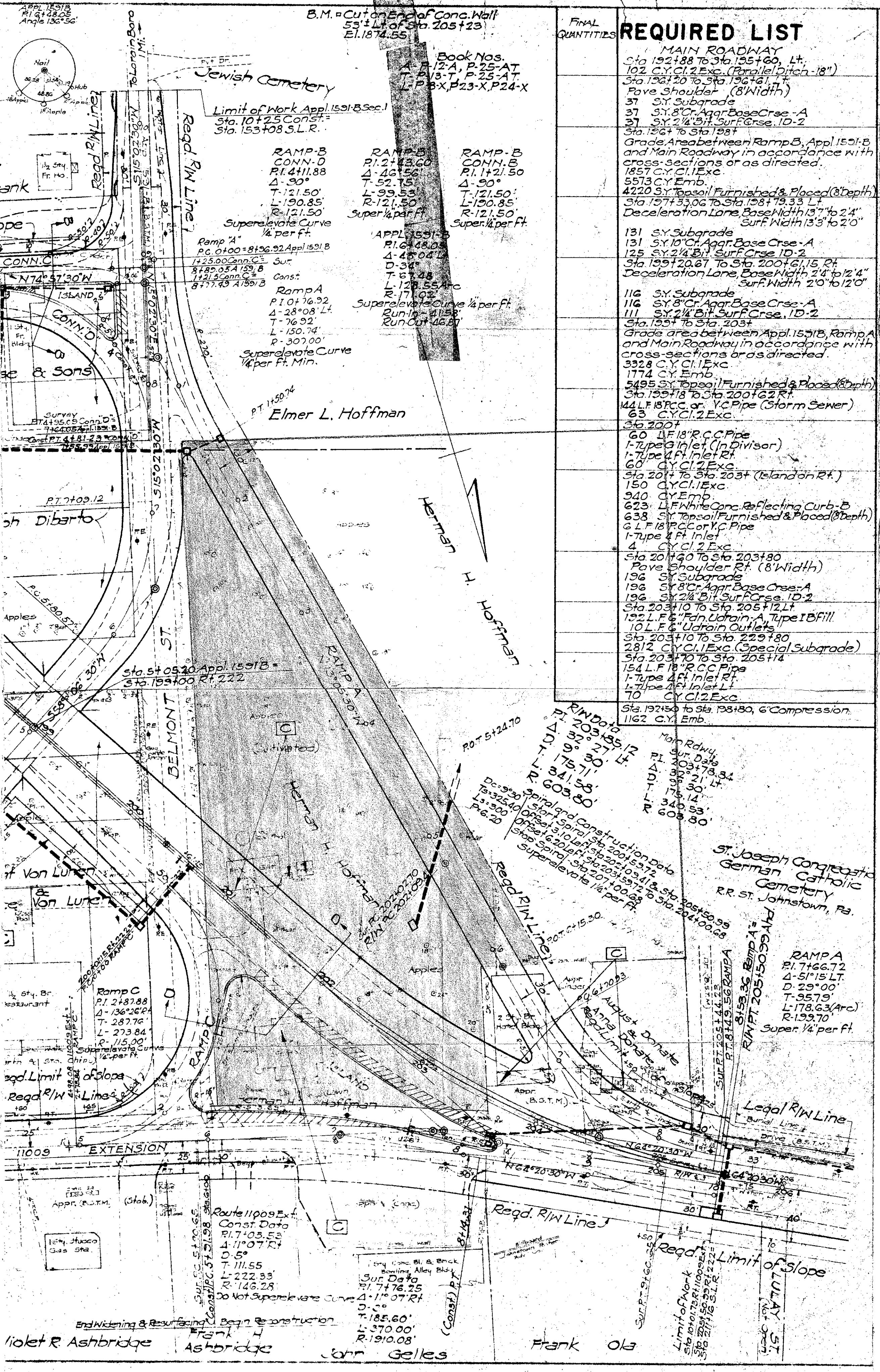

FINAL QUANTITIES	REQUIRED LIST
	MAIN ROADWAY
	Sta 192+88 To Sta 195+60, Lt.
	102 C.Y. C.I. 2 Exc. (Parallel Ditch - 18")
	Sta 196+20 To Sta 196+61, Lt.
	Pave Shoulder (8' Width)
	37 S.Y. Subgrade
	37 S.Y. 8" Cr. Aggr. Base Crse - A
	37 S.Y. 2 1/4" Bit. Surf. Crse. 1D-2
	Sta 196+ To Sta 198+
	Grade Area between Ramp B, Appl 1591-B and Main Roadway in accordance with cross-sections or as directed.
	1857 C.Y. C.I. 1 Exc.
	5573 C.Y. Emb.
	4220 S.Y. Topsoil Furnished & Placed (8" depth)
	Sta 197+33.06 To Sta 198+79.33 Lt.
	Deceleration Lane, Base Width 13' to 24"
	Surf. Width 13' to 20"
	131 S.Y. Subgrade
	131 S.Y. 10" Cr. Aggr. Base Crse - A
	125 S.Y. 2 1/4" Bit. Surf. Crse 1D-2
	Sta 199+20.67 To Sta 200+61.15 Rt.
	Deceleration Lane, Base Width 24' to 12' 4"
	Surf. Width 20' to 12' 0"
	116 S.Y. Subgrade
	116 S.Y. 8" Cr. Aggr. Base Crse - A
	111 S.Y. 2 1/4" Bit. Surf. Crse. 1D-2
	Sta 199+ To Sta 203+
	Grade area between Appl 1591-B, Ramp A and Main Roadway in accordance with cross-sections or as directed.
	3328 C.Y. C.I. 1 Exc.
	1774 C.Y. Emb.
	5495 S.Y. Topsoil Furnished & Placed (8" depth)
	Sta 199+18 To Sta 200+62 Rt.
	144 L.F. 18" P.C. or V.C. Pipe (Storm Sewer)
	63 C.Y. C.I. 2 Exc.
	Sta 200+
	60 L.F. 18" R.C.C. Pipe
	1-Type 4 Inlet (In Divisor)
	1-Type 4 Ft. Inlet Rt.
	60 C.Y. C.I. 2 Exc.
	Sta 201+ To Sta 203+ (Island on Rt.)
	150 C.Y. C.I. 1 Exc.
	940 C.Y. Emb.
	623 L.F. White Conc. Reflecting Curb - B
	638 S.Y. Topsoil Furnished & Placed (8" depth)
	6 L.F. 18" P.C. or V.C. Pipe
	1-Type 4 Ft. Inlet
	4 C.Y. C.I. 2 Exc.
	Sta 201+60 To Sta 203+80
	Pave Shoulder Rt. (8' Width)
	196 S.Y. Subgrade
	196 S.Y. 8" Cr. Aggr. Base Crse - A
	196 S.Y. 2 1/4" Bit. Surf. Crse. 1D-2
	Sta 203+10 To Sta 205+12 Lt.
	192 L.F. 6" Fdn. Udrain - A, Type 1B Fill
	10 L.F. 6" Udrain Outlets
	Sta 203+10 To Sta 229+80
	2812 C.Y. C.I. 1 Exc. (Special Subgrade)
	Sta 203+10 To Sta 205+14
	154 L.F. 18" R.C.C. Pipe
	1-Type 4 Ft. Inlet Rt.
	1-Type 4 Ft. Inlet Lt.
	70 C.Y. C.I. 2 Exc.
	Sta 192+50 To Sta 198+80, 6" Compression
	1162 C.Y. Emb.

Violet R. Ashbridge Ashbridge John Gelles Frank Old