

• -A RESOLUTION TO ABANDON PORTIONS OF ROADS IN BARR TWP.

May 7 1951

WHEREAS: The hereinafter described portions of Penna. State Highways in Barr Township Cambria County, have, by relocation, been abandoned as part of the States Highways System.

These portions on Route 11045 :

1. From station 1 to station 9 .
2. From station 49 to station 67 .
3. From station 87 to station 96.
4. From station 160 to station 175 .
5. From station 183 to station 194.

Also these portions on Route 11046:

1. From station 22 to station 29.
2. From station 40 to 51.

WHEREAS: The above described portions of State Highways, abandoned by the relocation of parts of the routes were reverted to Barr Townships Road System.

WHEREAS: These portions as described herein and by the enclosed drawings, are of no use to the public as a means of transportation. Therefore the Supervisors of Barr Township Road District, at their monthly meeting of May 6, 1951, resolved that the afore described portions of roads in Barr Township reverted to the District by the State be abandoned as part of Barr Township's Road Syatem.

Alphonse Kirsch Supervisor
Orlando Mastrom Supervisor
H. J. Kirsch Supervisor

Attest

M. J. Shank
Secretary

No. 2 June Session 1951

Filed
5/9/51

April, _____ 1951

We, the undersigned, consent that the portion of STATE HIGHWAY, in Barr Township Cambria County, from Station one(1) to Station nine(9); abandoned by relocating route 11045, be also abandoned as part of Barr Township Road System.

Name

Thomas L. Williams

Address

Barnaborts Pa

Date

Date _____ 1951.

We, the undersigned consent, that the portion of STATE HIGHWAY, in Barr Township Cambria County, from Station forty-nine(49) to Station SIXTY SEVEN (67), abandoned by relocating route 11045, be also abandoned as part of Barr Township Road System.

Name

Jonny Amador

Address

Nicktown

Date

4/19/57

Date _____ 1951

We, the undersigned, consent that the portion of STATE HIGHWAY, in Barr Township Cambria County, from Station eighty-seven (87) to Station ninety-six (96), abandoned by relocating route 11045, be also abandoned as part of Barr Township's Road System.

Name

Address

Date

Grisegina Venturini *Mickleton*

april 10 1967

4
Date _____ 1951

We, the undersigned, consent that the portion of STATE HIGHWAY in Barr Township Cambria County, from Station one hundred and sixty(160) to Station one hundred seventy-five(175); abandoned by relocating route 11045, be also abandoned as part of Barr Township's Road System.

Name *Peter Lieb*
Annie D Lieb

Address *Springer Pa. R.R.*
Springer Pa. R.R.

1951
Date *Apr. 9*
" "
" "

Date _____ 1951

We, the undersigned, consent that the portion of STATE HIGHWAY in Barr Township Cambria County, from Station one hundred eighty-three (183) to Station one hundred ninety-four (194); abandoned by relocationg route 11045, be also abandoned as part of Barr Township's Road System.

Name	Address	Date
Peter Grieb	Spangler Pa. M.H	1951
Anne & Grieb	Spangler Rte. 129	" "
James Wieland	Nicktown Pa	" 19

7 6
Date _____ 1951

We, the undersigned, consent that the portion of STATE HIGHWAY in Barr Township Cambria County, from Station twenty-two (22) to Station twenty-nine (29); abandoned by relocating route 11046, be also abandoned as part of Barr Township's Road System.

Name

Address

Date

Mr. George Majoria

R.D. Spangler,

April 9-1951

Date _____ 1951.

We, the undersigned, consent that the portion of STATE HIGHWAY in Barr Township Cambria County, from Station forty (40) to Station fifty (50); abandoned by relocating route 11046, be also abandoned as part of Barr Township's Road System.

Name

Address

Date

Arthur Lieb	Spangler P.O. Pa	4/11/51
Gerald J. Keiser	Spangler Pa. P.O.	4/11/51
Andrew Letomich	" " "	"

DRAWING SHOWING
THE ABANDONED & RELOCATED
PORTION OF
ROUTE 11045 SECTION 2
BARR TOWNSHIP
CAMBERIA COUNTY District 9
Scale 1" = 600'

Plan Approved by the Governor
Dec. 16, 1947

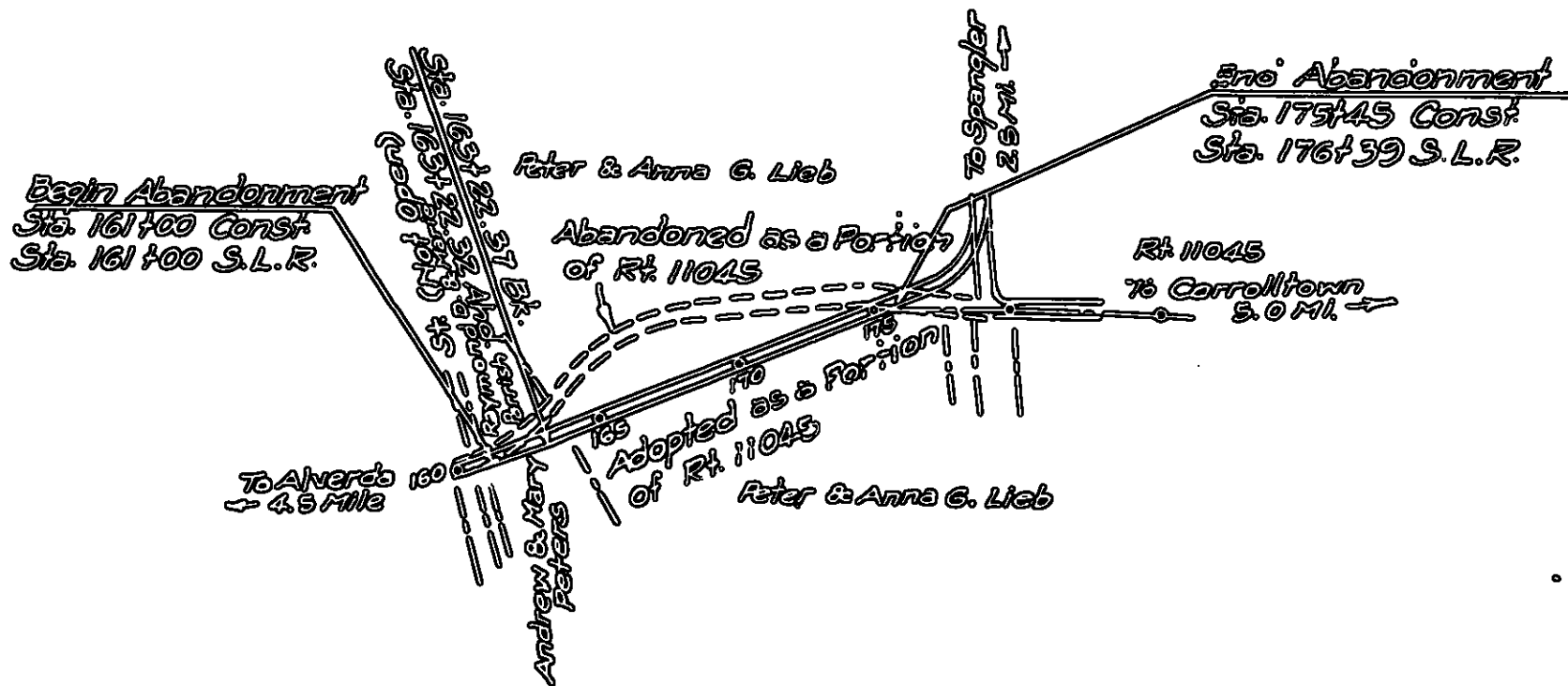

TABULATION OF CHANGE BY RELOCATION												
STATIONS	RELOCATION						ABANDONMENT					
	Improved		Unimproved		Total		Improved		Unimproved		Total	
	Ft.	Mi.	Ft.	Mi.	Ft.	Mi.	Ft.	Mi.	Ft.	Mi.	Ft.	Mi.
161+00 - 175+45 Const.	144503	0.2737			144503	0.2737						
161+00 - 176+39 S.L.R.							1539	0.2915			1539	0.2915

DRAWING SHOWING
ABANDONED & RELOCATED PORTION
of
Route 11045 Section 4
BARR TOWNSHIP CAMBRIA COUNTY
District 9
Scale: 1 = 100'

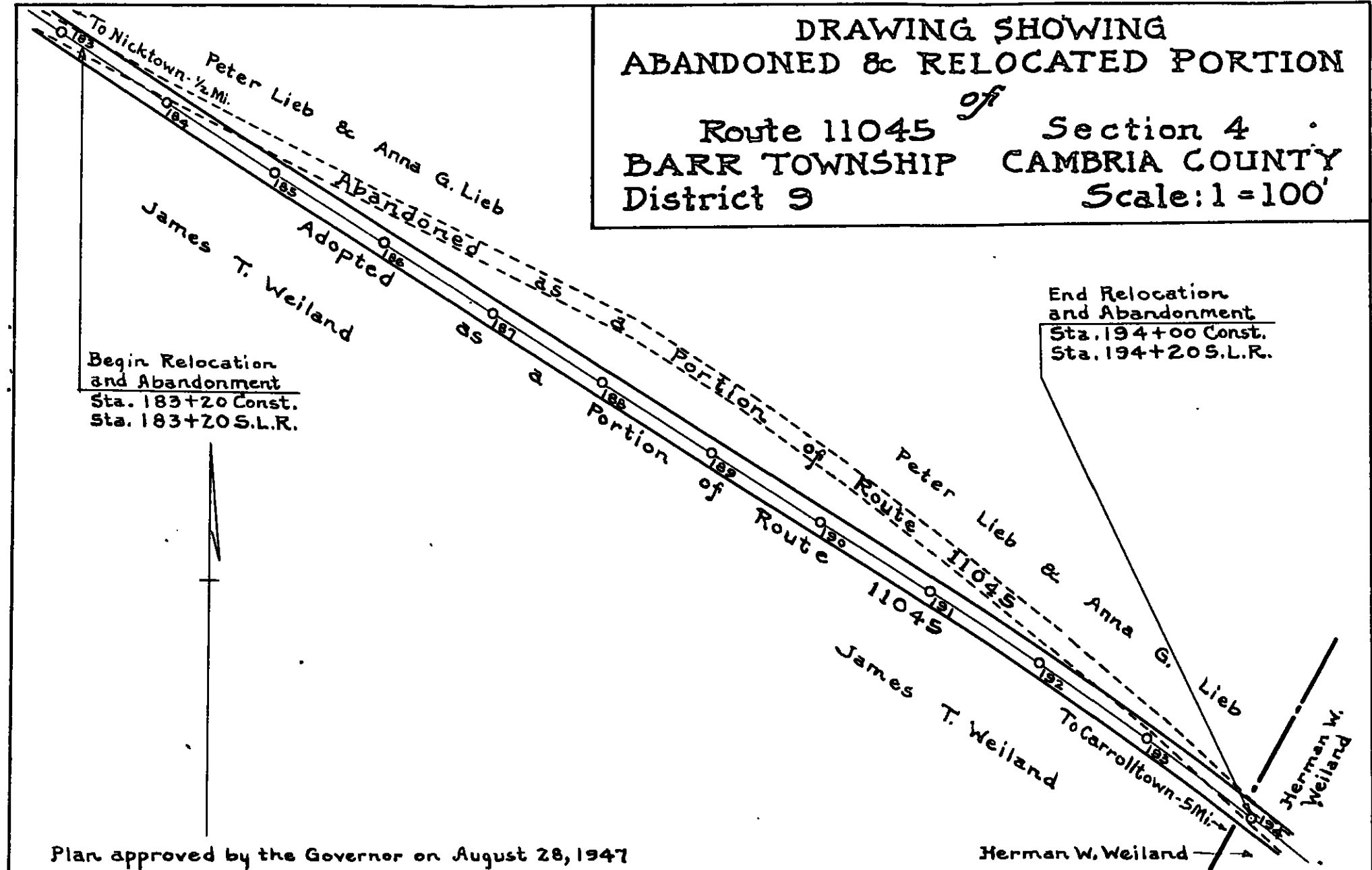

TABULATION OF CHANGES BY RELOCATION

Stations	Relocated						Abandoned					
	Improved		Unimproved		Total		Improved		Unimproved		Total	
	Ft.	Mi.	Ft.	Mi.	Ft.	Mi.	Ft.	Mi.	Ft.	Mi.	Ft.	Mi.
183+20-194+00 Const.	1,080	0.2045			1,080	0.2045						
183+20-194+20 S.L.R.							1,100	0.2083			1,100	0.2083

DRAWING SHOWING
THE ABANDONED & RELOCATED
PORTION OF
ROUTE 11046 SECTION 1
BARR TOWNSHIP
CAMBRIA COUNTY District 9
Scale 1" = 600'

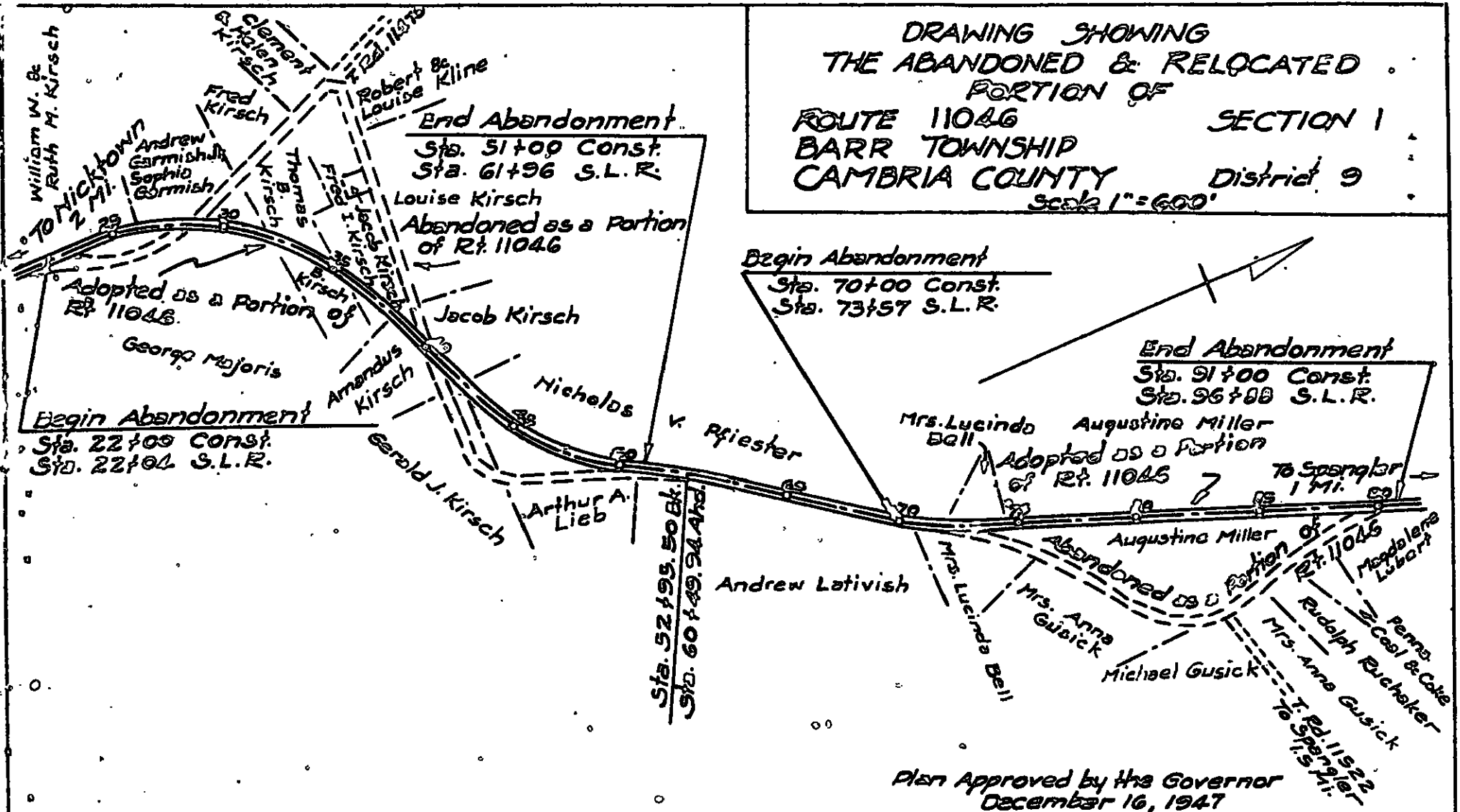

TABULATION OF CHANGES BY RELOCATION

STATIONS	RELOCATION						ABANDONED					
	Improved		Unimproved		Total		Improved		Unimproved		Total	
	Ft.	Mi.	Ft.	Mi.	Ft.	Mi.	Ft.	Mi.	Ft.	Mi.	Ft.	Mi.
22+00 - 51+00 Const.	2900	0.5493			2900	0.5493						
22+04 - 61+96 S.L.R.							3992	0.7560			3992	0.7560
70+00 - 91+00 Const.	2100	0.3977			2100	0.3977						
73+57 - 96+88 S.L.R.							2331	0.4415			2331	0.4415
Total	5000	0.9470			5000	0.9470	6323	1.1975			6323	1.1975

Ed # 2 June 1951
Rat Microfilmed

DRAWING SHOWING
THE ABANDONED & RELOCATED
PORTIONS OF
ROUTE 11045 SEC. 3
BARR TWP. CAMBRIA CO.
DISTRICT 9
SCALE 1"=100'

PLAN APPROVED BY THE
GOVERNOR AUGUST 8, 1946



TABULATION OF CHANGES BY RELOCATION												
STATIONS	RELOCATION						ABANDONED					
	Improved		Unimproved		Total		Improved		Unimproved		Total	
	Ft.	Mi.	Ft.	Mi.	Ft.	Mi.	Ft.	Mi.	Ft.	Mi.	Ft.	Mi.
1+00 to 9+00 Const.	800	0.1515			800	0.1515						
1+00 to 9+45 S.L.R.							845	0.1600			845	0.1600
49+00 to 67+00 Const.	1800	0.3409			1800	0.3409						
49+49 to 67+81 S.L.R.							1832	0.3470			1832	0.3470
87+00 to 96+00 Const.	900	0.1705			900	0.1705						
87+77 to 99+62 S.L.R.							1185	0.2244			1185	0.2244
Total	3500	0.6629			3500	0.6629	3862	0.7314			3862	0.7314