

Rat Mischafilmad

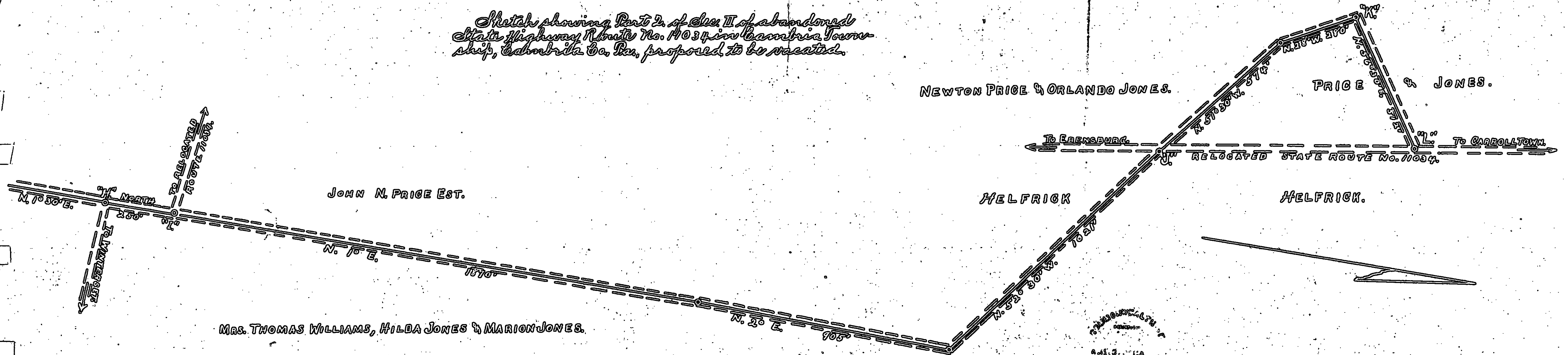

Sketch showing Part 2. of Sec. II of abandoned State Highway Route No. 14034 in Cambria Township, Cambria Co., Pa., proposed to be vacated.

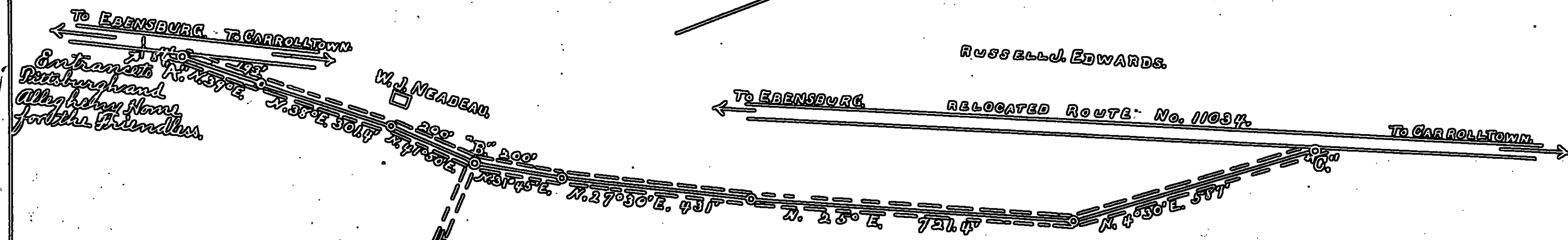

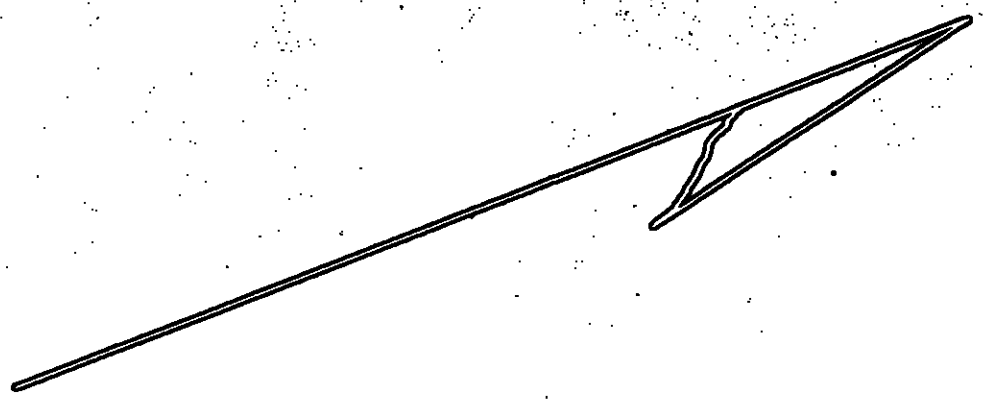

Viewed upon an order of the Court of Quarter Sessions of Cambria County entered to No. 4. Dec. Term, 1944.

Sketch showing Sec. I of abandoned State Highway Route No. 11034 in Cambria Township, Cambria Co., Pa.; petitioned to be vacated.
O. M. Shoemaker, Mahlon Baumgardner, Theodore Hunt, Viewers.

Not Microfilmed

DRAWING SHOWING ABANDONED & RELOCATED PORTIONS
 OF
 ROUTE 11034 SEC.1
 EBENSBURG BORO, CAMBRIA TWP CAMBRIA CO.
 SCALE: 1"=600'

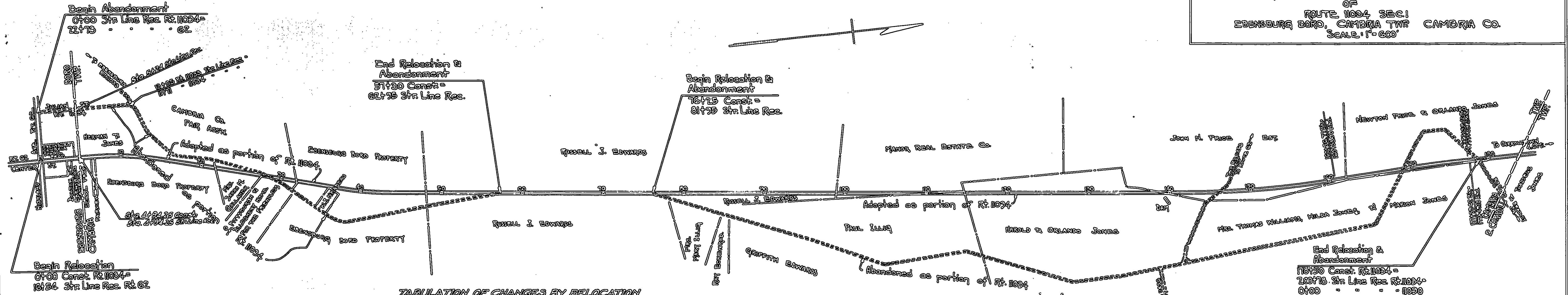

TABULATION OF CHANGES BY RELOCATION

Stationing	RELOCATED			ABANDONED			TWP
	Imp.	Unimp.	Total	Imp.	Unimp.	Total	
0+00 to 2+00+73	5210	5210	10420	5210	5210	10420	Cambria
0+00 to 5+21	5210	5210	10420	5210	5210	10420	Cambria
5+21 to 10+23	5210	5210	10420	5210	5210	10420	Cambria
10+23 to 15+25	5210	5210	10420	5210	5210	10420	Cambria
15+25 to 20+27	5210	5210	10420	5210	5210	10420	Cambria
20+27 to 25+29	5210	5210	10420	5210	5210	10420	Cambria
25+29 to 30+31	5210	5210	10420	5210	5210	10420	Cambria
30+31 to 35+33	5210	5210	10420	5210	5210	10420	Cambria
35+33 to 40+35	5210	5210	10420	5210	5210	10420	Cambria
40+35 to 45+37	5210	5210	10420	5210	5210	10420	Cambria
45+37 to 50+39	5210	5210	10420	5210	5210	10420	Cambria
50+39 to 55+41	5210	5210	10420	5210	5210	10420	Cambria
55+41 to 60+43	5210	5210	10420	5210	5210	10420	Cambria
60+43 to 65+45	5210	5210	10420	5210	5210	10420	Cambria
65+45 to 70+47	5210	5210	10420	5210	5210	10420	Cambria
70+47 to 75+49	5210	5210	10420	5210	5210	10420	Cambria
75+49 to 80+51	5210	5210	10420	5210	5210	10420	Cambria
80+51 to 85+53	5210	5210	10420	5210	5210	10420	Cambria
85+53 to 90+55	5210	5210	10420	5210	5210	10420	Cambria
90+55 to 95+57	5210	5210	10420	5210	5210	10420	Cambria
95+57 to 100+59	5210	5210	10420	5210	5210	10420	Cambria
100+59 to 105+61	5210	5210	10420	5210	5210	10420	Cambria
105+61 to 110+63	5210	5210	10420	5210	5210	10420	Cambria
110+63 to 115+65	5210	5210	10420	5210	5210	10420	Cambria
115+65 to 120+67	5210	5210	10420	5210	5210	10420	Cambria
120+67 to 125+69	5210	5210	10420	5210	5210	10420	Cambria
125+69 to 130+71	5210	5210	10420	5210	5210	10420	Cambria
130+71 to 135+73	5210	5210	10420	5210	5210	10420	Cambria
135+73 to 140+75	5210	5210	10420	5210	5210	10420	Cambria
140+75 to 145+77	5210	5210	10420	5210	5210	10420	Cambria
145+77 to 150+79	5210	5210	10420	5210	5210	10420	Cambria
150+79 to 155+81	5210	5210	10420	5210	5210	10420	Cambria
155+81 to 160+83	5210	5210	10420	5210	5210	10420	Cambria
160+83 to 165+85	5210	5210	10420	5210	5210	10420	Cambria
165+85 to 170+87	5210	5210	10420	5210	5210	10420	Cambria
170+87 to 175+89	5210	5210	10420	5210	5210	10420	Cambria
175+89 to 180+91	5210	5210	10420	5210	5210	10420	Cambria
180+91 to 185+93	5210	5210	10420	5210	5210	10420	Cambria
185+93 to 190+95	5210	5210	10420	5210	5210	10420	Cambria
190+95 to 195+97	5210	5210	10420	5210	5210	10420	Cambria
195+97 to 200+99	5210	5210	10420	5210	5210	10420	Cambria
200+99 to 205+101	5210	5210	10420	5210	5210	10420	Cambria
205+101 to 210+103	5210	5210	10420	5210	5210	10420	Cambria
210+103 to 215+105	5210	5210	10420	5210	5210	10420	Cambria
215+105 to 220+107	5210	5210	10420	5210	5210	10420	Cambria
220+107 to 225+109	5210	5210	10420	5210	5210	10420	Cambria
225+109 to 230+111	5210	5210	10420	5210	5210	10420	Cambria
230+111 to 235+113	5210	5210	10420	5210	5210	10420	Cambria
235+113 to 240+115	5210	5210	10420	5210	5210	10420	Cambria
240+115 to 245+117	5210	5210	10420	5210	5210	10420	Cambria
245+117 to 250+119	5210	5210	10420	5210	5210	10420	Cambria
250+119 to 255+121	5210	5210	10420	5210	5210	10420	Cambria
255+121 to 260+123	5210	5210	10420	5210	5210	10420	Cambria
260+123 to 265+125	5210	5210	10420	5210	5210	10420	Cambria
265+125 to 270+127	5210	5210	10420	5210	5210	10420	Cambria
270+127 to 275+129	5210	5210	10420	5210	5210	10420	Cambria
275+129 to 280+131	5210	5210	10420	5210	5210	10420	Cambria
280+131 to 285+133	5210	5210	10420	5210	5210	10420	Cambria
285+133 to 290+135	5210	5210	10420	5210	5210	10420	Cambria
290+135 to 295+137	5210	5210	10420	5210	5210	10420	Cambria
295+137 to 300+139	5210	5210	10420	5210	5210	10420	Cambria
300+139 to 305+141	5210	5210	10420	5210	5210	10420	Cambria
305+141 to 310+143	5210	5210	10420	5210	5210	10420	Cambria
310+143 to 315+145	5210	5210	10420	5210	5210	10420	Cambria
315+145 to 320+147	5210	5210	10420	5210	5210	10420	Cambria
320+147 to 325+149	5210	5210	10420	5210	5210	10420	Cambria
325+149 to 330+151	5210	5210	10420	5210	5210	10420	Cambria
330+151 to 335+153	5210	5210	10420	5210	5210	10420	Cambria
335+153 to 340+155	5210	5210	10420	5210	5210	10420	Cambria
340+155 to 345+157	5210	5210	10420	5210	5210	10420	Cambria
345+157 to 350+159	5210	5210	10420	5210	5210	10420	Cambria
350+159 to 355+161	5210	5210	10420	5210	5210	10420	Cambria
355+161 to 360+163	5210	5210	10420	5210	5210	10420	Cambria
360+163 to 365+165	5210	5210	10420	5210	5210	10420	Cambria
365+165 to 370+167	5210	5210	10420	5210	5210	10420	Cambria
370+167 to 375+169	5210	5210	10420	5210	5210	10420	Cambria
375+169 to 380+171	5210	5210	10420	5210	5210	10420	Cambria
380+171 to 385+173	5210	5210	10420	5210	5210	10420	Cambria
385+173 to 390+175	5210	5210	10420	5210	5210	10420	Cambria
390+175 to 395+177	5210	5210	10420	5210	5210	10420	Cambria
395+177 to 400+179	5210	5210	10420	5210	5210	10420	Cambria
400+179 to 405+181	5210	5210	10420	5210	5210	10420	Cambria
405+181 to 410+183	5210	5210	10420	5210	5210	10420	Cambria
410+183 to 415+185	5210	5210	10420	5210	5210	10420	Cambria
415+185 to 420+187	5210	5210	10420	5210	5210	10420	Cambria
420+187 to 425+189	5210	5210	10420	5210	5210	10420	Cambria
425+189 to 430+191	5210	5210	10420	5210	5210	10420	Cambria
430+191 to 435+193	5210	5210	10420	5210	5210	10420	Cambria
435+193 to 440+195	5210	5210	10420	5210	5210	10420	Cambria
440+195 to 445+197	5210	5210	10420	5210	5210	10420	Cambria
445+197 to 450+199	5210	5210	10420	5210	5210	10420	Cambria
450+199 to 455+201	5210	5210	10420	5210	5210	10420	Cambria
455+201 to 460+203	5210	5210	10420	5210	5210	10420	Cambria
460+203 to 465+205	5210	5210	10420	5210	5210	10420	Cambria
465+205 to 470+207	5210	5210	10420	5210	5210	10420	Cambria
470+207 to 475+209	5210	5210	10420	5210	5210	10420	Cambria
475+209 to 480+211	5210	5210	10420	5210	5210	10420	Cambria
480+211 to 485+213	5210	5210	10420	5210	5210	10420	Cambria
485+213 to 490+215	5210	5210	10420	5210	5210	10420	Cambria
490+215 to 495+217	5210	5210	10420	5210	5210	10420	Cambria
495+217 to 500+219	5210	5210	10420	5210	5210	10420	Cambria
500+219 to 505+221	5210	5210	10420	5210	5210	10420	Cambria
505+221 to 510+223	5210	5210	10420	5210	5210	10420	Cambria
510+223 to 515+225	5210	5210	10420	5210	5210	10420	Cambria
515+225 to 520+227	5210	5210	10420	5210	5210	10420	Cambria
520+227 to 525+229	5210	5210	10420	5210	5210	10420	Cambria
525+229 to 530+231	5210	5210	10420	5210	5210	10420	Cambria
530+231 to 535+233	5210	5210	10420	5210	5210	10420	Cambria
535+233 to 540+235	5210	5210	10420	5210	5210	10420	Cambria
540+235 to 545+237	5210	5210	10420	5210	5210	10420	Cambria
545+237 to 550+239	5210	5210	10420	5210	5210	10420	Cambria
550+239 to 555+241	5210	5210	10420	5210	5210	10420	Cambria
555+241 to 560+243	5210	5210	10420	5210	5210	10420	Cambria
560+243 to 565+245	5210	5210	10420	5210	5210	10420	Cambria
565+245 to 570+247	5210	5210	10420	5210	5210	10420	Cambria
570+247 to 575+249	5210	5210	10420	5210	5210	10420	Cambria
575+249 to 580+251	5210	5210	10420	5210	5210	10420	Cambria
580+251 to 585+253	5210	5210	10420	5210	5210	10420	Cambria
585+253 to 590+255	5210	5210	10420	5210	5210	10420	Cambria
590+255 to 595+257	5210	5210	10420	5210	5210	10420	Cambria
595+257 to 600+259	5210	5210	10420	5210	5210	10420	Cambria
600+259 to 605+261	5210	5210	10420	5210	5210	10420	Cambria
605+261 to 610+263	5210	5210	10420	5210	5210	10420	Cambria
610+263 to 615+265	5210	5210	10420	5210	5210	10420	Cambria
615+265 to 620+267	5210	5210	10420	5210	5210	10420	Cambria
620+267 to 625+269	5210	5210	10420	5210	5210	10420	Cambria
625+269 to 630+271	5210	5210	10420	5210	5210	10420	Cambria
630+271 to 635+273	5210	5210	10420	5210	5210	10420	Cambria
635+273 to 640+275	5210	5210	10420	5210	5210	10420	Cambria
640+275 to 645+277	5210	5210	10420	5210	5210	10420	Cambria
645+277 to 650+279	5210	5210	10420	5210	5210	10420	Cambria
650+279 to 655+281	5210	5210	10420	5210	5210	10420	Cambria
655+281 to 660+283	5210	5210	10420	5210	5210	10420	Cambria</

Rai #4 Dec. 1942
Rat Microfilmed

Sketch showing Part 1. of Sec. II of abandoned
State Highway Route No. 11034, in Cambria Town-
ship, Cambria Co., Pa., proposed to be vacated.

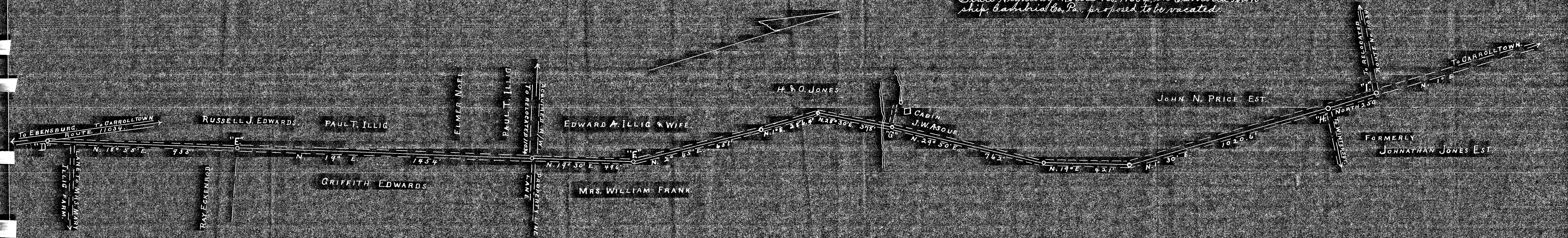

NOTE. "It shall be the duty of all persons appointed in the several counties of this Commonwealth to view and review any public or private road or bridge, if they shall decide in favor of locating said road or bridge, to endeavor to procure from the person or persons over whose land such location may be made releases from all claims for damages that might arise from the opening of such road or the building of such bridge; and in every case where said viewers shall fail to procure such releases, and it shall appear to them that any damages will be sustained, it shall be their duty to assess the damages and make report thereof signed by a majority of their number, and return the same, together with all releases obtained, to the Court of Quarter Sessions, and the damages so assessed shall be conclusive, or may be subject to appeal, review or modification, as may be provided by existing laws in the different counties of this Commonwealth."

"The persons appointed as aforesaid shall view such ground, and if they shall agree that there is occasion for a road, they shall proceed to lay out the same, having respect to the shortest distance, and the best ground for a road, and in such manner as shall do the least injury to private property, and also be, as far as practicable, agreeable to the desire of the petitioners."

"The viewers, as aforesaid, shall make report at the next term of said Court, and in the said report shall state particularly: First, who of them were present at the view, second, whether they were severally sworn or affirmed; third, whether the road desired be necessary for a public or private road; they shall also annex and return to the Court a plot or draft thereof, stating the courses and distances, and noting briefly the improvements through which it may pass; and, whenever practicable, the viewers shall lay out the said roads at an elevation not exceeding five degrees (except at the crossing of ravines and streams), where, by moderate filling and bridging, the declination of the road may be preserved within that limit."

granted

NO. 4, Dec. 4, 1941, SESSIONS, 1941

Order to view and vacate a portion

of public road in Cambria Twp.,

Cambria County, Penna.

AND

REPORT OF VIEWERS.

*Filed as of
March 7th 1942*

A. M. Shoemaker

Mahlon Baumgardner

Theodore Hunt

Clerk Joseph C. Hess 90 cts.

copy to A.M.D.

*Approved this
of March 1942*

*By the Court
Gifford J.*

Commonwealth of Pennsylvania, }
County of Cambria. } SS.

At a Court of Quarter Sessions of the Peace of the County of Cambria held at Ebensburg, in the said County, on the 12th day of January A. D. 1922, before the Honorable Judge of the said Court: Upon the petition of divers inhabitants of the Township of Cambria, in the said County, setting forth that they labor under inconvenience for want of ~~xxxx~~ vacating a portion of road or highway, to lead from All that portion of State Highway Route No. 11034, beginning at a point near the entrance to the Pittsburgh and Allegheny Home for the Friendless; and thence continuing in a Northerly direction to the Cambria Township East Carroll Township line, as shown on the dotted lines on the Blue Print, which is filed in this office.

This is a petition of the citizens of Cambria Township, who want this portion of road vacated.

and therefore praying the Court to appoint proper persons to view and ~~xxxxxx~~ vacate the same according to law. The Court, upon due consideration had of the premises, do order and appoint

A. M. Shoemaker, Mahlom Baumgardner

surveyor, and

Theodore Hunt

viewers, to view the ground proposed for said road, and if they agree that there is occasion for such ~~xxxx~~ vacating they shall proceed to lay-out the same, having respect to the shortest distance and the best ground for a road, and in such manner as shall do the least injury to private property, and also be as far as practicable, agreeable to the desires of the petitioners, and that they make a report of their proceedings to the next Court of Quarter Sessions to be held for said County, stating particularly whether they judge the same necessary for ~~xxxxxx~~ vacating, together with a plot or draft thereof, and the courses and distances, and references the improvements through which it may pass.

By the Court.
Griffith, Judge

Attest:

Joseph C. Wesser

Clerk.

REPORT OF VIEWERS..

To the Honorable, the Judges of the Court of Quarter Sessions of Cambria County, Pennsylvania.

We, the undersigned members of the Permanent Board of Viewers of Cambria County, appointed by your Honorable Court upon the attached order and therein directed to view and determine as to the propriety of vacating certain portions of public road abandoned by the Department of Highways as parts of State Highway Route No. 11034 after said Route No. 11034 had been relocated, respectfully report:

That having given due and legal notice of the view and of the time and place of meeting of the viewers to the Commissioners of Cambria County and the Supervisors of the Township of Cambria, and having had them accept service of notices hereto attached, and to the traveling public by printed hand bills posted in public and conspicuous places at and near the termini and along the route of the portions of public road desired to be vacated: All of us met at the time and place appointed and as specified on the notices served and posted as aforesaid and having gone over and carefully viewed the portions of abandoned highway indicated on the above referred to order of the Court and are each of the following opinion, viz:

That the whole of the first section of abandoned highway beginning at a point at or near the entrance to the Pittsburgh and Allegheny Home for the Friendless-indicated on the attached draft as "A" and the point indicated as "C", should be vacated as a public road; but that the portion thereof between points "A" & "B" should be left open as a private road for the use and convenience of W. J. Neadeau and the representatives and employees of the Borough of Ebensburg.

That the whole of the second section of the abandoned highway Route No. 11034 between "D" and "L" on the attached draft should be vacated as a public road; except that portion between

points indicated on attached draft between "E" and "F".

That the portions between "D" and "E", between "F" and "G" and between "I" and "J" should be left open as private roads for the use and accommodation of the respective property owners abutting these particular sections of road.

Said two sections of abandoned State Highway Route No. 11034 recently turned back to the Supervisors of Cambria Township, as township roads take the following courses and distances, as are more clearly indicated on the draft which is hereto attached and made a part of this report - The first section beginning at "A" and extending N 39 E 193' N 38 E 301.4' N 48 50' E 200' N 31 45' E 200' N 27 30' E 431' N 25 E 721.4' N 4 30' E 587' to "C".

The second section beginning at "D" and extending as follows N. 18 55' E 935' N 19 E. 1454' N 19 30' E 496' N 2 45' E 651' N 1 E 286.4' N 28 30' E 378' N 29 50' E 762' N 19 E. 421' N. 1 30' E 1020.6' N. 250' N 1 E 1870' N 2 E 905' N 52 30' W 1021' N 51 30' W 574' N 28 W 280' and N 56 30' E 512 to "E" at the northerly end of the portion of State Highway Route 11034, in Cambria Township abandoned by reason of the relocation of portions of said State Route 11034.

The viewers desire to recommend that there is urgent need for guard rails near a point immediately northward from point "D" on draft, where the newly located portion of State Highway Route No. 11034 diverges from the abandoned portion of State Route No. 11034, where an approach to the lane leading to the farm of Mrs. Philip Illig has been made along said newly constructed State Highway.

The portion of section two of the above referred to pieces of public road which is herein recommended to be left as a township road between points indicated as "E" and "F" will connect with the newly located Route No. 11034 by a forty foot road to be constructed over a strip of ground acquired by the Township

of Cambria from Paul T. Illig and from Edward A. Illig and Bertha A. Illig, his wife, for the purpose of a more convenient outlet for some five resident property owners living along the portion of road left as a township road.

Witness our hands this 28th day of Feb., A. D., 1942.

A. M. Shoemaker

Mablon Brown

Theodore W. Hunt.

Viewers.

N O T I C E O F V I E W .

Notice is hereby given that the undersigned members of the Permanent Board of Viewers of Cambria County, appointed by the Court of Quarter Sessions of Cambria Co., Pa., to view and determine as to the propriety of vacating certain portions of State Highway Route NO. 11034, in Cambria Township, said county and state, between points of beginning and ending more particularly designated and described as follows, viz:

All those portions of State Highway Route NO. 11034, between a point near the entrance to the Pittsburgh and Allegheny Home for the Friendless, and the line dividing the Townships of Cambria and East Carroll - as shown on Blue Print attached to the petition for the appointment of viewers.

Said Viewers will meet for the purpose of performing the duties of their appointment at the point designated above as at or near the entrance to the Home for the Friendless, in Cambria Township, Cambria County, Pennsylvania, at 9:30 a. m., February 28th., 1942.

A. M. Shoemaker,

M.J. Baumgardner,

Theodore W. Hunt,

Viewers.

Now, February 18th., 1942, service of the above notice is hereby accepted for the Commissioners of Cambria County, Pa.

H. F. Dor...
Clk.

2/18/42

N O T I C E O F V I E W .

Notice is hereby given that the undersigned members of the Permanent Board of Viewers of Cambria County appointed by the Court of Quarter Sessions of Cambria County, Pennsylvania, to view and determine as to the propriety of vacating certain portions of State Highway Route No. 11034, in Cambria Township, between points of beginning and ending more particularly designated and described as follows, viz:

All those portions of State Highway No. 11034 between a point near the entrance to the Pittsburgh and Allegheny Home for the Friendless and the line dividing the Townships of Cambria and East Carroll - as shown on Blue Print attached to the Petition for appointment of Viewers.

Said Viewers will meet at the point designated as at or near the entrance to the above referred to Home for the Friendless, in Cambria Township, Cambria County, Pennsylvania, at 9:30 a. m., February 28th. 1942.

A. M. Shoemaker,
Mahlon J. Baumgardner
Theodore W. Hunt,
Viewers.

Service of the above notice is hereby accepted by the undersigned Supervisors of Cambria Township, Cambria County, Pennsylvania.

E. A. Hlig

Supervisors.

No. 4 December Sessions 1941.

In re View to Vacate portions of Route No. 11034, in Cambria Township, Cambria County, Pa., abandoned by State Highway Department and left as a Township Road.

County of Cambria -

	To A. M. Shoemaker	-	-	-	-	Dr.	
2/13/42	Obtaining datum and preparing Notices of View	-	-	-	-		\$12.00.
	Stenographer and stationery	-	-	-	-		2.00.
2/17/42	Serving and posting Notices of View	-	-	-	-		6.00.
	10 miles at 10¢ per mile	-	-	-	-		1.00.
2/28/42	Viewing road	-	-	-	-		12.00.
	10 miles	-	-	-	-		1.00.
3/5/42	Survey of road 14,535 feet of public road	-	-	-	-		12.00.
3/7-9/42	Plotting and draft	-	-	-	-		12.00.
	3 sets blue prints	-	-	-	-		2.85.
	10 miles	-	-	-	-		1.00.
3/10/42	Preparing Report of Viewers	-	-	-	-		12.00.
	Stenographer and stationery	-	-	-	-		1.75.
							<u>\$75.60.</u>

APR 1 1942 CERTIFIED

	To Mahlon J. Baumgardner,					
2/28/42	Day on View	-	-	-	-	\$12.00.
	10 Miles at 10¢ per mile	-	-	-	-	1.00.
3/5/42	Assisting with survey	-	-	-	-	6.00.
	10 miles	-	-	-	-	1.00.
						<u>\$20.00.</u>

APR 1 1942 CERTIFIED

	To Theodore W. Hunt,					
2/28/42	One day on View	-	-	-	-	\$12.00.
	38 miles at 10 ¢ per mile	-	-	-	-	3.80.
						<u>\$15.80.</u>

APR 1 1942 CERTIFIED

1941
704 Dec. ~~14 1941~~

IN THE COURT OF QUARTER SESSIONS
OF CAMBRIA COUNTY, PENNSYLVANIA

In re Proceedings to
abandon portions of
Old Ebensburg Carrolltown
Road and Cambria Turnp

Filed Jan. 16, 1942

PETITION TO APPOINT VIEWERS

C. RANDOLPH MYERS
ATTORNEY AT LAW
EBENSBURG, PENNSYLVANIA

New Carrolltown, Penna

AND NOW, January 9, 1942, we hereby acknowledge receipt of a copy of the within petition of the appointment of Viewers and waive the issuance of a rule as provided in Rule 301 $\frac{1}{2}$ of the Rules of the Court of the Common Pleas of Cambria County and I hereby agree to the appointment of Viewers as prayed for in said petition.

Commissioners of Cambria County

By

H. F. Dow

Chief Clerk

IN THE COURT OF QUARTER SESSIONS OF CAMBRIA COUNTY, PENNSYLVANIA
TO THE HONORABLE, THE JUDGES OF SAID COUNTY:

The petition of the undersigned citizens and tax payers of the Township of Cambria, in the County of Cambria and State of Pennsylvania, respectfully represents:

That by reason of the improvement of the State Highway between Ebensburg and Carrolltown, and the relocation of a portion thereof, the following described roadway has become useless, inconvenient and burdensome:

All that portion of State Highway Route No. 11034, beginning at a point near the entrance to the Pittsburgh and Allegheny Home for the Friendless; and thence continuing in a Northerly direction to the Cambria Township East Carroll Township line, as shown on the dotted lines on the Blue Print, which is attached hereto and made a part of this Petition.

WHEREFORE your petitioners pray the Court to inquire of and vacate said road and for that purpose to appoint three members of the permanent Board of Viewers of Cambria County to view said road and inquire of the premises and make return of their proceedings according to law.

Lido Lionachini
Supervisor of Cambria Township

Albert Kimmman
Supervisor of Cambria Township

E. A. Derry
Supervisor of Cambria Township

A. R. Roberts

L. J. Oran

Robert J. Yeckley

Chester H. Noel

Harvey Roberts

Gerry Mash

W. R. Radetach

Orvid T. Dickson

Nella Peltar

Seth Stephens

Harry Pouch

James W. Brown

Alice Anderson

John Sunderland

John Mc Caffrey

John Doughlin

State of Pennsylvania :
County of Cambria : ss.

Albert Kinnard, being duly sworn according to law, did depose and say that he is one of the signers of the within petition and that the statements contained therein are true and correct to the best of his knowledge, information and belief.

Albert Kinnard

Sworn and subscribed before

me this 9 day of January,
1942
A. D., 1941.

John L. Hite
Pro.

D E C R E E

And Now, Jan. 12, 1942, 1942, the foregoing petition having been read and considered, it is ordered that A. M. Schumaker, Mahlon Baumgardner and Theodore Hunt, three members of the permanent Board of Viewers of Cambria County, be, and hereby are, appointed to view said road and inquire of the premises and make a return of their proceedings according to law.

By the Court
Ernest J.