

Magnetic 1913
April

DAN'L FELIX.

BERT FELIX.

DAN'L FELIX

— NO. 3 MARCH SESSIONS 1913 —

— VIEWERS —

Enoch James
Geo. K. Spryock
S. E. Dickey.

DAN'L FELIX

CATHOLIC CEMETARY

JOHN RUDDEN

HENRY SCHMIDT

CAMBRIA IRON CO.

ESTHERVILLE OR ELK RUN ROAD
To Johnstown →

— REQUIRED BARRIERS —

ELK RUN ROAD

BARRIER VIEW

— IN —

LOWER YODER TWP, CAMBRIA CO, PA

Scale 1" = 100' April 24th 1913

S. E. Dickey Civil & Mining Eng Johnstown Pa.

— PART NO 2 —

Not Microfilmed

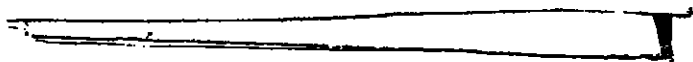

NO. 3 MARCH SESSIONS 1913

VIEWERS

Enoch James
Geo. H. Shryock
J. E. Dickey

REQUIRED BARRIERS

1	76	4 =	761.0'	Well & Gas
5	"	6 =	200.0'	"
8	"	11	673.0'	Guard Rails

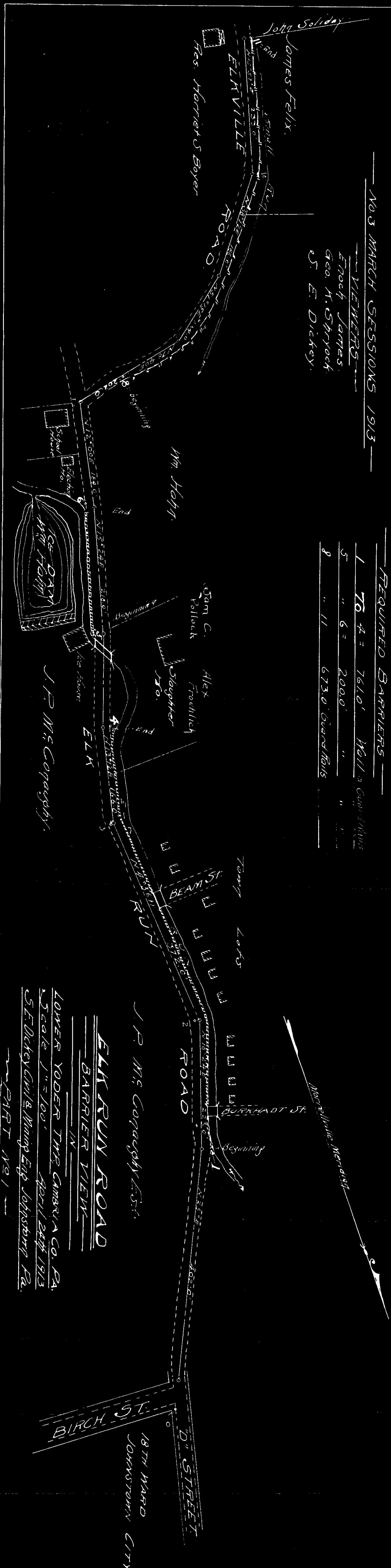

LOWER YODER THE CAMERA CO. PA.
Scale 1" = 100' April 24th 1913
J. E. Dickey Civil & Mining Eng. Johnston, Pa.
PART NO. 1

L. O. #3 Mar. 1913

Rat Microfilmed

Johnstown, Pa., April 26, 1913.

Cambria County.

TO S. E. DICKEY, ENOCH JAMES, & GEO. K. SHRYOCK DR.

For Barrier View of Elk Run Road, Lower Yoder Township, Cambria County, Pennsylvania, as per #3 March Sessions 1913.

TO S. E. DICKEY DR.

April 9	Preparing, signing and posting notices. 1 day		\$5.00
11	Survey of said road. S. E. Dickey. 1 day	\$5.00	
	Chainmen: F. Chapple 1 day	2.00	
	H. Koch 1 day	2.00	9.00
	Mileage for self and chainmen		.30
	Stakes		.30
19	Plotting and tracing survey of said road. 1 day		5.00
	Detail paper and tracing cloth		.25
23	Making view for Barriers. 1 day		5.00
	Mileage		.10
25	Making report of view. 1/2 day		2.50
	Blue prints accompanying report		.30
			<u>\$27.65</u>

TO ENOCH JAMES DR.

April 9	Preparing and signing notices. 1/2 day	\$2.50
23	Making view for Barriers. 1 day	5.00
	Mileage	.10
25	Making report of view. 1/2 day	2.50
		<u>\$10.10</u>

TO GEO. K. SHRYOCK DR.

April 9	Preparing and signing notices. 1/2 day	\$2.50
23	Making view for Barriers. 1 day	5.00
	Mileage	.10
	Making report of view	2.50
		<u>\$10.10</u>

IN RE APPLICATION OF SUPER-
VISORS OF LOWER YODER TOWN-
SHIP FOR GUARD RAILS.

) In the Court of Quarter Sessions of
) Cambria County.
) No. 3. March Term 1913. R. D.

GAMBRIA COUNTY.SS:

Now, 6th June 1913 the within report of Viewers appointed by the Court to determine the necessity of Guard Rails or Barriers as set forth in the Petition, presented to the Grand Jury and after hearing the matter we are of opinion that the erection of the Guard Rails or Barriers is necessary for the protection of the travelling public and that the expense of erecting same is more than is reasonable the Township should bear. We therefore recommend that the County of Cambria erect the said Guard Rails or Barriers as set forth in the Petition and Report of Viewers.

Anderson Stewell
Foreman.

In the Court of Quarter
Sessions.

NO. 3 MARCH TERM 1913.

IN RE APPLICATION OF SUPER-
VISORS OF LOWER VODER TOWNSHIP
FOR GUARD RAILS.

RECOMMENDATION OF GRAND JURY.

Filed 6th June 1913.

*June 12th 1913
the recommendation
approved
by the Court*

DOERR
McK. & McK.

To the Honorable Marlin B. Stephens, President Judge of the court of
Quarter Sessions of Cambria County.

The petition of the undersigned supervisors of Lower Yoder Township/
Cambria County, respectfully represents:

That the Elk Run Road in said township, in certain places herein-
after described, runs along the edge of a precipice, along which it is
necessary that guards or barriers be erected for the proper protection
of the travelling public, and that the erection of said guards or barriers
requires more expense than is reasonable for the township to bear, where-
fore, your petitioners, further showing said road to be a public road, and
the facts aforesaid pray the court to grant a view of the premises as
provided by law.

The following is a description of the points in said road in need
of such protection and asked to be viewed:

Beginning at a point 400 feet from "D" street and Birch Avenue, Johns-
towns, and thence along said Elk Run Road following its courses, a distance
of 1950 feet to the property of Harriet S. Boyer; thence next beginning
at a point at barn of Bert Felix and thence along said road following
its courses a distance of 1250 feet to the Estherville road in said town-
ship.

Henry J. Schmidt
Re. Smith, Jr.
J. L. Boyer
Supervisors.

Cambria County, SS:

Before me the subscriber a Notary Public in and for
said county personally came J. L. Boyer one of the abovesigned super-
visors who being duly sworn according to law deposes and says that the
facts set forth in the foregoing petition are true and correct.

Sworn to and subscribed before me this first day of February, A.D. 1913.

J. L. Boyer
Austin W. Swarts
Notary Public
COMMISSION EXPIRES
FEB. 21, 1915.

No. 3 March Seco 1913
In the Court of Quarter Sessions

In re application
of ~~Highways~~ ^{Highways} of Lower
York Township
for Guard Rails

Sited 12 March 1913

Waco March 1879

Enoch James
Geo K. Thompson
and C. E. B. B.
are appointed
winners
By the Court

Henry

NOTICE OF VIEW

Notice is hereby given that the Viewers appointed by the Court of Quarter Sessions..... to view the Site and determine as to the necessity of erecting guard rails or barriers along the Public Highway in Lower Yoder Township, Cambria County, Pennsylvania. Beginning at a point 400 feet from D Street and Birch Avenue, Johnstown and thence along Elk Run Road a distance of 1950 feet to the property of Harriet S. Boyer; thence next beginning at a point at the barn of Bert Felix, thence along said road 1250 feet to Estherville Road in said Township.

will meet at the place of beginning..... in the Township of Lower Yoder..... aforesaid, on the 23 day of April 1913, at 9 30 o'clock A.M. for the purpose of performing the duties of this appointment.

April 10 1913

Enoch James
Mr. W. Thompson
J. E. Bickney
Viewers.

(over)

Now, April.....1913, Service of within notice is hereby accepted
by the undersigned Commissioners of Cambria County, Pennsylvania.

C. T. Brown

W. F. Anderson

COMMISSIONERS.

To the Court of Quarter Sessions of Cambria County:

The undersigned viewers named in the annexed order, respectfully report:

1,-- That we met at the time and place specified in the notices, to-wit: on the 23d. day of April, 1913, at 9:30 o'clock A.M., at the point of beginning, namely 400 feet from "D" street and Birch Avenue, Johnstown and thence along said road, its various courses and distances as specified in the said order.

2,-- The notices required by law were duly given, that is to say, ten days prior notice in writing to the county commissioners, a copy whereof is hereto attached with acceptance of service thereon, of the time and place at which said viewers should meet to discharge the duties of their appointment, and also notice to the township supervisors of Lower Yoder Township, of which there is likewise a copy hereto attached with service accepted noted thereon, and also notice to the landowners and the public of the time and place of such meeting, by six advertisements put up in the most public places in the vicinity of the ground to be viewed for ten days before the time fixed for holding the said view.

3,-- We were severally sworn or affirmed according to law and before proceeding to discharge our duties.

4,-- We viewed the site and locality of the proposed guard rails or barriers to be erected making a personal inspection of the same between the points designated in the petition and order on the 23d. day of April, 1913 at the hour mentioned.

5,-- We are of the opinion that barrier walls and guard rails along said road are necessary between the following points:

First,-- Beginning at a point 402 feet from the South side of Birch street and thence following the courses and distances of said road a distance of seven hundred sixty one feet to a point in said road.

Second,-- Beginning at Southeast corner of abutment of bridge over run at Hahn's ice-house and thence by said road following its course and distances a distance of two hundred feet to a point in said road.

Third,-- Beginning at a point 93 feet West of the intersection

of roads at public school house, thence by said road following its courses and distances six hundred and seventy three feet to the line of lands, of John Soliday and James Felix opposite residence of Harriet S. Boyer.

According to map or draft accompanying this report and marked map part No.1.

As to the balance of the guards asked for and described in map part No.2 we are of the opinion that assistance is not necessary and that the township should take the necessary steps to care for this portion thereof at its own expense.

6.-- In our opinion the guard rails or barriers recommended by us are of such public necessity as that the township should have assistance in the erection of the same by the county.

Witness our hands this 25th. day of April, 1913.

Conorh James
Geo. H. Smith
J. E. Dickey
Members of the Board of Permanent
Viewers.

NOTICE OF VIEW

Notice is hereby given that the Viewers appointed by the Court of Quarter Sessions.....to view the Site and determine as to the necessity of erecting guard rails or barriers along the Public Highway.....in Lower Yoder Township, Cambria County, Pennsylvania. Begining at a point 400 feet from D. Street and Birch Avenue, Johnstown and thence along Elk Run Road a distance of 1950 feet to the property of Harriet S. Boyer; thence next begining at point at the barn of Bert Felix, thence along said road 1250 feet to Estherville Road in said Township.....

will meet at the place of begining.....in the Township of Lower Yoder.....aforesaid, on the 23 day of April 1913, at 9-30 o'clock A.M. for the purpose of performing the duties of this appointment.

April 10 1913

Ernest James
Geo. W. Thompson
J. E. Dickey
Viewers.

(10000)

Now April ..10th..1913, service of within notice is hereby accepted
by the undersigned Supervisors of the Township of Lower Yoder,
County of Cambria and State of Pennsylvania.

J. J. Beyer.
Harry J. [illegible]
Ben Smith

SUPERVISORS.

COMMONWEALTH OF PENNSYLVANIA ::
COUNTY OF CAMBRIA : SS.

At a Court of Quarter Sessions Of the Peace of the County of Cambria held at Ebensburg in the said County, on the 12th day of March 1913, before the Honorable Judge of the said Court; upon the petition of the undersigned Supervisors of Lower Yoder Township, Cambria County respectfully represents:

That the Elk Run Road in the said Township, in the certain places hereinafter described, runs along the edge of a precipice, along which it is necessary that guard rails or barriers be erected for the proper protection of the travelling public, and that the erection of the said guard rails or barriers requires more or less expense than is reasonable for the township to bear; wherefore your petitioners further showing said road to be a public road, and the facts aforesaid pray the Court to grant a view of the premises as provided by law.

The following is a description of the points in said road in need of such protection and asked to be viewed.

Beginning at a point 400 feet from "D" street Birch Avenue Johnstown, and thence along said Elk Run Road following its courses a distance of 1950 feet to the property of Harriet S. Boyer; thence next beginning at a point at barn of Bert Felix and thence along said road following its courses a distance 1250 feet to the Estherville road in said Township.

Now March 12, 1913, Enoch James, Geo. K. Shryock and J. E. Dickey are appointed Viewers.

BY THE COURT.

ATTEST:

A. D. Kirkhead

CLERK

No 3, March Sessions, 1913

Order to View Elk Run Road in
Lower Yoder Township for
Guar. Rails.

Enock James :

Geo K. Shryock : Viewers

S. E. Dickey :

DOERR

Clerk -----90

No 9. March Term 1913

REPORT

ON VIEW OF ELK RUN ROAD FOR
GUARD RAILS AND BARRIER WALLS.

APRIL 25, 1913.

Enoch James

Geo. W. Shryock } Viewers.

S. R. Dickey }

Filed 6 May 1913
in open court

Certified 1913 C, B, C,

Shryock