

CD #5 Sept 1910  
Not Microfilmed

C. P. Collins, Surveyor  
Valentine Hissell, Miners  
Geo C. Turner

Appointed by Order of Court  
of Quarter Sessions of Cambria Co.  
Pa. Dated Sept 21, 1910.

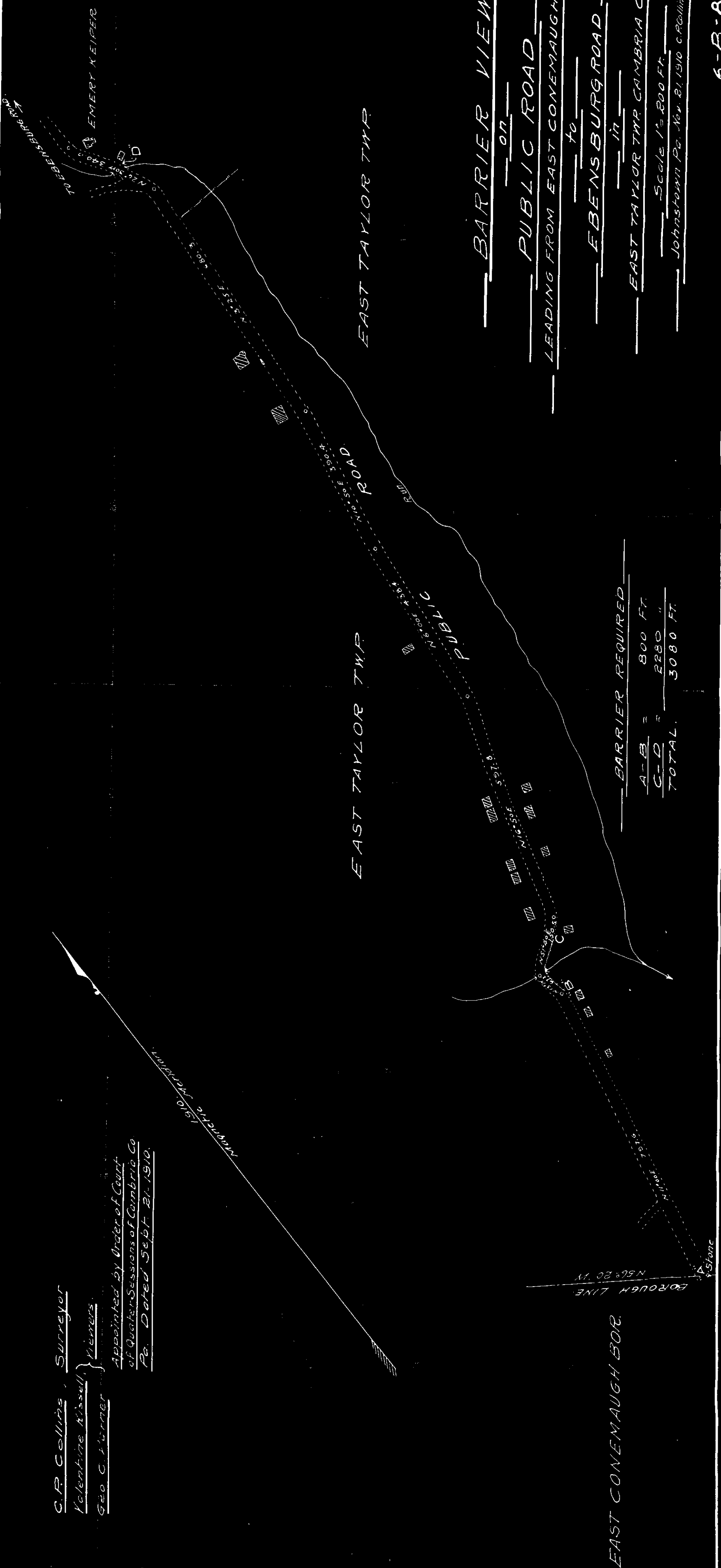

EAST CONEMAUGH BOR.

EAST TAYLOR TWP

EAST TAYLOR TWP

--- BARRIER VIEW ---  
--- on ---  
--- PUBLIC ROAD ---  
--- LEADING FROM EAST CONEMAUGH BOR. ---  
--- to ---  
--- EBENSBURG ROAD ---  
--- in ---  
--- EAST TAYLOR TWP CAMBRIA CO. PA. ---  
--- SCALE 1" = 800 FT. ---  
--- JOHNSTOWN PG. Nov. 21, 1910 C. Collins C.E. ---

6-B-8

In the Court of Quarter Sessions of Cambria County, Penna.

To the Honorable F. J. O'Connor, President Judge of said Court:

The petition of the undersigned supervisors of East Taylor Township, said County, respectfully represent:

That a certain public road or highway beginning at the boundary line of the Borough of East Conemaugh and ending at the public highway leading to Ebensburg, being in said Township of East Taylor throughout, has at its southerly end a dangerous precipice, for which guard rails or barriers should be supplied; that said barriers should, for the safety of the traveling public, be placed from the intersection of the said highway and the Borough line of the Borough of East Conemaugh; thence along the said highway in a northerly direction to the land of Emery Keiper, a distance of four thousand eight hundred and fifty (4850) feet; and that the erection of said guards or barriers requires more expense than is reasonable the Township should bear.

Wherefore your petitioners pray the Court to order a view in the manner provided for in the case of roads to view the premises and determine whether or not such guards or barriers are necessary, and whether or not the same would be too expensive for said Township to erect and maintain; and report to make thereon as provided by the Act of Assembly of May 25, 1878, P. L. 150 and its supplements and amendments.

~~John S. Snyder~~  
~~Emery Keiper~~

<sup>his</sup>  
John S. Snyder  
<sup>mark</sup>  
Emery Keiper  
M. A. Rupelt  
Supervisors.

Cambria County : ss.

Personally appeared before me, the undersigned authority,  
*John S. Snyder*, and  
above named, who being severally affirmed according to law, say the statements therein made are true and correct to the best of their knowledge and belief.  
Witness my hand and Notarial seal, this 3<sup>rd</sup> day of September A.D. 1910.

*Florance M. Gowers*  
Notary Public,  
My commission expires with  
the end of the next session  
of the Senate.

In the Court of Quarter Sessions of Cambria County, Penna.

To the Honorable F. J. O'Connor, President Judge of said Court:

The petition of the undersigned supervisors of East Taylor Township, said County, respectfully represent:

That a certain public road or highway beginning at the boundary line of the Borough of East Conemaugh and ending at the public highway leading to Ebensburg, being in said Township of East Taylor throughout, has at its southerly end a dangerous precipice, for which guard rails or barriers should be supplied; that said barriers should, for the safety of the traveling public, be placed from the intersection of the said highway and the Borough line of the Borough of East Conemaugh; thence along the said highway in a northerly direction to the land of Emery Keiper, a distance of four thousand eight hundred and fifty (4850) feet; and that the erection of said guards or barriers requires more expense than is reasonable the Township should bear.

Wherefore your petitioners pray the Court to order a view in the manner provided for in the case of roads to view the premises and determine whether or not such guards or barriers are necessary, and whether or not the same would be too expensive for said Township to erect and maintain; and report to make thereon as provided by the Act of Assembly of May 25, 1878, P. L. 150 and its supplements and amendments.

*Witness my hand*

*John T. Snyder*  
*Emery Keiper*  
*W. T. Keiper*

Supervisors.

Cambria County : ss.

*John T. Snyder* Personally appeared before me, the undersigned authority, and above named, who being severally affirmed according to law, say the statements therein made are true and correct to the best of their knowledge and belief.

Witness my hand and seal, this 3 day of September, A.D. 1910.

*Henry M. Gorman*  
*Henry M. Gorman*  
*Henry M. Gorman*

To the Commissioners of Cambria County.

Please take notice of the presentation of the within petition at ten o'clock. A.M., Monday, September 19, 1910.

*accepted by T. Keiper*

Nov. 5 September Sess. 1910.

Petition of East  
Taylor Township  
Supervisors for bar-  
riers, beginning at the  
boundary line of Borough  
of East Conemaugh, ending at  
public highway leading to  
Ebensburg.

Filed 21 September, 1910.

Now Sept. 21, 1910 when  
petition was <sup>considered</sup>  
the court appointed  
6 McElerny Valentine  
Kessell & Leo Chassey  
to view said premises  
and report thereon according  
to law.

By the Court

CHARLES C. GREER  
LAWYER

SWANK BUILDING, JOHNSTOWN, PA.

THE LEGAL PUBLISHING COMPANY, ATHENS, PENNA.

To the Honorable, the President Judge of the Court of Quarter Sessions of Cambria County.

We, the undersigned, appointed by the annexed order do report: That pursuant thereof, after having been severally sworn or affirmed, all the Viewers appointed by said order viewed the ground for the within mentioned barriers, and do agree that there is occasion for *a barrier*, as desired by the petitioners, and that the same is necessary ~~for at place as petitioners mentioned~~, and do further report that the expenses incident to the erection and completion of the same are greater than the township could reasonably bear, and therefore recommend that the said barriers-----be erected at the expense of the County. \_\_\_\_\_

\_\_\_\_\_

\_\_\_\_\_

We do further report that notice of the view was given to the Board of Supervisors, ~~and County Commissioners~~ and by advertisement in conspicuous places in the vicinity ten (10) days before said meeting, and we further annex a plot or draft of the road as laid out showing the courses and distances, and noting the improvements on the ground.

*E. P. Collins*

*Valentine Kissel*

*Geob. Varner*

*Trimmer*

Commonwealth of Pennsylvania, }  
County of Cambria. } ss

At a Court of Quarter Sessions of the Peace of the County of Cambria held at Ebensburg, in the said County, on the.....21st.....day of September.....A. D. 1900 , before the Honorable Judge of the said Court: Upon the petition of divers inhabitants of the Township of...East Taylor....., in the said County, setting forth that they labor under inconvenience for want of a.....road or highway, to lead from  
..a certain public road or highway beginning at the boundary line... of the Borough of East Conemaugh and ending at the public highway leading to Ebensburg; being in said Township of East Taylor through out, has at its southerly end a dangerous precipice, for which guard rails or barriers should be supplied; that said barriers should, for the safety of the traveling public, be placed from.... the intersection of the said highway and the Borough line of the Borough of East Conemaugh; thence along the said highway in a..... northerly direction to the land of Emery Keiper, a distance of four thousand eight hundred and fifty (4850) feet; and that the erection of said guards or barriers requires more expense than is reasonable the Township should bear.  
.....Wherefore your petitioners pray the Court to order a view in the manner provided for in the case of roads to view the premises and determine whether or not such guards or barriers are necessary and whether or not the same would be too expensive for said Township to erect and maintain; and report to make thereon as provided by the Act of Assembly of May 25, 1878, P. H. 150 and its supplements and amendments.

and therefore praying the Court to appoint proper persons to view and lay out the same according to law. The Court, upon due consideration had of the premises, do order and appoint  
..C. F. Collins.....surveyor, and.....  
..Valentine Kissell and Geo. C. Vanner.....  
viewers, to view the <sup>road</sup> ground proposed for said <sup>barriers</sup> road; and if they view the same, and shall agree that there is occasion for such <sup>barriers</sup> road, they shall proceed to lay out the same, having respect to the shortest distance and the best <sup>best</sup> ground for a <sup>barriers</sup> road, and in such manner as shall do the least injury to private property, and also be as far as practicable, agreeable to the desires of the petitioners, and that they make a report of their proceedings to the next Court of Quarter Sessions to be held for said County, stating particularly whether they judge the same necessary for a public or private road, together with a plot or draft thereof, and the courses and distances, and references to the improvements through which it may pass.

By the Court.

Attest:

*J. S. Kirkhead*  
....., Clerk.

NOTE. "It shall be the duty of all persons appointed in the several counties of this Commonwealth to view and review any public or private road or bridge, if they shall decide in favor of locating said road or bridge, to endeavor to procure from the person or persons over whose land such location may be made releases from all claims for damages that might arise from the opening of such road or the building of such bridge; and in every case where said viewers shall fail to procure such releases, and it shall appear to them that any damages will be sustained, it shall be their duty to assess the damages and make report thereof signed by a majority of their number, and return the same, together with all releases obtained, to the Court of Quarter Sessions, and the damages so assessed shall be conclusive, or may be subject to appeal, review or modification, as may be provided by existing laws in the different counties of this Commonwealth."

"The persons appointed as aforesaid shall view such ground, and if they shall agree that there is occasion for a road, they shall proceed to lay out the same, having respect to the shortest distance, and the best ground for a road, and in such manner as shall do the least injury to private property, and also be, as far as practicable, agreeable to the desire of the petitioners."

"The viewers, as aforesaid, shall make report at the next term of said Court, and in the said report shall state particularly: First, who of them were present at the view, second, whether they were severally sworn or affirmed; third, whether the road desired be necessary for a public or private road; they shall also annex and return to the Court a plot or draft thereof, stating the courses and distances, and noting briefly the improvements through which it may pass; and, whenever practicable, the viewers shall lay out the said roads at an elevation not exceeding five degrees (except at the crossing of ravines and streams), where, by moderate filling and bridging, the declination of the road may be preserved within that limit."

State of Pennsylvania, :  
County of Cambria, : ss.

Personally appeared before me, the undersigned authority,  
C. P. Collins, Valentine Kissell and George C. Varner, who, having been  
severally duly affirmed according to law, say they will perform their  
duties as viewers in the within named proceedings with zeal and fidel-  
ity.

Affirmed and subscribed before  
me, this 17<sup>th</sup> day of November, A.D.  
1910.

Florence M. Grier,

Notary Public.

My commission expires with  
the end of the next session  
of the Senate.

C. P. Collins  
Valentine Kissell  
Geo C Varner  
Viewers.

NO. 8, Sept. SESSION, 1900.

Order to view and determine  
if barriers are necessary along  
roads in East Taylor Township

Viewers.

C. P. Collins  
Valentine Kissell  
Geo. C. Varner

Clerk Kirkhead 90 cts.  
Grier



# Notice of View.

Notice is hereby given that the undersigned Viewers appointed by the Court of Quarter Sessions of Cambria County, Pa., to No. 5, September Session, 1910, to view and determine if barriers are necessary on a public highway beginning at the boundary line of the Borough of East Conemaugh, and ending at the public highway leading to Ebensburg in the Township of East Tayler, a distance of four thousand eight hundred and fifty (4850) feet to a point at or near the land of Emery Kolpor, will meet for the purpose of their appointment on the said highway at the boundary line of said Borough on the ---17th--- day of November, 1910, at 10 o'clock, A. M., and view said ground.

G. P. Collins,  
Valentine Kiecolt,  
Geo. C. Varner,

Viewers.

*Edward Richard High*  
*J. D. Langer*  
*W. A. Whitsett* Rec  
*Supervisor*

*Received of the Viewers of the Court of Quarter Sessions of Cambria County, Pa., to No. 5, September Session, 1910, the sum of \$10.00 for the purpose of their appointment on the said highway at the boundary line of said Borough on the ---17th--- day of November, 1910, at 10 o'clock, A. M., and view said ground.*

Notice of View.

No. 5, 4th Session, 1910.

To determine if barriers  
are necessary on public  
highway beginning at  
boundary line of East Cone,  
~~and extending to~~ public  
highway leading to ~~existing~~  
near land of Emeric Kiefer.

*[Faint, illegible handwritten notes or signatures]*

*[Faint, illegible handwritten text]*

In re Barrier View.

Bill of Costs.

C. P. Collins - Services as Viewer,	3.00	
Survey,	5.00	
Map,	5.00	
Mileage,	<u>.30</u>	\$13.30
Valentine Kiesel - Services as Viewer,	3.00	
Mileage,	<u>.30</u>	3.30
George C. Varner - Services as Viewer,	3.00	
Mileage,	<u>.30</u>	3.30
Florence M. Govier - Affidavits,		.75

No. 5, Sept. Session 1910,  
In re Barrero view  
in East Taylor Township.

Filed 5 December 1910.

in open court.

June 8/11

The Grand Jury recommend  
that the County build  
the Barrero herein  
mentioned

A. G. Young

We concur in finding <sup>for</sup> ~~that~~ <sup>the</sup> ~~Grand Jury~~ <sup>Grand Jury</sup> and approve  
the ~~actual~~ <sup>actual</sup> ~~findings~~ <sup>findings</sup> ~~thereon~~ <sup>thereon</sup>  
Chas. C. Gre~~ene~~ <sup>att'y.</sup>

9/7/11 - cert.  
444