

KNOW ALL MEN BY THESE PRESENTS, that we Jacob J. Leiden, and Philip Keebler are held and firmly bound unto the Commissioners of Cambria County, in the State of Pennsylvania, their successors and assigns in the sum of fifty dollars to be paid to the said Commissioners, or their certain attorney, successors or assigns, to which payment well and truly to be made and done we do bind ourselves, our heirs, executors, and administrators, and every of them, jointly and severally, firmly by these presents.

Whereas a petition of inhabitants and citizens of the Township of Chest, in said County of Cambria, has been presented to the Court of Quarter Sessions of said County of Cambria praying for the appointment of viewers to lay out a public road to lead from the Blacksmith shop of John G. Gill on the main road through the Village of St. Lawrence, in said Township of Chest, to the St. Lawrence School House on the road leading from the Village of St. Lawrence to the Borough of Patton, in said County.

NOW THE CONDITION OF THIS OBLIGATION IS SUCH, that if the said Jacob J. Leiden and Philip Keebler shall pay all fees and costs of said viewers into the County treasury of said County of Cambria, if said Court by order shall direct them so to do, then this obligation to be void and of none effect; otherwise to be and remain in full force and virtue.

Witness our hands and seals this First day of June, 1908.

Sealed and delivered

in presence of

M. S. Kittell

§
S
E
A
L
S

Jacob J. Leiden (SEAL)

Philip Keebler (SEAL)

IN DISCHARGE OF

Joseph J. [Signature] (SEAL)

June 1908

APRIL

IN THE CITY

IN DISCHARGE OF

IN THE CITY

No. 2 June Sessions 1908

In the matter of the
petition of citizens of Chest
Township for appointment of
viewers to lay out a road from
the Blacksmith shop of John G.
Gill to the St. Lawrence School
House.

Filed June 1908
Bond of petitioners.

To the Supervisors of the Township of Chest ,in the County of Cambria, Pennsylvania.

You are hereby notified that a petition of the citizens of the Township of Chest, in said County, will be presented to the Court of Quarter Sessions of Cambria County on Monday the First day of June, 1908, praying for the appointment of viewers to lay out a public road to lead from the Blacksmith shop of John G. Gill on the main road through the Village of St. Lawrence, in said Township of Chest, to the St. Lawrence School House on the road leading from the Village of St. Lawrence to the Borough of Patton, in said County.

W. L. Pittell

Attorney for Petitioners.

We hereby accept service of the above notice.

James G. Gill

Frank F. Palmer

Harry Wentz

To the Honorable F.J.O'Connor, President Judge of the Court
of Quarter Sessions, of the Peace in and for said County of
Cambria :

The petition of the undersigned citizens of the
Township of Chest, in said County, respectfully sheweth:

That your petitioners labor under great inconveniences for want
of a public road, to lead from the blacksmith shop of John G. Gill
on the main road through the Village of St. Lawrence, in said Town-
ship of Chest, to the St. Lawrence School House on the road lead-
ing from the Village of St. Lawrence to the Borough of Patton, in
said County.

Your petitioners therefore pray the Court to appoint
proper persons to view and lay out the same according to law;
and they will ever pray, &c.

Jacob J. Leiden
Philip Keebler
Lawrence Kuyper
A. M. Dietrich
Albin Gill
Joseph Bros
H. C. Albright
Max Gill
John G. Gill
William Brown
A. J. Gill
George Warner
Chas. L. Kuyper
Chas. F. Gill
George R. Kline

Kearney & Gill
Michael Miller
Wm Kline
John Kline
Michael Rimer
Joseph Rimer
Michael Rimer
Michael Drees
R. J. Kline
George Wood
+ Barton Drees
William Lanchart
John H. Lanchart
Michael Kuyper

Edmund J. J. J.
John Kutz
William Kutz
Jerry Hill
Gustave Boas
Simon Pfeiffer
J. J. J. J.
Frank Kibler
F. M. Krauer
J. J. J. J.
Charles Warner
Lewis Deiterich
John Deiterich
J. J. J. J.
J. J. J. J.
Harry W. J.
J. J. J. J.
Philip Gill
Charles J. J.
Joseph J. J.
Frank + Warner
Daniel J. J.
J. J. J. J.
Oskar Warner
J. J. J. J.
Michael Ropp Jr.
J. J. J. J.
Johann J. J.
J. J. J. J.

Cambria County, ss.

Jacob J. Leiden being duly sworn according to law
says that the matters set forth in the foregoing petition are
true and correct, as he verily believes.

Sworn and subscribed before me
this 27th day of May 1908.

Philip N. Shettig

Notary Public
My Commission Expires January 16th, 1909.

Jacob J. Leiden

No. 2 June Sessions, 1908.

Petition of citizens of Chest
Township for appointment of
viewers to lay out a road from
the Blacksmith shop of John
G. Gill to the St. Lawrence
School House.

And now, June 1st, 1908, the
within petition read, and the
Court appoint John L. Elder Jr.
Chas Rhody and E. A.
Milton viewers.

B. J. C. C.

Filed 1 June, 1908.

Kittell.

TO THE HONORABLE FRANCIS J. O'CONNOR, PRESIDENT JUDGE OF THE COURT OF
QUARTER SESSIONS OF CAMBRIA COUNTY, PENNSYLVANIA.

The undersigned, appointed by the annexed order, viewers to view the ground proposed for a public road or highway to lead from the blacksmith shop of John G. Gill on the main road through the Village of St. Lawrence, in the Township of Chest, to the St. Lawrence School house on the road leading from the Village of St. Lawrence to the Borough of Patton, also in said township of Chest, do respectfully report: That having first given due and legal notice of the time and place of the view to the County Commissioners of Cambria County and to the supervisors of the Township of Chest, as shown by copies of said notice with acceptance of service thereon hereto attached, and having posted copies of said notice in the vicinity of said proposed road, they were all present at the view of the ground proposed for such road, and having all been first severally sworn to perform their duties as viewers impartially and according to the best of their judgment, they did, in pursuance of said order, view the ground proposed for said public road, and finding the same necessary for a public road, do return for public use the following road, to wit: Beginning at the Blacksmith shop of John G. Gill on the main road through the Village of St. Lawrence, in the Township of Chest, and extending thence through land of said John G. Gill, land of Elizabeth Leiden and land of Elizabeth Kronauer, North eighty-five degrees thirty minutes West sixteen hundred and eighty-nine feet to a point at land of Charles Kibler, and thence through land of Charles Kibler, Elizabeth Kronauer, Jacob Warner, and Anselm Dietrick South six degrees West fourteen hundred and sixty-four feet to the St. Lawrence school house on the road leading from the Village of St. Lawrence to the Borough of Patton. A plot or draft whereof is hereunto affixed, in which said draft are set out the courses and distances, and the buildings and improvements near, through and along which the road passes. Which said road so as aforesaid laid out

we are of opinion is necessary for a public road.

Respectfully submitted,

Cost of View
John R Elder, Jr. 2 days 10.00
 mileage 2.00
 Order .90
Chas. Rhody, 1 day 3.00
 mileage .60
Ed. A Mellon, 1 day 3.00
 mileage .60

John R. Elder, Jr.
Chas. Rhody
Ed. A. Mellon.
Viewers.

State of Pennsylvania)
County of Cambria) (SS:

Before me a Justice of the Peace in and for said County and State personally came John L. Elder, Jr., Chas. Rhody and Ed. A. Mellon, who each being by me duly sworn according to law says that as a viewer in the matter of a proposed road to lead from the blacksmith shop of John G. Gill on the main road through the Village of St. Lawrence in the Township of Chest to the St. Lawrence school house on the road leading from the Village of St. Lawrence to the Borough of Patton in said County he will perform his duties as a viewer impartially according to the best of his judgment.

Sworn and subscribed before me
this 24 day of August, 1908.

John G. Gill

My Commission Expires First
Monday of May, 1912

John L. Elder, Jr.
Chas. Rhody
Ed. A. Mellon

Meridian

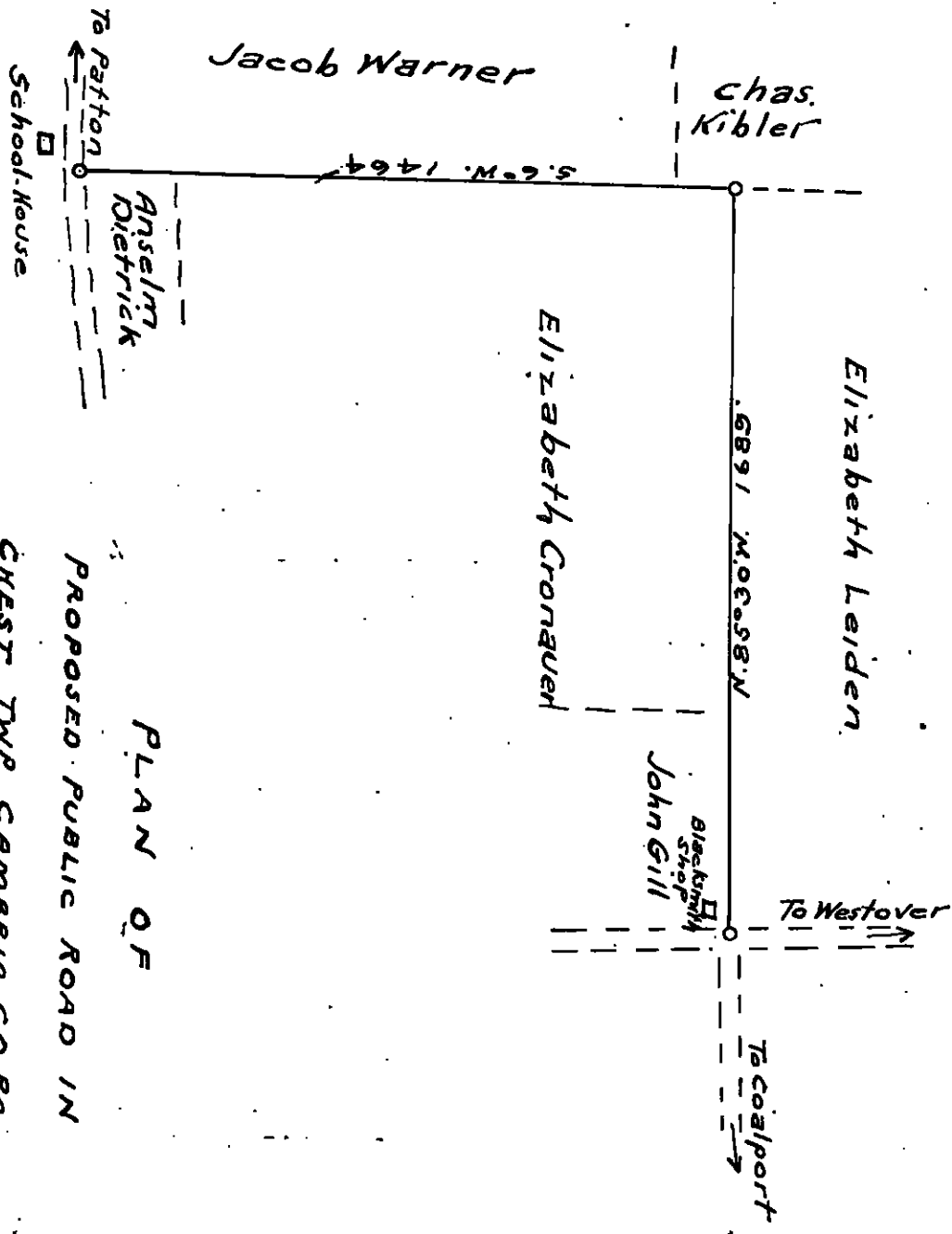

PLAN OF

PROPOSED PUBLIC ROAD IN

CHEST TWP. CAMBRIN CO. PA.

Scale: 1"=400. Viewed Aug. 25, 1908.

John L. Elder, Jr.
Chas. Rhody
Ed. R. Mellon.
Viewers.

ROAD NOTICE.

Notice is hereby given that the— viewers appointed by the Court of Quarter Sessions of Cambria County, Pennsylvania, to—view the ground for a proposed road to lead from the blacksmith shop of John G. Gill on the main road through the Village of St. Lawrence, in said Township of Chest,

to the St. Lawrence School House on the road leading from the Village of St. Lawrence to the Borough of Patton, in said County,

will meet at blacksmith shop of John G. Gill in the Township of Chest aforesaid, on the 25th day of August, 1908, at ten o'clock A.M. for the purpose of performing the duties of their appointment.

John L. Elder, Jr.

Chas. Rhody.

Ed. A. Mellon.

August 10th 1908

Viewers.

Service of nothing notice accepted.

Barney Wenz
Frank & Schubert
James J. Gill

} Supervisors
Check Township

ROAD NOTICE.

Notice is hereby given that the — viewers appointed by the Court of Quarter Sessions of Cambria County, Pennsylvania, to — view the ground for a proposed road to lead from — the — blacksmith shop of John G. Gill on the main road through the Village of St. Lawrence, in said Township of Chest —

to the St. Lawrence School House on the road leading from the Village of St. Lawrence to the Borough of Patton, in said County —

will meet at the blacksmith shop of said John G. Gill — in the Township of — Chest — aforesaid, on the — 25th — day of — August —, 1908 —, at — ten — o'clock — A.M. — for the purpose of performing the duties of their appointment.

John L. Elder, Jr.

Chas. Rhody.

Ed. A. Mellon.

August 10th —, 1908 —

Viewers.

Service accepted August 10th 1906.

J. P. Dehman
Committee Clerk

Commonwealth of Pennsylvania, }
County of Cambria.

At a Court of Quarter Sessions of the Peace of the County of Cambria held at Ebensburg, in the said County, on the 1st day of JANU. A. D. 1908, before the Honorable Judge of the said Court: Upon the petition of divers inhabitants of the Township of Lehigh,

in the said County, setting forth that they labor under inconvenience for want of a public road or highway, to lead from the blacksmith shop of John S. Gill on the main road through the Village of St. Lawrence, in said Township of Lehigh, to the St. Lawrence School House on the road leading from the Village of St. Lawrence to the Borough of Patton, in said County,

and therefore praying the Court to appoint proper persons to view and lay out the same according to law. The Court, upon due consideration had of the premises, do order and appoint

Jno. L. Elder, Jr. surveyor, and
Lehas Rhoads and Ed. A. Mellon

viewers, to view the ground proposed for said road, and if they view the same, and shall agree that there is occasion for such road, they shall proceed to lay out the same, having respect to the shortest distance and the best ground for a road, and in such manner as shall do the least injury to private property, and also be as far as practicable, agreeable to the desires of the petitioners, and that they make a report of their proceedings to the next Court of Quarter Sessions to be held for said County, stating particularly whether they judge the same necessary for a public or private road, together with a plot or draft thereof, and the courses and distances, and references to the improvements through which it may pass.

By the Court.

Attest:

S. S. Lindeaf, Clerk.

NOTE. "It shall be the duty of all persons appointed in the several counties of this Commonwealth to view and review any public or private road or bridge, if they shall decide in favor of locating said road or bridge, to endeavor to procure from the person or persons over whose land such location may be made releases from all claims for damages that might arise from the opening of such road or the building of such bridge; and in every case where said viewers shall fail to procure such releases, and it shall appear to them that any damages will be sustained, it shall be their duty to assess the damages and make report thereof signed by a majority of their number, and return the same, together with all releases obtained, to the Court of Quarter Sessions, and the damages so assessed shall be conclusive, or may be subject to appeal, review or modification, as may be provided by existing laws in the different counties of this Commonwealth."

"The persons appointed as aforesaid shall view such ground, and if they shall agree that there is occasion for a road, they shall proceed to lay out the same, having respect to the shortest distance, and the best ground for a road, and in such manner as shall do the least injury to private property, and also be, as far as practicable, agreeable to the desire of the petitioners."

"The viewers, as aforesaid, shall make report at the next term of said Court, and in the said report shall state particularly: First, who of them were present at the view, second, whether they were severally sworn or affirmed; third, whether the road desired be necessary for a public or private road; they shall also annex and return to the Court a plot or draft thereof, stating the courses and distances, and noting briefly the improvements through which it may pass; and, whenever practicable, the viewers shall lay out the said roads at an elevation not exceeding five degrees (except at the crossing of ravines and streams), where, by moderate filling and bridging, the declination of the road may be preserved within that limit."

NO. 2, June SESSION, 1908.

Order to view public roads.
in the town of Twp.

Filed 7 September, 1908.

Viewers.

Geo. L. Elden, Jr.
Chas. Rhoady
Ed. A. Mellon

Clerk, Kimbroad 90 cts.
Kittel

RECEIVED MOUNTAIN-HEARD ELECTRIC PRINT.

Sept. 7, 1908. Approved and breadth fixed at thirty feet.

P. B. C. Sandage, J. P. Judge
Dist. Specially Presiding

14 Jan'y 1909 confirmed.

S. S. Kimbroad, Clerk.