

Plan of the proposed Public Road in  
GALLITZEN TOWNSHIP, CAMBRIA COUNTY, PENNA.  
Surveyed and laid out by  
J. Leonard Elder  
Civil Engineer  
Ebensburg, Penna.

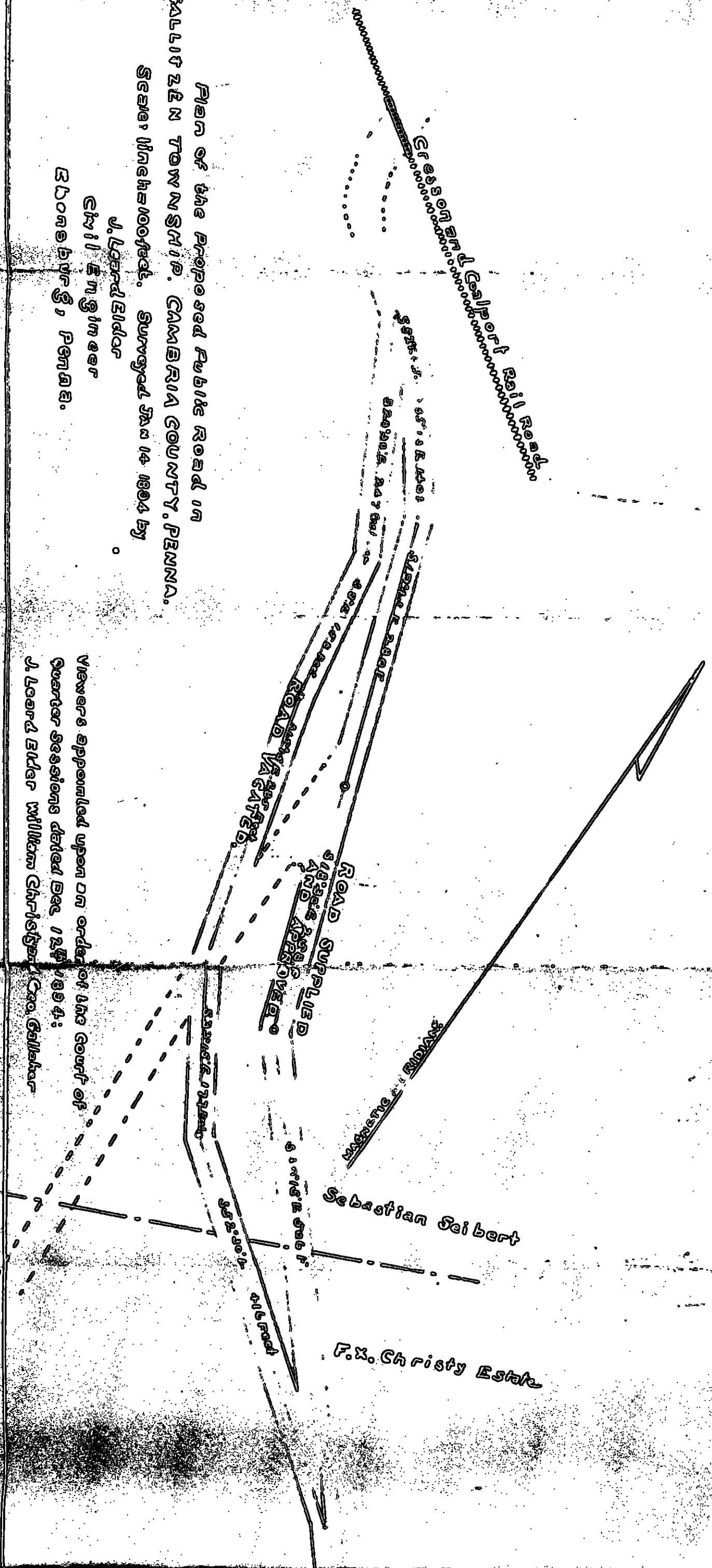

Viewers appointed upon an order of the Court of  
Quercus and others dated Dec. 12, 1904:  
J. Leonard Elder William Gehrisch, Geo. Galloway

L.D. #4. Dec. 1894

Not Microfilmed

In the Court of Quater Sessions of Cambria County

To the Honorable A.V. Barker Judge of the Court of Quater  
Sessions of Cambria County

The undersigned citizens of Gallitzin

Township in said County respectfully represent, that, that part  
of a public road long since laid out leading from the Borough of  
Loretto to the Borough of Gallitzin in said County, commencing  
at a point near where the Cresson and Coalport Rail Road crosses  
said Township Road and ending near a large Sugar tree which stands  
close to the said Township Road on land of G.A. Christy, has long  
been useless inconvenient and burdensome to the inhabitants of  
said Township, they there-fore pray the Court to appoint viewers  
to vacate and supply the part of the public road above mentioned  
by a new road between the points mentioned.

They will ever pray &c.

Elias Behe

C. C. Platt

A. B. Sybert

Peter Moran

Wm. J. Dawson

J. J. Donoughue

John Sybert

Harry Stevens

Paul Sybert

Henry Myers

J. R. Leadbetter

John Shertzer

Frank McDermott

William Mollen

Chas. Reminger

A. F. Trick

C. F. Hoffman

Thomas P. Lloyd

John Becher

J. C. Snyder

Joseph Dignan

L. C. Rockefeller

John M. Kemmer

H. P. Filler

J. C. Platt

Peter Gutwald

No. 14 Dec Dec 1894  
ral.

Petition of Citizens of  
Tallinn Township to  
locate and supply a  
Public Road leading from  
a point near the Rail  
Road crossing at Saw-  
son station on the Cut-  
son and Coalport RR  
to a sugar tree standing  
near said Public Road

12<sup>th</sup> Dec. 1894

J. Sand Elder

Wm. Christy

Geo. Gallager

appointed viewers

By the Court

Filed 12 Dec. 1894.

George

377

remains to be read

To the Honorable A. V. Barker President Judge  
of the Court of Quarter sessions of Cambria County  
Pennsylvania We the undersigned appointed  
by the annexed order respectfully report that  
after giving notice as required by law and  
having all been present at the view of  
the ground proposed for such road to  
be vacated and supplied and having all  
been first severally sworn or affirmed  
to perform our duties according to law

We in pursuance of said order have  
viewed the ground described in said  
order and believing the public road  
commencing at a point near where the  
Erie and Calport Rail Road crosses  
said Township road and ending near  
a large sugar tree or stump close to said  
Township road on land of F. X. Christy  
Estate has become useless inconvenient and  
burdensome and said road greatly exceeds  
five degrees in elevation and ought therefore  
to be vacated and have viewed and vacated  
the same as follows Beginning in public  
road near said Rail Road crossing thence  
South twenty eight and one half degrees East  
two hundred and forty seven feet thence South  
nine degrees East one hundred and fifty eight  
feet thence South fifteen and one fourth degrees  
East two hundred and eighty five feet thence  
South thirty three and one fourth degrees East  
one hundred and seventy seven feet thence South

fifty two and one half degrees East four  
 hundred and sixteen feet in center of  
 public road near the sugar tree or stump  
 and have supplied viewed and laid  
 out and do return for public use the  
 following road to wit. Beginning in Township  
 road near Cresson and Galport Rail Road  
 Crossing thence South fifty two degrees East  
 sixty seven feet thence South thirty five and  
 one fourth degrees East one hundred and forty  
 feet thence South nineteen and three fourths  
 degrees East two hundred and eighty feet  
 thence South eighteen and one half degrees  
 East two hundred and fifty eight feet thence  
 South forty and one fourth degrees East  
 five hundred and six feet to a point in  
 said Township road near sugar tree or  
 stump The roads pass through unimproved  
 lands belonging to Sebastian Sibert and F. X.  
 Christy Estate no damages claimed  
 said road as aforesaid laid out we are  
 of opinion is necessary for a public  
 road and recommend the same a  
 plot or draft thereof is herewith  
 enclosed witness our hands this  
 day of January 1873

J. Leard Elder  
 William Christy  
 George Gallagher

J. Leard Elder 2 days @ .40 per day \$8.00

16 miles  
 William Christy 1 day  
 Geo Gallagher 1 "

1.60  
 2.00  
 2.00  
 13.60

Commonwealth of Pennsylvania, }  
County of Cambria, } ss.

At a Court of Quarter Sessions of the Peace of the County of Cambria held at Ebensburg in the said County, on the Twelfth day of December A. D. 1894, before the Honorable Judge of the said Court: Upon the petition of divers inhabitants of the township of Gallitzin in the said County, setting forth that they ~~labor under inconvenience for want of a~~ road or highway, to lead from bank of a public road long since laid out leading from the Borough of Loretto to the Borough of Gallitzin in said County, commencing at a point near where the Levenson and Broadport Rail Road crosses said Township Road and ending near a large Sugar tree which stands close to the said Township Road on land of E. A. Whittier has long been useless inconvenient and burdensome to the inhabitants of said Township. They therefore pray the Court to appoint viewers to vacate and supply the part of the public road above mentioned by a new road between the points mentioned.

and therefore praying the Court to appoint proper persons to view, vacate, and lay out the same according to law. The Court upon due consideration had of the premises, do order and appoint Jacob Elder SURVEYOR, and Wm. Whittier and Des. Gallagher

VIEWERS; to view the ground proposed for said road, and if they view the same, and shall agree that there is occasion for such road, they shall proceed to lay out the same, having respect to the shortest distance and the best ground for a road, and in such manner as shall do the least injury to private property, and also be, as far as practicable, agreeable to the desire of the petitioners, and that they make a report of their proceedings to the next Court of Quarter Sessions to be held for said County, stating particularly whether they judge the same necessary for a public or private road, together with a plot or draft thereof, and the courses and distances, and references to the improvements through which it may pass.

BY THE COURT.

ATTEST:

Jas. B. Darby  
Clerk.

NOTE.—"It shall be the duty of all persons appointed in the several counties of this Commonwealth to view and review any public or private road or bridge, if they shall decide in favor of locating said road or bridge, to endeavor to procure from the persons over whose land such location may be made releases from all claims for damages that might arise from the opening of such road or the building of such bridge; and in every case where said viewers shall fail to procure such releases, and it shall appear to them that any damages will be sustained, it shall be their duty to assess the damages and make report thereof signed by a majority of their number, and return the same, together with all releases obtained, to the Court of Quarter Sessions, and the damages so assessed shall be conclusive, or may be subject to appeal; review or modification, as may be provided by existing laws in the different counties of this Commonwealth."

"The persons appointed as aforesaid shall view such ground, and if they shall agree that there is occasion for a road, they shall proceed to lay out the same, having respect to the shortest distance, and the best ground for a road, and in such manner as shall do the least injury to private property, and also be, as far as practicable, agreeable to the desire of the petitioners."

"The viewers, as aforesaid, shall make report, at the next term of said Court, and in the said report shall state particularly: first, who of them were present at the view; second, whether they were severally sworn or affirmed; third, whether the road desired be necessary for a public or private road; they shall also annex and return to the Court a plot or draft thereof, stating the courses and distances, and noting briefly the improvements through which it may pass; and, whenever practicable, the viewers shall lay out the said roads at an elevation not exceeding five degrees (except at the crossing of ravines and streams), where, by moderate filling and bridging, the declination of the road may be preserved within that limit."

[illegible]

10 May 1895 Read and confirmed mine and parts  
applied ordered to be opened 30 ft wide  
By the Court

26 June 1895 Confirmed absolutely  
By the Court.