

Commonwealth of Pennsylvania, }
County of Cambria. } SS.

At a Court of Quarter Sessions of the Peace of the County of Cambria held at Ebensburg, in the said County, on the 5th day of August A. D. 1919, before the Honorable Judge of the said Court: Upon the petition of divers inhabitants of the Borough of Lilly, in the said County, setting forth that they labor under inconvenience for want of a Bridge ~~road or highway, to be laid from~~

That Church Street in said Borough is a Main thoroughfare and a much traveled highway, same being a continuation of three converging highways and the main avenue of approach to said Borough.

That the said Church Street crosses a stream known as "The Little Conemaugh" at a point 122 feet East of the intersection of Church St. and George St., and 126 feet West of the intersection of Church and front streets in said Borough.

That the bridge which crosses said stream at this point is old, having been erected by the County years ago, and that a new bridge of more modern construction and more suitable to the demands of the traveling public be erected to replace same.

That the erection of such bridge requires more expense than is reasonable that the said Borough should bear.

and therefore praying the Court to appoint proper persons to view and lay out the same according to law. The Court, upon due consideration had of the premises, do order and appoint

A. M. Shoemaker, C. E. surveyor, and

Adam Shuman and Johnathan Horrocks,

viewers, to view the ground proposed for said ~~road~~ bridge and if they agree that there is occasion for such ~~road~~ bridge, they shall proceed to lay out the same, having respect to the shortest distance and the best ground for a ~~road~~ bridge, and in such manner as shall do the least injury to private property, and also be as far as practicable, agreeable to the desires of the petitioners, and that they make a report of their proceedings to the next Court of Quarter Sessions to be held for said County, stating particularly whether they judge the same necessary for a public or ~~private~~ bridge, together with a plot or draft thereof, and the courses and distances, and references to the improvements through which it may pass.

By the Court.

Attest:

Frank L. Robb, Clerk.

NOTE. "It shall be the duty of all persons appointed in the several counties of this Commonwealth to view and review any public or private road or bridge, if they shall decide in favor of locating said road or bridge, to endeavor to procure from the person or persons over whose land such location may be made releases from all claims for damages that might arise from the opening of such road or the building of such bridge; and in every case where said viewers shall fail to procure such releases, and it shall appear to them that any damages will be sustained, it shall be their duty to assess the damages and make report thereof signed by a majority of their number, and return the same, together with all releases obtained, to the Court of Quarter Sessions, and the damages so assessed shall be conclusive, or may be subject to appeal, review or modification, as may be provided by existing laws in the different counties of this Commonwealth."

"The persons appointed as aforesaid shall view such ground, and if they shall agree that there is occasion for a road, they shall proceed to lay out the same, having respect to the shortest distance, and the best ground for a road, and in such manner as shall do the least injury to private property, and also be, as far as practicable, agreeable to the desire of the petitioners."

"The viewers, as aforesaid, shall make report at the next term of said Court, and in the said report shall state particularly: First, who of them were present at the view, second, whether they were severally sworn or affirmed; third, whether the road desired be necessary for a public or private road; they shall also annex and return to the Court a plot or draft thereof, stating the courses and distances, and noting briefly the improvements through which it may pass; and, whenever practicable, the viewers shall lay out the said roads at an elevation not exceeding five degrees (except at the crossing of ravines and streams), where, by moderate filling and bridging, the declination of the road may be preserved within that limit."

NO. 8 June SESSION, 1919

Order to view

A Bridge in Lilly Borough

over the Little Conemaugh

where Church Street crosses

the same.

3 - 100 CERTIFIED

Viewers.

A. M. Shoemaker, C. E.

Adam Shuman

Johnathan Horrocks,

Clerk Robb. 90 cts.

Filed 1 September 1919

REPORT OF VIEWERS .

To the Honorable, the Judges of the Court of Quarter Sessions of
Cambria County, Pennsylvania.

We, the undersigned members of the board of viewers of Cambria county, appointed by your honorable Court, upon the attached order, to view the site for a proposed new bridge over the Little Conemaugh River, where Church Street crossed same in the Borough of Lilly, said county and state; respectfully report:-

That having given due notice of the view and of the time and place of meeting of the viewers to the Commissioners of Cambria County and the borough council by having them accept service of notices hereto attached, and to the public by printed hand bills posted in public and conspicuous places at and near the site of the proposed bridge: and having been first duly qualified according to law to perform the duties of our appointment faithfully, impartially and to the best of our judgment and ability: All of us met, in accord with the notices so given, at the site of the proposed bridge and having carefully viewed the premises, inspected the old bridge, investigated and inquired into the necessity for a new and more substantial bridge over the Little Conemaugh River at the point above indicated and are all of the opinion that a new and more permanent and more modern bridge over the Little Conemaugh River where the same is crossed by Church Street in the Borough of Lilly is necessary.

The viewers are of the opinion that the cost of constructing the proposed bridge would be more than is reasonable the Borough of Lilly should be required to bear alone and therefore recommend that the County of Cambria should bear two thirds and the Borough of Lilly one third of the cost of constructing the new bridge which we beg leave to suggest should be twenty four feet long and twenty four feet wide with center line of the the/Westerly end of the new bridge fourteen feet and the center line of the Easterly end of the new bridge twenty feet farther South than the center line of the present old bridge and that the new bridge should be approximately four feet higher than the old one, and have a six foot walk for pedestrians on the Northerly side with an eighteen foot driveway to the Southerly side of same.

A plot or draft showing the location of the present old bridge and the size and location of the new bridge as recommended, is hereto attached and made a part of this report.

Witness our hands this thirtieth day of August, A. D., 1919.

A. M. Shoemaker
John H. Horrocks
Reuben L. ...

Viewers.

To Pittsburgh and
→
Philadelphia Pike.

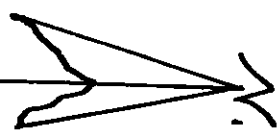

S

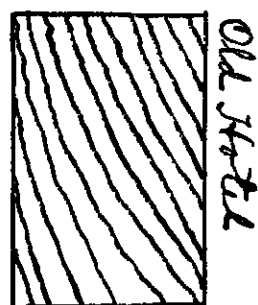

Old Hotel

Church

Sketch showing size and location of
present old bridge and also size and location,
as suggested for recommended new bridge

over the Little Conemaugh River, where same
is crossed by Church Street in City Borough, Pa.
(incorporated into the County of Quackenbush, Pa.
of Cambria County, Pa., Aug. 1919. (Devered,
A. W. Shomaker, Adam Shuman and John H. Horvack,

size and location
recommended
for proposed
new bridge.

stakes representing
center line of abut
leading westward
beyond cross street.

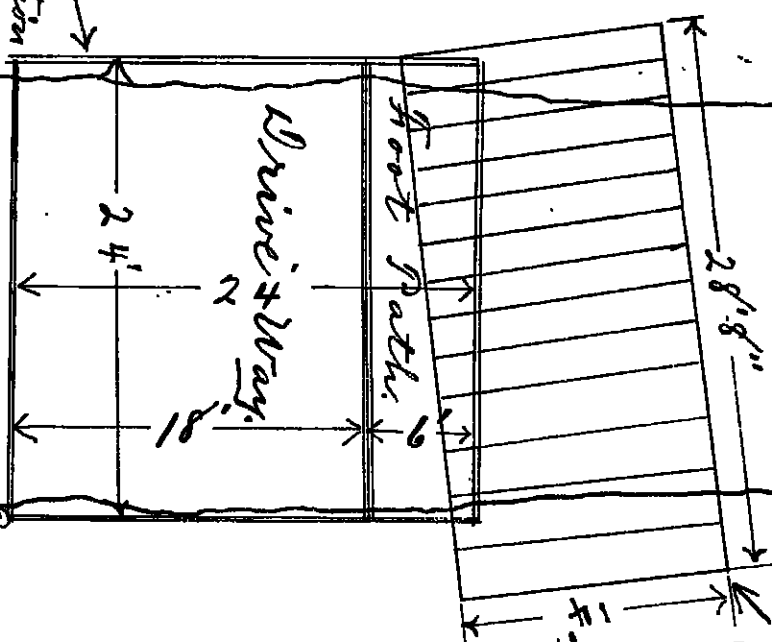

Little
Conemaugh
River

Location of
Old Bridge

Street.

Main Line

P.

P. R.

Cost of View
John H. Horrocks

Day on View ——— \$ 7 50

42 miles ——— 2 10

9 60

Adam Shuman

Day on View \$ 7 50

48 miles 2 40

9 90

A. W. Shoemaker

Lifting Order .90

32 miles 1 60

5 Days 3 75

Engineering work 2 50

6 45

Notice of View!

Notice is hereby given that the viewers appointed by the Court of Quarter Sessions of Cambria County, Pa., to view and determine as to the necessity for a new and more permanent bridge over the Little Conemaugh River; where it is crossed by Church Street, in the Borough of Lilly, said county and state; and as to whom should bear the expense of constructing the same:

will meet at the site of the bridge to be viewed in the Borough of Lilly aforesaid, on the 20th. day of August 1919, at 9:00 o'clock a. m. M., for the purpose of performing the duties of their appointment.

Ebensburg, Pa. 8/7/1919.

A. M. Shoemaker,
Adam Shuman and
John H. Horrocks,
Viewers.

Now, August 1919, service of the within notice is hereby accepted for the Borough Council of the Borough of Lilly, Cambria County, Pa.

T. F. Dougherty.
Boro Clerk.

BRIDGE NOTICE!

Notice is hereby given that the Viewers appointed by the Court of Quarter Sessions of Cambria County, Pa., to view and determine as to the necessity for a new and more permanent bridge over the Little Conemaugh River; where it is crossed by Church Street, in the borough of Lilly, said county and state; and as to whom should bear the expense of constructing the same:

will meet at the site of the bridge to be viewed, in the Borough of Lilly aforesaid, on the 20th. day of August 1919, at 9:00 o'clock a. m. for the purpose of performing the duties of their appointment.

Ebensburg, Pa. 8/7/ 1919.

A. M. Shoemaker,
Adam Shuman and
John H. Horrocks,
Viewers.

Now, August 15th 1919, service of the within notice is hereby accepted for the Commissioners of Cambria County, Pennsylvania.

James M. Duane
Chief Clerk

BOND.

KNOW ALL MEN BY THESE PRESENTS, That we, J. L. Harshberger
Ed Cortlow and P. P. Miller
all of the Township of Adams, County of Cambria and State of Pennsylvania, hereinafter called the Obligors, are held and firmly bound unto the County of Cambria, hereinafter called the Oblige, in the sum of Two Hundred Dollars (\$200.00), lawful money of the United States of America, to be paid to said Oblige, its certain Attorney, successors or assigns, to which payment well and truly to be made, we do bind ourselves, our heirs, executors or administrators, jointly, severally and firmly, by these presents. Sealed with our seals and dated the 11th day of June, A. D. 1919.

WHEREAS certain inhabitants of the Township of Adams in the said County of Cambria, have presented to the Court of Quarter Sessions of the County aforesaid, their petition praying for the appointment of viewers to vacate that part of the Elton to Salix road in said Township which extends from the intersection of the said road with the Township road leading from Sauter shaft to South Fork at the Menonite Church, to the intersection of said (Elton to Salix) road with the public road leading from Salix to Dunlo at land of G. C. Felix at or near the place where the Pennsylvania Railroad to Windber crosses over the said Salix to Dunlo Road, and that a new road with proper grades and curves to replace the the road so to be vacated, be laid out, etc. etc.

Now, Therefore, THE CONDITION of this Obligation is such, that if the above bounden Obligors, their heirs, executors or administrators, or any of them, shall and do well, truly and promptly pay into the Treasury of the said Oblige, when said proceedings are concluded, such amount of money as the said Court may hereafter by order lawfully direct the Petitioners aforesaid to pay, for, toward or on account of defraying and discharging the pay or compensation and mileage of said Viewers and other persons, appointed or employed in said proceedings, in such case made and provided, without any fraud or further delay, then the above obligation to be void, or else to be and remain in full force and virtue.

Sealed and delivered in the
presence of us

B. F. Varner

J. L. Harshberger (SEAL)

Ed Cortlow (SEAL)

P. P. Miller (SEAL)

In the Court of Quarter Sessions
of Columbia County, Pennsylvania
No. _____ 1919

In the matter of Petition of
Inhabitants of Adams
Township for appointment
of viewers to vacate and
lay out part of The
Ellen to Salix Road

June 11th 1919
Read, approved
By the Court

D. P. Warner Clerk

IN THE COURT OF QUARTER SESSION OF CAMBRIA COUNTY, PENNSYLVANIA,
NO. 8 JUNE TERM 1919 , ROAD DOCKET.

IN RE PETITION OF THE INHABITANTS OF LILLY BOROUGH FOR A BRIDGE
IN LILLY BOROUGH WHERE THE LITTLE CONEMAUGH STREAM CROSSES CHURCH
STREET IN SAID BOROUGH.

And now December 1, 1919, the proposed bridge as recommended by the
viewers; report upon the Petition in the above stated proceedings is
approved and authorized by the Grand Jury.

M. J. Berkebile
FOREMAN

And now, December _____ 1919, the report of the Viewers in the above
stated proceedings, and the recommendation of the Grand Jury therein
is hereby concurred in and approved.

IN THE COURT OF QUARTER SESS
ION OF CAMBRIA COUNTY, PENNSYL
VANIA.
V

NO. 8 JUNE TERM.

InRe. Bridge over Little Co
nemaugh Stream in Lilly Boro
Cambria County, Pennsylvania,
where Church Street crosses
said stream.

Filed 12 December 1919.

Approval of Grand Jury

Approval by Court.

IN THE COURT OF QUARTER SESSIONS OF CAMBRIA COUNTY.

To the Honorable, the Judges of said Court:

The petition of the undersigned, inhabitants of the Borough of Lilly, in said County, respectfully represents:

That Church Street in said Borough is a Main Thorofare and a much travelled highway, same being a continuation of three converging highways, and the main avenue of approach to said Borough.

That the said Church Street crosses a stream, known as "The Little Conemaugh", at a point 122 feet East of the intersection of Church and George Streets, and 126 feet West of the intersection of Church and Front Streets in said Borough.

That the Bridge which crosses said stream at this point is old, having been erected by the County years ago, and is in such condition as to require that it be removed, and that a new bridge of more modern construction and more suitable to the demands of the travelling public be erected to replace same.

That the erection of such bridge requires more expense than is reasonable that the said Borough should bear.

Therefore your petitioners pray your Honorable Court to appoint viewers to investigate the situation and report to your Honorable Court the advisability of erecting a bridge, and whether or not the erection of such a bridge requires more expense than it is reasonable the said Borough should bear, and that a new County bridge be erected at this point.

And they will ever pray, &c.

NAME.	RESIDENCE.
William Sweeney	LILLY, CAMBRIA COUNTY, PENNSYLVANIA.
Martin Leap	" " " "
Francis S. Bender	" " " "
John A. Leap	" " " "
H. J. Brady	" " " "
M. C. Lynch	" " " "
W. L. Piper	" " " "
E. J. Duff	" " " "
J. C. Bailey	" " " "
John Doughty	" " " "
A. Brown	" " " "
John E. Lowery	" " " "
J. E. Thompson	" " " "
Paul Smith	" " " "
M. C. Acquadro	" " " "
Leand. George	" " " "
Laron Leachey	" " " "
J. M. Kamey	" " " "
A. J. Lewis	" " " "
Geo. A. Williams	" " " "
Roy W. Cabel	" " " "
J. M. A. Piper	" " " "
Franklin B. Dwyer	" " " "
H. T. Lovern	" " " "
Wm. H. Kinsman	" " " "
Chas. Kinsman	" " " "
J. P. McGonigle	" " " "

NAME.	RESIDENCE.
<i>Grove, George</i>	LILLY, CAMBRIA COUNTY, PENNSYLVANIA.
<i>Shuman, Allen</i>	" " "
<i>C. H. Belie</i>	" " "
<i>B. C. Stinger</i>	" " "
<i>B. A. Janke</i>	" " "
<i>L. M. Sanderson</i>	" " "
<i>P. F. Kristine</i>	" " "
<i>Chas B Kelly</i>	" " "
<i>Basil Bender</i>	" " "
<i>J. C. Leaf</i>	" " "
<i>W. L. M. Gough</i>	" " "
<i>George Rainey</i>	" " "
<i>Giovanni Santia</i>	" " "
<i>John Arseny</i>	" " "
<i>John H. Intosh</i>	" " "
<i>William Owens</i>	" " "
<i>Andrew Owen</i>	" " "

State of Pennsylvania, : ss,
County of Cambria : ss,

Personally before me, a Justice of the Peace, in and for the County of Cambria, State of Pennsylvania, came *David George* one of the above petitioners, who being duly sworn according to law doth depose that the facts set forth in the foregoing petition are true.

Sworn and subscribed to before me :
this 4th day of August, 1919. :

E. J. Ouffy :
Justice of the Peace. :

My Comm. expires 12th Nov Jan 1920

David George

No. 8 June Term 1919
In the Court of Quarter Sessions
of Calaveras County.

In the matter of the erection
of a Bridge in Milly P
rough over the Little Cone-
saugh stream, where Church
Street crossed same.

Filed 5 August 1919.

And now, this 5th day of
August, 1919

A. M. Shumaker & Co.
Adam Sherman
and Jonathan Horrocks
are appointed viewers as
within prayed for.

Ryckle Carr

Filed 5 August 1919,
Geo. W. Williams, Pro.

J. M. Kearney