

716  
TO THE COMMISSIONERS OF CAMBRIA COUNTY,

AND THE SUPERVISORS OF ROADS OF THE TOWNSHIP

OF READE, IN THE SAID COUNTY OF CAMBRIA.

GENTLEMEN:

You are hereby notified that a Petition will be presented to the Court of Quarter Sessions of the Peace of Cambria County, Pennsylvania, on Tuesday, April 3, 1917, asking for the appointment of Viewers to vacate a part of the road leading from the Borough of Bellwood, in the County of Blair, to the Village of Lloydell, in the County of Cambria, Pennsylvania, from a point where the said road intersects with the railroad track of the P. & N. W. railroad at Lloydell Station to the point where said road intersects the division line between Blair and Cambria Counties, all within the Township of Reade, Cambria County, Pennsylvania, and a new road laid out from same point to point at a proper grade and curvature and thus eliminate the dangerous and inconvenient part of the present road.

Edward J. Evans  
Attorneys for Petitioners.

April 2, 1917

We hereby acknowledge service of the above notice.

Supervisors

W. H. Buss

R. H. Richardson

Daniel Mainer

Apr. 3<sup>rd</sup> 1917 Accepted

John H. Hannon  
Chief Clerk

KNOW ALL MEN BY THESE PRESENTS, That we ~~W. H. Deers~~, Frank J. Blount  
A. E. Gould and J. M. Chaplin,

all residents and citizens of the Township of Reade, Cambria County, and Commonwealth of Pennsylvania, are held and firmly bound unto the said Commonwealth in the sum of ONE HUNDRED DOLLARS, lawful money of the United States of America, to which payment well and truly to be made and done we bind ourselves and each of us, our and each of our heirs, executors and administrators, firmly by these presents. Sealed with our seals and dated the 3rd day of April, A. D. 1917.

WHEREAS the Petition of certain of the inhabitants and citizens of the Township of Reade, Cambria County, Pennsylvania, has this day been presented to the Court of Quarter Sessions of the said County of Cambria setting forth that they labor under some inconvenience by reason of the steep grades and sharp curves in a public road in said Township leading from the Borough of Bellwood in the County of Blair to the Village of Lloydville<sup>in</sup> the County of Cambria, part of which they desire vacated and another laid out instead, and praying that that part of the public road which leads from the Borough of Bellwood to the Village of Lloydville<sup>should</sup> be vacated from a point where the said road intersects with the railroad track of the P. & N. W. Railroad, at Lloydsville Station to the point where said road intersects the division line between Blair and Cambria Counties, all within the Township of Reade, Cambria County, Pennsylvania, and a new road laid out from same point to same point at a proper grade and curvature, and thus eliminate the dangerous and inconvenient part of the present road, and praying for the appointment of viewers to vacate and supply said road.

NOW THE CONDITION OF THIS OBLIGATION IS SUCH, That if the Petitioners for the said view, if called upon by the Court, shall

make payment of the costs of said view into the treasury of Cambria County, as provided by law, then this obligation shall be null and void, otherwise to be and remain in full force and virtue.

Sealed and delivered in the  
presence of

R H Richardson

R H Richardson

R H Richardson

L M Chaplin (SEAL)

Frank J. Cloud (SEAL)

A L Gault (SEAL)

BOND

AND NOW April 3, 1917, the  
within bond approved.

By the Court

EVANS & EVANS

EBENSBURG, PA.

JOHN E. EVANS CHAS. S. EVANS

IN THE COURT OF QUARTER SESSIONS OF CAMBRIA COUNTY

TO THE HONORABLE, THE JUDGES OF SAID COURT:

THE Petition of the undersigned residents and citizens of the Township of Reade, in said County and vicinity, respectfully represents:

THAT they labor under some inconvenience by reason of the steep grades and sharp curves in a public road in said Township, leading from the Borough of Bellwood in the County of Blair to the Village of Lloydsville, Cambria County, Pennsylvania, part of which they desire to vacate, and another laid out instead.

THEY pray that that part of the public road which leads from the Borough of Bellwood to the Village of Lloydsville <sup>in</sup> the County of Cambria, Pennsylvania, should be vacated from a point where the said road intersects with the railroad track of the P. & N. W. Railroad, at Lloydsville Station to the point where said road intersects the division line between Blair and Cambria Counties, all within the Township of Reade, Cambria County, Pennsylvania, and a new road laid out from same point to same point at a proper grade and curvature, and thus eliminate the dangerous and inconvenient part of the present road.

THEY, therefore, pray your Honor to appoint viewers for this purpose.

AND they will ever pray, etc.

Chas. H. Rees, Sup.  
R. H. Richardson  
Daniel Mains  
J. M. Chaplin  
Frank J. Cloud  
George A. Davis

William Timber Pa.  
Lloydsville Pa.  
Blandburg Pa.  
Blandburg Pa.  
Blandburg Pa.  
Blandburg Pa.

G. V. Leve	Blandburg Pa
A. J. List	Floydville Pa
A. C. Louell	Blandburg Pa
Patrick Kavanagh	Blandburg Pa
Fred Blanders	Blandburg Pa
H. B. Hopkins	Mountaintop Pa
F. J. McCarthy	Blandburg
A. J. Warner	Blandburg Pa
A. E. List	Floydville Pa
John Kavanagh	Blandburg
J. B. Isenberg	Blandburg
Sam Richards	Floydville
S. S. Robertson	Blandburg
A. C. Stouffer	Blandburg Pa
Thomas Summers	Blandburg Pa
P. H. McCarty	Blandburg Pa
Ormeo Tuma	Blandburg Pa
Joseph Frank	Blandburg Pa
E. A. Woods	Blandburg Pa
Arthur L. Thomas	Blandburg Pa
E. W. Trowers	Blandburg Pa
L. Maudslayi	Blandburg Pa
J. E. Metz	" " " "
L. A. G. G. G. G.	Mountaintop Pa
Charles E. Cropper	Blandburg Pa
Curatellus M. D.	Blandburg Pa
Lee, Hahn	Blandburg Pa
Lady Paul Tiller	Blandburg Pa
Harry Warner	Blandburg Pa
Charles S. Kniss	Mountaintop Pa

Patt Mc Hugh  
R L Dorey  
Alex Mc Vicar  
James Warner

Blandburg Pa  
Blandburg  
Blandburg Pa  
Blandburg Pa

STATE OF PENNSYLVANIA( )  
COUNTY OF CAMBRIA ( ) SS:

BEFORE me, the subscriber, a Justice of the Peace in and  
for said County and State, personally came Robert H.  
Richardson, one of the foregoing Petitioners  
who, being duly sworn according to law, doth depose and say that the  
facts, matters and things set forth in the above and foregoing Peti-  
tion, are true and correct, to the best of his knowledge, information  
and belief.

Sworn and subscribed before me  
this 31<sup>st</sup> day of  
March, A.D. 1917.

Robert Richardson

Patt McHugh  
Justice of the Peace.

My Commission Expires 1st Monday  
in January 1922

No 4 March Term 1917

PETITION

PETITION FOR CHANGE IN ROAD

Grade Turn-

Filed 3 April 1917

AND NOW APRIL 3, 1917,

*C. M. Shoemaker*

*Adam S. Sweeney*

*Geo. K. Stryker*

are appointed viewers,

*By the Court*

EVANS & EVANS

EBENSBURG, PA.

JOHN E. EVANS CHAS. S. EVANS

**R E P O R T   O F   V I E W E R S .**

**To the Honorable, the Judges of the Court of Quarter Sessions of  
Cambria County, Pennsylvania.**

We, the undersigned members of the board of viewers of Cambria county, appointed by your honorable court, upon the attached order, and therein directed to view and determine as to the propriety of vacating and supplying a piece of public road in Reade township, between Lloydville Station and the Blair County Line or a portion of the same, respectfully report:-

That having given due notice of the view and of the time and place of meeting of the viewers to the Commissioners of Cambria county and the Supervisors of Reade township by having them accept service of notices hereto attached, and to the traveling public by printed hand bills posted in public and conspicuous places at and near the termini of the piece of road to be viewed: and having been first duly qualified according to law to perform the duties of our appointment faithfully, impartially and to the best of our judgment and ability; all of us met at the time and place appointed in accordance with the notices so given and having carefully viewed the premises are all of the opinion that the prayer of the petitioners should be granted.

Accordingly we suggest that the piece of road beginning at the railroad tracks at Lloydville Station and taking the following courses and distances; should be vacated; viz. S. 22° 35' W. 188', S. 3° 50' W. 540', S. 2° 45' E. 709', S. 14° E. 183 ft. S. 12° 30' E. 225', S. 14° 10' W. 159', S. 8° 30' W. 335', S. 2° 30' W. 242', S. 13° 25' E. 395', S. 6° W. 304', S. 12° 45' W. 289.8', S. 24° 30' E. 289', S. 13° 30' E. 246', and S. 21° E. 225' and instead thereof the piece of road taking the following courses and distances should be supplied, viz. N. 9° W. 271', N. 12° W. 142', N. 25° W. 218.4', N. 22° 40' W. 183', N. 11° 40' E. 125', N. 27° 10' E. 184', N. 15° E. 161', N. 1° 30' W. 152', North 133', N. 5° 30' W. 141', N. 8° 50' E. 118', N. 8° 25' E. 163', N. 5° 30' W. 145', N. 10° 35' W. 130', N. 2° 15' E. 177.4', N. 6° 30' E. 196', N. 2° E. 186', N. 6° 10' E. 165', N. 4° 25' E. 183.6', N. 3° 10' E. 176', N. 4° 05' E. 180', N. 13° 50' W. 132', N. 18°

W. 295', N. 3°30' W. 231', and N. 9°10' E. 277'.

The location of that portion of the road between the point marked "Small Bridge" on attached draft and the Blair Co. line cannot be improved tho the road may be much improved by moderate filling and widening. As no damage will be sustained by reason of the change of the portion of the road recommended to be changed, we have assessed none.

Witness our hands this 31st. day of May A.D., 1917.

A. M. Shumaker

Geo. W. Shumaker

# Cost of View.

Geo K Shryock

4 Days \$20 00  
247 miles 12 35  
jitney hire 2 00

Adam Shuman

4 Days \$20 00  
223 miles 11 15  
jitney hire 2 00

A. M. Shoemaker

Lifting Order .90  
7 1/2 Days 37 50  
193 miles 9 45  
jitney hire 2 00  
2 Prints @ .00 1 00

51 05

Chairmen & Car men  
B. W. McCarty - Blandburg, Pa. 1 Day \$2 00  
James Warner - " " 1 " 2 00  
Robt. Richardson - " R.D. 2 " 4 00  
Wm Coulter & Robt Richardson " " 1 " 2 00

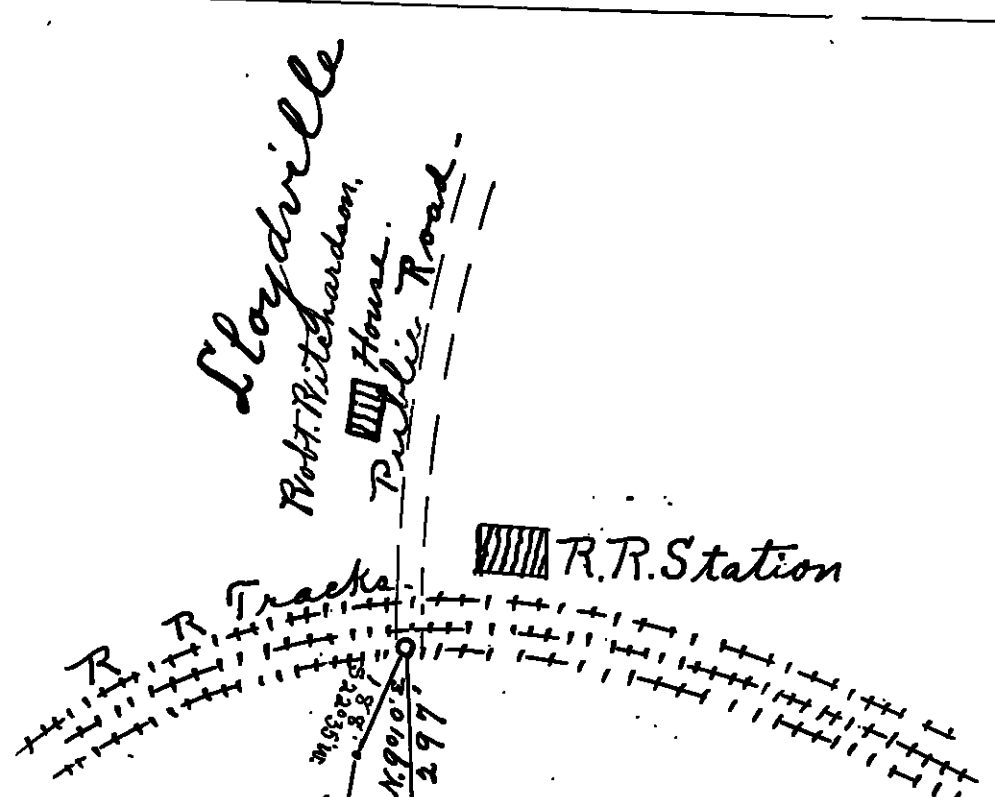

Piece of road proposed to be  
 vacated  
 Uncleared and unimproved land  
 recommended to be supplied  
 from small bridge to Blair Co. line.

Cambria  
 Blair County  
 Spring  
 to Bolwood  
 County

# ROAD NOTICE

Notice is hereby given that the Viewers appointed by the Court of Quarter Sessions of Cambria County, Pa., to view and determine as to the propriety of vacating and supplying a certain piece of public road in Reade township, Cambria county, Pa., which leads from the borough of Bellwood in Blair Co. to the village of Lloydville in Cambria Co.: Beginning at a point where said public road intersects with the railroad track of the P. & N. W. Railroad, at Lloydville Station, in Cambria Co., and ending at the point on said road where it is intersected by the line dividing Cambria county from Blair county:

will meet at the point of ending, above designated, in the township of Read aforesaid, on the 27th. day of April 1917, at 10:00 o'clock a. m., for the purpose of performing the duties of their appointment.

A. M. Shoemaker,

Adam Shuman and

Geo. K. Shryock,

Viewers.

Ebensburg, Pa. 4 / 12/1917.

Now, April 16<sup>th</sup> 1917, service of the within notice is hereby  
accepted by the undersigned supervisors of the township of  
Reade, Cambria Co., Pa.

W. H. Beers

R. H. Williams

David Martin

Supervisors.

# ROAD NOTICE

Notice is hereby given that the Viewers appointed by the Court of Quarter Sessions of Cambria County, Pa., to view and determine as to the propriety of vacating and supplying a certain piece of public road in Reade township, Cambria county, Pa., which leads from the borough of Bellwood in Blair Co. to the village of Lloydville in Cambria Co.: Beginning at a point where said public road intersects with the railroad track of the P. & W. W. Railroad, at Lloydville Station, in Cambria Co., and ending at the point on said road where it is intersected by the line dividing Cambria county from Blair county:

will meet at the point of ending, above designated, in the township of Road aforesaid, on the 27th. day of April 1917, at 10:00 o'clock a. m., for the purpose of performing the duties of their appointment.

A. L. Shoemaker,

Adam Shuman and

Geo. K. Shryock,

Viewers.

Donoburg, Pa. 4 / 12/1917.

Now, April <sup>30</sup> 1917, service of the within notice is hereby  
accepted for the Commissioners of Cambria County, Penn'a.

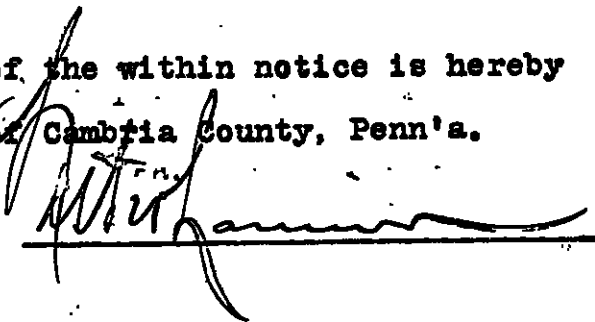

A handwritten signature, appearing to read "W. H. Lamm", is written over a horizontal line. The signature is in cursive and extends above and below the line.

# ROAD NOTICE

Notice is hereby given that the Viewers appointed by the Court of Quarter Sessions of Cambria County, Pa., to view and determine as to the propriety of vacating and supplying a certain piece of the public road leading from the borough of Bellwood, in Blair County, to the village of Lloydville, in Cambria County: Beginning at a point where said public road intersects with the railroad track of the P. & N. W. Railroad, at Lloydville Station, in Cambria county and ending at the point on the said road where it is intersected by the line dividing Cambria county from Blair county: Said piece of public road to be viewed laying in Reade Township, Cambria Co., Pa.: will meet at the point of ending, above noted, in the township of Reade aforesaid, on the 27th. day of April 1917, at 10:00 o'clock a.m., for the purpose of performing the duties of their appointment.

A. M. Shoemaker,  
Adam Shuman and  
Geo. K. Shryock,

Viewers.

Ebensburg, Pa. 4/12/ 1917.

Commonwealth of Pennsylvania, }  
County of Cambria. } SS.

At a Court of Quarter Sessions of the Peace of the County of Cambria held at Ebensburg, in the said County, on the Third day of April A. D. 191 7, before the Honorable Judge of the said Court: Upon the petition of divers inhabitants of the Township of Reade, in the said County, setting forth that they labor under inconvenience for want of a Public road or highway, to lead from the Borough of Bellwood in the County of Blair to the Village of Lloydville, Cambria County, Pennsylvania part of which they desire to vacate and another laid out instead.

That pray that a part of the public road which leads from the Borough of Bellwood to the Village of Lloydville in the County of Cambria Pennsylvania should be vacated from a point where the said road intersect with the railroad track of the P. & N. W. Railroad, at Lloydville Station to the point where said road intersects the division line between Blair and Cambria Counties all within the Township of Reade Cambria County Pennsylvania and a new road laid out from same point at a proper grade and curvature and thus eliminate the dangerous and inconvenient part of the present road

and therefore praying the Court to appoint proper persons to view and lay out the same according to law. The Court, upon due consideration had of the premises, do order and appoint

A. M. Shoemaker,

surveyor, and

Adam Skuman

Geo K. Shryock,

viewers, to view the ground proposed for said road, and if they view the same, and shall agree that there is occasion for such road, they shall proceed to lay out the same, having respect to the shortest distance and the best ground for a road, and in such manner as shall do the least injury to private property, and also be as far as practicable, agreeable to the desires of the petitioners, and that they make a report of their proceedings to the next Court of Quarter Sessions to be held for said County, stating particularly whether they judge the same necessary for a public or private road, together with a plot or draft thereof, and the courses and distances, and references to the improvements through which it may pass.

By the Court.

Attest:

Frank C. Robb, Clerk.

NOTE. "It shall be the duty of all persons appointed in the several counties of this Commonwealth to view and review any public or private road or bridge, if they shall decide in favor of locating said road or bridge, to endeavor to procure from the person or persons over whose land such location may be made releases from all claims for damages that might arise from the opening of such road or the building of such bridge; and in every case where said viewers shall fail to procure such releases, and it shall appear to them that any damages will be sustained, it shall be their duty to assess the damages and make report thereof signed by a majority of their number, and return the same, together with all releases obtained, to the Court of Quarter Sessions, and the damages so assessed shall be conclusive, or may be subject to appeal, review or modification, as may be provided by existing laws in the different counties of this Commonwealth."

"The persons appointed as aforesaid shall view such ground, and if they shall agree that there is occasion for a road, they shall proceed to lay out the same, having respect to the shortest distance, and the best ground for a road, and in such manner as shall do the least injury to private property, and also be, as far as practicable, agreeable to the desire of the petitioners."

"The viewers, as aforesaid, shall make report at the next term of said Court, and in the said report shall state particularly: First, who of them were present at the view, second, whether they were severally sworn or affirmed; third, whether the road desired be necessary for a public or private road; they shall also annex and return to the Court a plot or draft thereof, stating the courses and distances, and noting briefly the improvements through which it may pass; and, whenever practicable, the viewers shall lay out the said roads at an elevation not exceeding five degrees (except at the crossing of ravines and streams), where, by moderate filling and bridging, the declination of the road may be preserved within that limit."

NO. 4, March SESSION, 1917

Order to view to Vacate and  
Supply a Part of the road  
Leading from Bellwoods in the  
County of Blair to Lloydville  
in the County of Cambria all  
the road within the Township  
of Reade.

JUN 11 1917 CERTIFIED

Viewers.

A. M. Shoemaker.

Adam Shuman

Geo K. Shryock.

Clerk Robb. 90 cts.

Filed 7 June 1917 at Blair County  
Franklin B. Bate

7 June 1917 Approved and Breadth fixed at Forty Feet.  
By the Court