

Rat Microfilmed

RD#3

Sept. 1916

neg #1

Required Barriers			
170	2	=	650 Feet
370	4	=	340 Feet
570	6	=	137 Feet
770	8	=	650 Feet
970	10	=	1676 Feet
1170	12	=	450 Feet
Total		=	3903 Feet

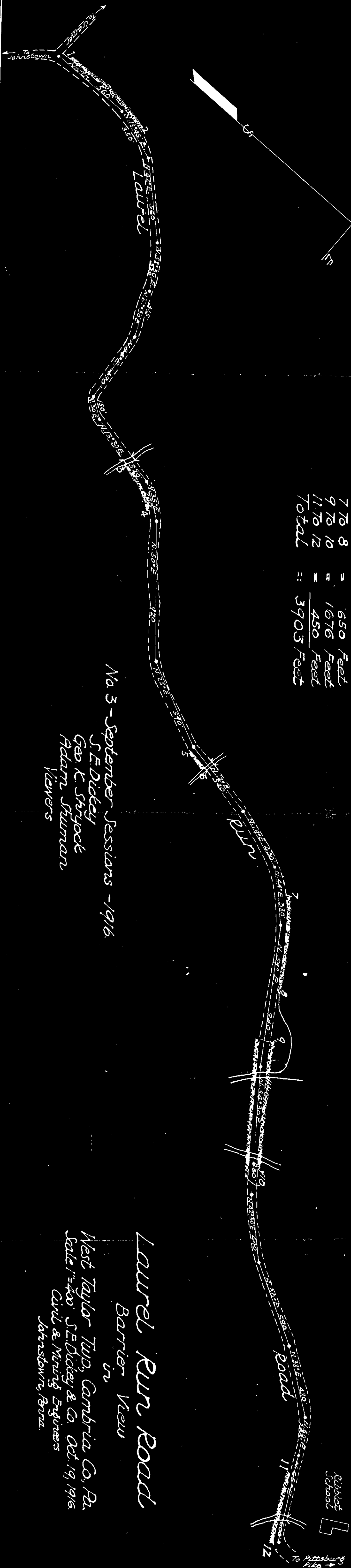

No. 3 - September Sessions - 1916
 J. E. Dickey
 Geo. K. Shyock
 Adam Stuman
 Weavers

Laurel Run Road
 Barrier View
 West Taylor Twp, Cambria Co., Pa.
 Scale 1"=400' J. E. Dickey & Co. Oct. 19, 1916
 Civil & Mining Engineers
 Johnstown, Penna.

5-B-124

Not Microfilmed

RD # 3

Sept. 1916

map # 3

Not Indexed

WEST TAYLOR TOWNSHIP
 MAP
 TO
 ACCOMPANY PETITION
 FOR
 GUARD RAILS
 ALONG
 LAUREL RUN ROAD
 CAMBRIA CO. PENNA.

Scale: 1"=400ft
 OFT L. MAG. ENGR. JOHNSTOWN, PA.
 AUGUST 18, 1916.

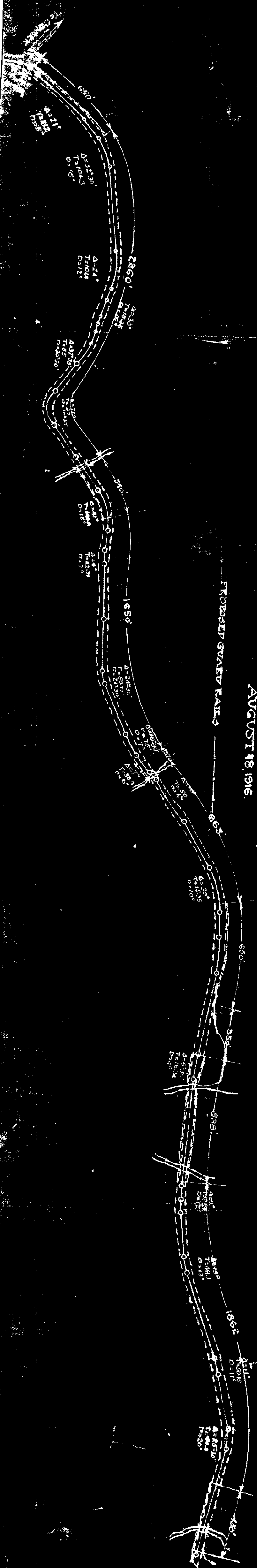

not microfilmed

RD# 3

Sept. 1972

Required Barriers		
1 To 2	=	650 Feet
3 To 4	=	340 Feet
5 To 6	=	137 Feet
7 To 8	=	650 Feet
9 To 10	=	1676 Feet
11 To 12	=	450 Feet
Total	=	3903 Feet

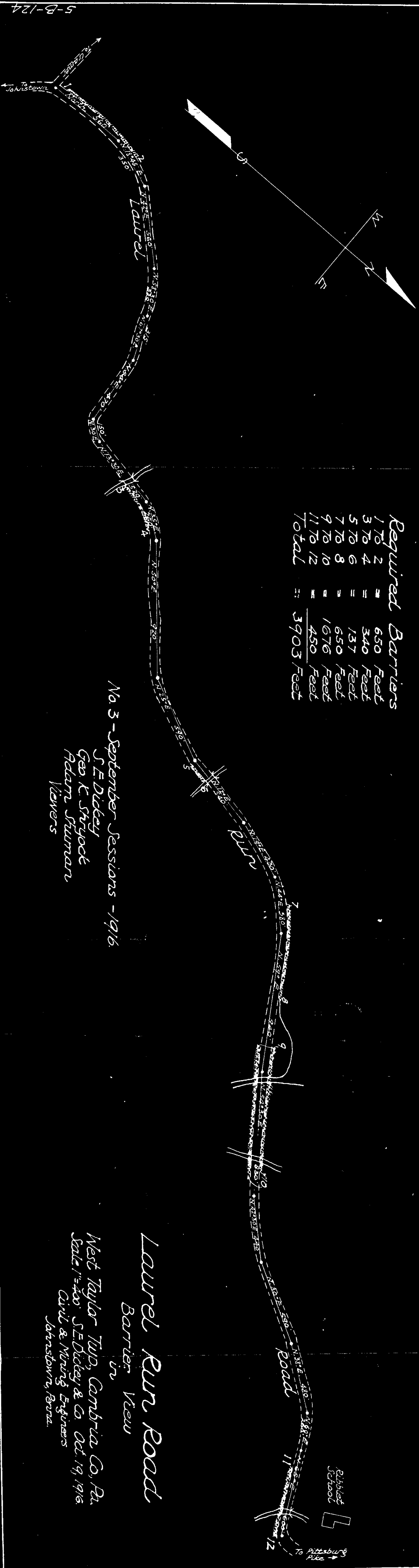

Laurel Run Road
Barrier View
West Taylor Twp, Cambria Co, Pa.
Scale 1"=400' S.E. Dickey & Co. Oct. 19, 1916
Civil & Mining Engineers
Johnstown, Penna.

5-B-124

KNOW ALL MEN BY THESE PRESENTS, That we, M. C. Horner, A. M. Adams and Jno. A. Satzinger, all of the Township of West Taylor, in the County of Cambria, in the State of Pennsylvania, hereinafter called the Obligors, are held and firmly bound unto the County of Cambria, hereinafter valled the Obligee, in the sum of Two Hundred (\$200.00) Dollars, lawful money of the United States of America, to be paid to said Obligee, its certain Attorney, successors or assigns, to which payment well and truly to be made, we do bind ourselves, our heirs, executors or administrators, jointly, severally and firmly by these presents.

Sealed with our seals. Dated the day of August, in the year of our Lord, One thousand, nine hundred and sixteen (1916).

WHEREAS, the Obligors above named as Supervisors of the Township of West Taylor in said County of Cambria, are about to have presented to the Court of Quarter Sessions of the Peace in and for the County aforesaid, their Petition praying for the appointment of a Jury to View and to report on the necessity for guards or barriers to be erected for the protection of the traveling public upon that part of the Laurel Run Road in said Township of West Taylor which begins at the point marking the intersection of the said Laurel Run Road with the Cramer Pike and ends at the point marking the intersection of same with the Red Run Road at the Riblett School House, etc.,

NOW, THEREFORE, THE CONDITION OF THIS OBLIGATION IS SUCH, that if the above bounden Obligors, their heirs, executors or administrators, or any of them shall and do well, truly and promptly pay into the Treasury of said Obligee, when said proceedings are concluded, such amount of money as the said Court may hereafter by order lawfully direct the Petitioners aforesaid to pay, for, toward or on account of defraying and discharging the pay or compensation and mileage of said Viewers and other persons, appointed or employed in said proceedings, as required by the Act of the General Assembly of Pennsylvania, in such case made and provided, without any fraud or further delay, then the above obligation to be void, or else to be and remain in full force and virtue.

Sealed and delivered in the
presepce of:

Thomas
R. P. Coleman

M. C. Horner (SEAL)
A. M. Adams (SEAL)
Jno. A. Satzinger (SEAL)

In the Court of Q. S. of
Cambria County, Pennsylvania
No. 3 *Sept* Sessions, 1916

In the matter of Petition
for guards or barriers for
Laurel Run Road in West
Taylor Township,

Bond: Filed *4 Sept. 1916*

GEORGE C. KEIM
ATTORNEY AT LAW
JOHNSTOWN, PENNA.
OTTO BUILDING

Baltimore Office Supply Co., Baltimore, Md.

In Re: Petition of the Supervisors of West Taylor Township for the purpose of erecting guard rails on part of Laurel Run Road.

In the Court of Quarter Session of Cambria County, Pennsylvania.
No. 3 Sept. Session, 1916.

REPORT

To the Honorable the Judges of the above mentioned court;
We the undersigned viewers appointed by the annexed order of the court to view the road within mentioned, respectfully report; That we have been duly sworn as members of the permanent board of viewers as shown by the records of the court, that having given due public notice of the said view and of the time and place of meeting of the viewers by posting notices along the route and at the termini of said road as required by law and by service of such notices on the Commissioners of Cambria County and the Supervisors of West Taylor Township, evidence of which is shown by the copies of said notices hereto attached. We met in accordance with the notice given on the 10th day of October A. D. 1916 at 10 o'clock A. M. and proceeded with the duties of our appointment. We viewed the site and location for proposed guard rails or barriers making a personal inspection of the points mentioned in the within order and find same to be very abrupt, banks or precipices and steep slopes. A representative of the Supervisors and others were present and heard.

After due consideration of all the matter before us we are of the opinion that guard rails or barriers are necessary at the points indicated on the map attached hereto and made a part hereof as follows:

1 to 2	-	650	feet	
3 to 4	-	340	"	
5 to 6	-	137	"	
7 to 8	-	650	"	
9 to 10	-	1676	"	one-half on either side of road
11 to 12	-	450	"	
Total			3903	feet

The location of the above barriers is definitely shown by courses and distances shown on the above mentioned blue prints. In our opinion the guard rails or barriers recommended by us are of such public necessity that the township should have assistance in the erecting of same by the County.

Witness our hand this 11 day of Nov month
A. D. 1916.

P. E. Dickey
G. N. Dickey
Adam Shuman

In Re: Petition of the Supervisors of West Taylor Township for the purpose of erecting guard rails on part of Laurel Run Road.

In the Court of Quarter Session of Cambria County, Pennsylvania.
No. 3 Sept. Session, 1916.

NOTICE OF VIEW

Notice is hereby given that the Viewers appointed by the Court of Quarter Session to view the site and determine as to the necessity of erecting guard rails or barriers along the Laurel Run Road in West Taylor Township, Cambria County, Pennsylvania, beginning at a point along said road 60 feet North of the said point of intersection of said Laurel Run Road with the Cramer Pike; thence along the Westerly side of said road in a Northerly direction 650 feet; thence next beginning at a point along said road 2970 feet North and East of the said point of intersection of Laurel Run Road and the Cramer Pike; thence along the Southeasterly side of said road in a Northeasterly direction 340 feet; thence next beginning at a point along said road 4960 feet North and East of said point of intersection of said Laurel Run Road with the Cramer Pike; thence along the Southerly side of said road in a Northeasterly direction 137 feet; thence next beginning at a point along said road 6060 feet North and East of the aforesaid point of intersection of Laurel Run Road with the Cramer Pike; thence along the Northerly side of Laurel Run Road in a Northeasterly direction 650 feet; thence next beginning at a point along said road 7060 feet North and East of the aforesaid point of intersection of Laurel Run Road and the Cramer Pike; thence along both sides of said road in a Northeasterly direction 838 feet; thence next beginning at a point along said road 9760 feet North and East from the aforesaid point of intersection of said Laurel Run Road with the Cramer Pike; thence along the Southerly side of said road in a Northeasterly direction 450 feet to a point near Riblett School House, in said Township, will meet at the place of beginning in the Township of West Taylor aforesaid on the 10th day of October 1916 at 10 o'clock A.M. for the purpose of performing the duties of this appointment.

S. E. DICKLEY

GEO. K. SHRYOCK

ADAM SHUMAN

Viewers

Now Sept. 30th 1916, Service of within notice is hereby accepted by the undersigned Commissioners of Cambria County, Pennsylvania.

W. H. Hanner
Clerk for Commissioners

In Re: Petition of the Supervisors of West Taylor Township for the purpose of erecting guard rails on part of Laurel Run Road.

In Court of Quarter Sessions
of Cambria County
Pennsylvania,
No. 3, Sept. Session, 1916.

NOTICE OF VIEW

Notice is hereby given that the Viewers appointed by the Court of Quarter Session to view the site and determine as to the necessity of erecting guard rails or barriers along the Laurel Run Road in West Taylor Township, Cambria County, Pennsylvania, beginning at a point along said road 60 feet North of the said point of intersection of said Laurel Run Road with the Cramer Pike; thence along the Westerly side of said road in a Northerly direction 650 feet; thence next beginning at a point along said road 2970 feet North and East of the said point of intersection of Laurel Run Road and the Cramer Pike; thence along the Southeasterly side of said road in a Northeasterly direction 340 feet; thence next beginning at a point along said road 4960 feet North and East of the said point of intersection of said Laurel Run Road with the Cramer Pike; thence along the Southerly side of said road in a northeasterly direction 137 feet; thence next beginning at a point along said road 6060 feet North and East of the aforesaid point of intersection of Laurel Run Road with the Cramer Pike; thence along the Northerly side of Laurel Run Road in a Northeasterly direction 650 feet; thence next beginning at a point along said road 7060 feet North and East of the aforesaid point of intersection of Laurel Run Road and the Cramer Pike; thence along both sides of said road in a Northeasterly direction 838 feet; thence next beginning at a point along said road 9760 feet North and East from the aforesaid point of intersection of said Laurel Run Road with the Cramer Pike; thence along the Southerly side of said road in a Northeasterly direction 450 feet to a point near Riblett School House, in said Township, will meet at the place of beginning in the Township of West Taylor aforesaid on the 10th day of October 1916 at 10 o'clock A. M. for the purpose of performing the duties of this appointment.

G. E. DICKEY

GEO. K. SHRYOCK

ADAM SHULMAN
Viewers

In Re: Petition of the Super-
visors of West Taylor Township
for the purpose of erecting
guard rails on part of Laurel
Run Road.

In the Court of Quarter Session
of Cambria County,
Pennsylvania,
No. 3, Sept. Session, 1916.

To S. E. DICKEY, GEO. K. SHRYOCK & ADAM SHUMAN Dr.

To S. E. DICKEY Dr.

Preparing, posting and serving notices	\$ 7.00
Mileage	.70
Stationery & Postage	.44
Making view	5.00
Mileage	.70
Data & Preparing draft	5.00
Tracing cloth	.25
Blue Print	.90
Preparing report	5.00
Stenographer	1.00
Stationery	.25
Lifting order	.90
	<hr/>
	\$ 27.14

To GEO. K. SHRYOCK Dr.

Making View	5.00
Mileage	.70
	<hr/>
	\$ 5.70

To ADAM SHUMAN Dr.

Making View	5.00
Mileage	2.30
	<hr/>
	\$ 7.30

Total Cost of View \$ 40.14

COMMONWEALTH OF PENNSYLVANIA:

COUNTY OF CAMBRIA

: SS
:

At a Court of Quarter Sessions of the Peace of the County of Cambria held at Ebensburg, in the said County, on the fourth day of September, A. D. 1916, before the Honorable Judges of the said Court: Upon petition of the Supervisors of the Township of West Taylor, in said County, setting forth that they labor under inconvenience for want of Guards or Barriers on certain parts of the Laurel Run Road, to wit: That that part of the Laurel Run Road in said Township of West Taylor which begins at the point marking the intersection of said road with the Cramer Pike at the distance of 3,222 feet in a Northwesterly direction from the intersection of said Laurel Run Road (as extended into Cooper Avenue) and Stutzman Street in the 21st Ward of the City of Johnstown and ends at the point marking the intersection of said road with the Red Run Road at Riblett School House, which point of intersection is about three miles distant in a Southerly direction from a point where said Red Run Road intersects the Pittsburgh Pike, runs along the edges of precipices at different places along which it is necessary to erect guards or barriers for the protection of the traveling public:

That the several places on said above described Laurel Run Road where precipices exist and where it is represented that guards or barriers should be erected for the protection of the traveling public are indicated on a blue print map accompanying this petition and are as follows;

(1) Beginning at a point along said road 60 feet North of the said point of intersection of said Laurel Run Road with the Cramer Pike; thence along the Westerly side of said road in a Northerly direction 650 feet;

(2) Beginning at a point along said road 2970 feet North and

East of the said point of intersection of Laurel Run Road and the Cramer Pike; thence along the Southeasterly side of said road in a Northeasterly direction 340 feet;

(3) Beginning at a point along said road 4960 feet North and East of the said point of intersection of said Laurel Run Road with the Cramer Pike; thence along the Southerly side of said road in a Northeasterly direction 137 feet;

(4) Beginning at a point along said road 6060 feet North and East of the aforesaid point of intersection of Laurel Run Road with the Cramer Pike; thence along the Northerly side of Laurel Run Road in a Northeasterly direction 650 feet;

(5) Beginning at a point along said road 7060 feet North and East of the aforesaid point of intersection of Laurel Run Road and the Cramer Pike; thence along both sides of said road in a Northeasterly direction 838 feet;

(6) Beginning at a point along said road 9760 feet North and East from the aforesaid point of intersection of said Laurel Run Road with the Cramer Pike; thence along the Southerly side of said road in a Northeasterly direction 450 feet to a point near Riblett School House.

That the erecting of such guards or barriers requires more expense than it is reasonable the said Township of West Taylor should bear.

Your petitioners therefore pray your Honors to appoint such persons to view the premises, and to take such order on the subject as is required by the Act of the General Assembly in such case made and provided. And they will ever pray, etc.

M. C. Horner	} Supervisors.
A. M. Adams	
Jno. A. Satzinger	

Your petitioners therefore pray your Honorable Court to appoint proper persons to view and lay out the same according to law. The Court, upon due consideration had of the premises, do order and appoint S. E. Dickey C.E. surveyor and George K. Shryock and Adam Shuman, viewers to view the ground and road for proposed guards or barriers, and if they view the same, and shall agree that there is occasion for such guards or barriers along said road, they shall proceed to lay out the same, having respect to the shortest distance at points suggested along the said road for such guards or barriers, and in such manner as shall do the least injury to private property, and also be as far as practicable, agreeable to the desires of the petitioners, and that they make a report of their proceedings to the next Court of Quarter Sessions to be held for said County, stating particularly whether they judge the same guards or barriers along said public road necessary, together with a plot or draft thereof, and the courses and distances, and references to the improvements through which it may pass.

By the Court,

Attest:

Frank C. Robb
Clerk

COURT OF QUARTER SESSIONS,
CAMBRIA COUNTY, PENNA.
3. SEPT. SESSIONS, 1916

In Re Petition of the
SUPERVISORS OF WEST TAYLOR
TOWNSHIP for an order of
view for purpose of erecting
guard rails on part of LAUR-
EL RUN ROAD with CRAMER PIKE
extending into Cooper Avenue
and Stutzman Street in the
21st Ward, Johnstown, Pa.

DEC 13 1916 CLERK

O R D E R T O V I E W

*Filed 6 December 1916 in
Open Court.*

S. E. Dickey, C. E.

George K. Shryock

Adam Shuman,

V I E W E R S

Keim Atty

W. G. JOHNSON & CO., PITTSBURGH, PA.

6 December 1916 Approved

By the Court

Now March 9th 1917, The Grand Jurors in Session approve
the report of the viewers herein & recommend that the
Guard rails or barriers therein mentioned be erected by the County
of Cambria

W. C. Perry

Foreman

Now March 9, 1917 the afore action is
approved and concurred in

By the Court

In the Court of Quarter Sessions of the Peace in and for the
County of Cambria, Pennsylvania.

No.

Sessions, 1916.

To the Honorable, the judges of said Court:

The petition of the undersigned supervisors of the Township of West Taylor, in said County, respectfully represents:

That that part of the Laurel Run Road in said Township of West Taylor which begins at the point marking the intersection of said road with the Cramer Pike at the distance of 3,222 feet in a Northwesterly direction from the intersection of said Laurel Run Road (as extended into Cooper Avenue) and Stutzman Street in the 21st Ward of the City of Johnstown and ends at the point marking the intersection of said road with the Red Run Road at Riblett School House, which point of intersection is about three miles distant in a Southerly direction from a point where said Red Run Road intersects the Pittsburgh Pike, runs along the edges of precipices at different places along which it is necessary to erect guards or barriers for the protection of the travelling public:

That the several places on said above described Laurel Run Road where precipices exist and where it is represented that guards or barriers should be erected for the protection of the traveling public are indicated on a blue print map accompanying this petition and are as follows;

(1) Beginning at a point along said road 60 feet North of the said point of intersection of said Laurel Run Road with the Cramer Pike; thence along the Westerly side of said road in a Northerly direction 650 feet.

(2) Beginning at a point along said road 2970 feet North and East of the said point of intersection of Laurel Run Road and the Cramer Pike; thence along the South easterly side of said road in a Northeasterly direction 340 feet.

MAP #3

(3) Beginning at a point along said road 4960 feet North and East of the said point of intersection of said Laurel Run Road with the Cramer Pike; thence along the Southerly side of said road in a Northeasterly direction 137 feet.

(4) Beginning at a point along said road 6060 feet North and East of the aforesaid point of intersection of Laurel Run Road with the Cramer Pike; thence along the Northerly side of Laurel Run Road in a Northeasterly direction 650 feet.

(5) Beginning at a point along said road 7060 feet North and East of the aforesaid point of intersection of Laurel Run Road and the Cramer Pike; thence along both sides of said road in a Northeasterly direction 838 feet.

(6) Beginning at a point along said road 9760 feet North and East from the aforesaid point of intersection of said Laurel Run Road with the Cramer Pike; thence along the Southerly side of said road in a Northeasterly direction 450 feet to a point near Riblett School House.

That the erecting of such guards or barriers requires more expense than it is reasonable the said Township of West Taylor should bear.

Your petitioners therefore pray your Honors to appoint such persons to view the premises, and to take such order on the subject as is required by the Act of the General Assembly in such case made and provided. And they will ever pray, etc.

W. C. Horn
Wm A. Davis
Jas A. Sappinger } Supervisors.

State of Pennsylvania,)
County of Cambria.) SS:

On this *first* day of *September*, 1916, personally appeared before the undersigned, a Justice of the Peace, in and for the said County of Cambria, M. C. Horner, A. M. Adams and Jno. A. Satzinger, the above-named petitioners, who being duly sworn according to law, do depose and say that they are the Township Supervisors of the Township of West Taylor, Cambria County, and that the facts set forth in the foregoing petition are true and correct.

M. C. Horner
A. M. Adams
Jno. A. Satzinger

Subscribed and sworn to before me, this *first* day of *September*, 1916.

W. P. Ribblet
Justice of the Peace.

My Commission Expires 1st Mon. Jan 1922

Order.

And now, September 4, 1916, the Court, on due consideration, do order and appoint J. E. Dickey and George H. Shryack and Edwin Hummer to view that part of Laurel Run Road mentioned in the aforesaid petition and inquire and judge whether such guards or barriers are necessary to be erected along the edges of precipices along said road for the protection of the traveling public and would be too expensive for such township to erect and do direct that they view said road and make report accordingly to the next Court of Quarter Sessions.

Register Court

In the Court of Quarter Sessions of the Peace, in and for the
County of Cambria, Pennsylvania.

To T. Stanton Davis, H. B. Heffley and E. W. Baumgardner,
Commissioners of Cambria County.

TAKE NOTICE

That on Monday, September 4, 1916, at 10 o'clock in the morning in the Court Room in the Court House at Ebensburg, in and for the County of Cambria, aforesaid, there will be presented the petition of M. C. Horner, A. M. Adams and Jno. A. Satzinger, Supervisors of the Township of West Taylor, said County, setting forth

That that part of the Laurel Run Road in said Township of West Taylor which begins at the point marking the intersection of said road with the Cramer Pike at the distance of 3,222 feet in a North-westerly direction from the intersection of said Laurel Run Road (as extended into Cooper Avenues) and Stutzman Street in the 21st Ward of the City of Johnstown and ends at the point marking the intersection of said road with the Red Run Road at Riblett School House, which point of intersection is about three miles distant in a Southerly direction from a point where said Red Run Road intersects the Pittsburgh Pike, runs along the edges of precipices at different places along which it is necessary to erect guards or barriers for the protection of the traveling public;

That the several places on said above described Laurel Run Road where precipices exist and where it is represented that guards or barriers should be erected for the protection of the traveling public are indicated on a blue print which accompanies said petition and are as follows;

(1) Beginning at a point along said road 60 feet North of the said point of intersection of said Laurel Run Road with the Cramer Pike; thence along the Westerly side of said road in a Northerly direction 650 feet.

(2) Beginning at a point along said road 2970 feet North and East of the said point of intersection of Laurel Run Road and the

Cramer Pike; thence along the Southerly side of said road in a Northeasterly direction 340 feet.

(3) Beginning at a point along said road 4960 feet North and East of the said point of intersection of said Laurel Run Road with the Cramer Pike; thence along the Southerly side of said road in a Northeasterly direction 137 feet.

(4) Beginning at a point along said road 6060 feet North and East of the aforesaid point of intersection of Laurel Run Road with the Cramer Pike; thence along the Northerly side of Laurel Run Road in a Northeasterly direction 650 feet.

(5) Beginning at a point along said road 7060 feet North and East of the aforesaid point of intersection of Laurel Run Road and the Cramer Pike; thence along both sides of said road in a Northeasterly direction 838 feet.

(6) Beginning at a point along said road 9760 feet North and East from the aforesaid point of intersection of said Laurel Run Road with the Cramer Pike; thence along the Southerly side of said road in a Northeasterly direction 450 feet to a point near Riblett School House.

That the erecting of such guards or barriers requires more expense than it is reasonable the said Township of West Taylor should bear.

That the said petition prays the Court to appoint such persons to view the premises and to take such order on the subject as is required by the Act of the General Assembly in such case made and provided.

Geo. C. Keim
Attorney for Petitioners.

County of Cambria, SS:

I hereby certify that I served the foregoing notice upon the County Commissioners of Cambria County by handing a true and attested copy thereof on August 29, 1916, to Lester Larimer, Chief Clerk of said Commissioners, and informing him of the contents thereof.

Geo. C. Keim
Attorney for Petitioners.

In the Court of Quar. Ses. of
Cambria County.
No. *# 3 Sept.* Sessions, 1916

Petition of the
Supervisors of

WEST TAYLOR TOWNSHIP
for an order of view for
the purpose of determining
the necessity of erecting
guards or Barriers on part of
LAUREL RUN ROAD, etc.

Filed, *11 Sept. 1916.*

F. C. Robb

Clerk.

*Licker
H. J. Jock
Shuman*

GEORGE C. KEIM
ATTORNEY AT LAW
JOHNSTOWN, PENNA.
OTTO BUILDING

Baltimore Office Supply Co., Baltimore, Md.